

**SURVEY OF MALHEUR NATIONAL FOREST
BOUNDARY LINE BETWEEN SECTIONS 22 AND 23,
TOWNSHIP 14 SOUTH, RANGE 30 EAST, W.M.,
GRANT COUNTY, OREGON.**

W.D. 88-628-H

GULCH CADASTRAL SURVEY
CONTRACT NO. 53-04KK-8-02399
MALHEUR NATIONAL FOREST
BEAR VALLEY RANGER DISTRICT

SURVEY BY:
ARMSTRONG SURVEYING
& ENGINEERING, INC.
378 E. SECOND STREET
PRINEVILLE, OR 97754
[503] 447-7791

SURVEY FOR:

U.S.D.A., FOREST SERVICE
MALHEUR NATIONAL FOREST
139 N.E. DAYTON STREET
JOHN DAY, OR 97845
[503] 575-1731

GENERAL SURVEY NOTES

1. FIELD SURVEY NOTES ARE ON FILE IN THE OFFICE OF ARMSTRONG SURVEYING & ENGINEERING, INC., 378 EAST SECOND STREET, PRINEVILLE, OREGON. FIELD BOOKS 8 AND 9.
2. BASIS OF BEARINGS. BEARINGS ARE BASED ON SOLAR OBSERVATION BY THE ALTITUDE METHOD TAKEN NEAR THE SECTION CORNER [N-17], CORNER COMMON TO SECTIONS 14, 15, 22, AND 23.
3. SURVEY INFORMATION. SEE ACCOMPANYING CERTIFIED RECORDS OF LAND CORNER MONUMENTATION, 3 SHEETS, AND ATTACHED SURVEY NARRATIVE, 3 SHEETS, FOR ADDITIONAL INFORMATION ON PROCEDURES AND/OR CONDITIONS ENCOUNTERED DURING THIS SURVEY.
4. GENERAL LAND OFFICE RECORD FOR TOWNSHIP SUBDIVISIONAL LINES OF TOWNSHIP 14 SOUTH, RANGE 30 EAST, W.M., BY SAMUEL W. LACKLAND, DEPUTY SURVEYOR, UNDER G.L.O. CONTRACT NO. 357, DATED JULY 2, 1880, AND PERFORMED THAT YEAR.

LEGEND:

- SET 2 1/2" O.D. X 30" LONG ALUMINUM PIPE WITH 2 1/2" ALUMINUM CAP MARKED AS PER CORNER DIAGRAM.
- FOUND 2 1/2" BRASS CAP ON 2" D.D. GALVANIZED IRON PIPE, ROBERT D. BAGETT, OPLS 598, MARKED AS PER CORNER DIAGRAM.
- FOUND ORIGINAL G.L.O. LINE TREE WITH 2 HACKS ON BOTH NORTH AND SOUTH FACES.
- INDICATES MALHEUR NATIONAL FOREST BOUNDARY LINE POSTED UNDER THIS CONTRACT WITH 6 FT. LONG STEEL FENCE POSTS WITH NATIONAL FOREST PROPERTY BOUNDARY SIGNS [54-2] ATTACHED.
- [] RECORD SURVEY INFORMATION BY SAMUEL W. LACKLAND, 1880.
- (P-17) CORNER MONUMENT NUMBER.
- (E) CORNER METHOD OF RE-ESTABLISHMENT OR REMONUMENTATION FOR CORNERS ORIGINALLY ESTABLISHED BY THE G.L.O.
E ~ ORIGINAL EVIDENCE.
S ~ OTHER REGISTERED LAND SURVEYOR.

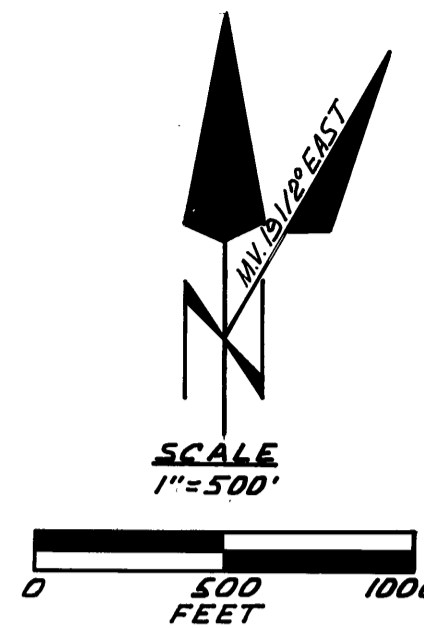

SURVEYORS CERTIFICATE

I, DAVID B. ARMSTRONG, A REGISTERED PROFESSIONAL LAND SURVEYOR IN THE STATE OF OREGON, DO HEREBY CERTIFY THAT THIS PLAT AND NOTES HEREON OR ATTACHED ARE A CORRECT REPRESENTATION OF A SURVEY I PERFORMED DURING OCTOBER~NOVEMBER, 1989, AT THE REQUEST OF THE U.S.D.A., FOREST SERVICE, IN ACCORDANCE WITH THE STATUTES OF THE STATE OF OREGON AND THE ARTICLES OF MY CONTRACT.

FOREST SERVICE CERTIFICATES

EXAMINED AND ACCEPTED FOR THE U.S. FOREST SERVICE.
[Signature] DATE 1/23/90
C.O.R.

I CERTIFY THAT THIS SURVEY WAS PERFORMED AT THE REQUEST OF THE MALHEUR NATIONAL FOREST SUPERVISOR.
[Signature] DATE 1/23/90
FOREST SUPERVISOR

ABBREVIATIONS:

- BT ~ BEARING TREE
- P.PINE ~ PONDEROSA PINE
- D. FIR ~ DOUGLAS FIR
- FT. ~ FOOT OR FEET
- O.D. ~ OUTSIDE DIAMETER
- V.S. ~ VISIBLE SCRIBING
- DRIG ~ ORIGINAL
- DECL. ~ DECLINATION
- F.B. ~ FIELD BOOK
- P. ~ PAGE

REGISTERED
PROFESSIONAL
LAND SURVEYOR

David B. Armstrong
12/22/89 OREGON
AUGUST 22, 1975
DAVID B. ARMSTRONG
1026

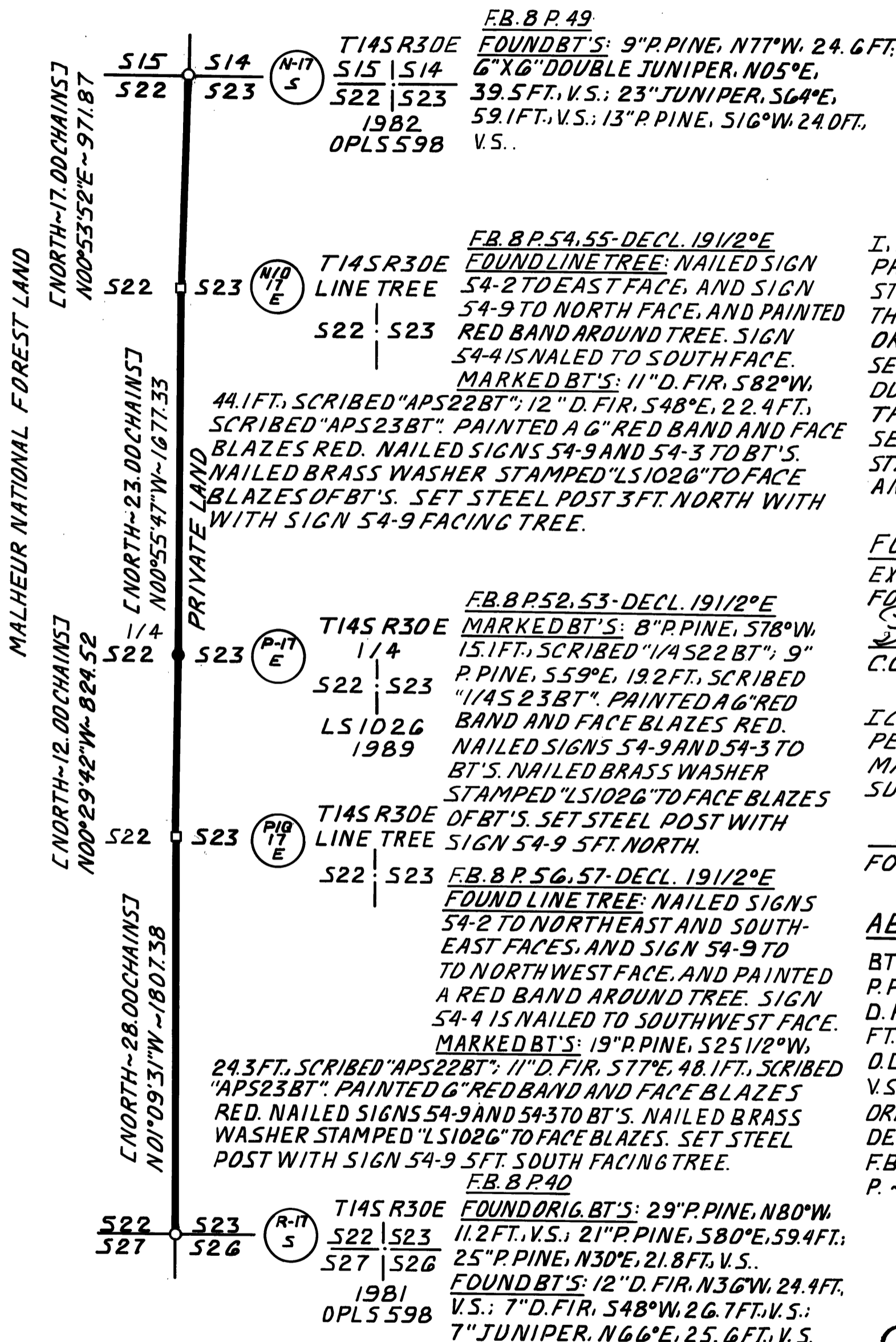

RECORDATION

RECEIVED AND
FILED

FEB 13 1990

OFFICE OF COUNTY CLERK

C.S. 1125

FIELD BOOKS 8 & 9
W.D. 88-628-H

COUNTY SURVEY NO. 1125