

NARRATIVE TO ACCOMPANY PLAT

The purpose of this survey is to mark boundary lines between National Forest Land and privately owned land in and adjoining Section 11, T 10 S, R 31 E, W.M. This survey was performed at the request of U.S.D.A. Forest Service, Malheur National Forest under Contract No. 53-04H1-7-4011, Sun Cadastral Survey.

HISTORY - The original subdivision of T 10 S, R 31 E was performed by Moore and Thompson in 1881 under Contract No 382. The North and East lines of Section 11 were surveyed in 1988 by Parsons Surveying as a separate part of this contract.

SURVEY - Basis of bearings is a solar observation taken at the northeast corner of Section 1. A closed random traverse was run around the exterior of the section as required for subdivision and posting, tying to the existing corners shown. A closed loop random traverse was then run through the interior of the section, generally along the property boundary lines, for posting and internal monumentation purposes. Survey and subdivision of the section was conducted according to the original government notes and plat, and in accordance with the principles outlined in the Manual of Surveying Instructions, 1973.

Monuments for new corners were set radially from points on the previously established control traverses. True property boundary lines were determined by measuring offsets from the control traverse lines.

Fencelines run along the general alignment of many of the boundary lines posted in this survey. A trespass was noted in the vicinity of the CE1/16th corner as shown on the plat.

Notes for this survey are contained in Field Books 4, 5, 6, and 7 Sun Cadastral Survey. Field notes and calculation sheets of this survey are on file in this office, and with the Survey Officer, Malheur National Forest.

GENERAL NOTES - Equipment used in this survey included a TOPCON GTS-2, Berger 30" transit, and a 100 foot steel chain. Traverses consist of closed loops which were adjusted by balancing angles and applying the Compass Rule method of adjustment. Bearings of lines shown on the plat were derived by plane survey techniques, and have not been adjusted to compensate for convergence of meridians. Aluminum monuments set in this survey consist of an aluminum cap with magnet, riveted to a 2-1/2" aluminum pipe 30" long with a flared base. Directions to bearing trees are based on the solar observation used to establish directions of lines in this survey. All bearing trees marked in this survey have a 3/4" brass washer marked "PLS 1918" attached to the BT blaze. Measurements to all bearing trees in this survey were made to the center of the tree, except where specifically noted that the measurement was made to the face. Bearing trees have blazes and bands painted red and appropriate Forest Service signs attached. In the Corner Notes, Ponderosa Pine is abbreviated P. Pine and Lodgepole Pine is abbreviated L. Pine. Unless otherwise noted, pine refers to Ponderosa or Yellow Pine. Record bearing tree information is denoted by (). All corners set during this survey have a 6 foot steel guard post driven approximately 3 to 5 feet away with appropriate Forest Service signs attached. Boundary lines are marked with steel fence posts with Property Boundary signs.

E-17
Found a 2-1/2" aluminum monument in a mound of stone.
A 33" P.Pine bears N38-1/2°E 55.6 ft to face (N 35° E 84 lks), healed scar.
The roothole of a 32" windfall P.Pine bears N 13° W 79.7 ft to estimated
face position (N12°W 121 lks), face down, scribed S3.
A 39" P.Pine snag, not of record, bears S6-1/4°W 192.5 ft, fragmentary
scribing visible in an opened face. This BT is no longer visible from the
corner.
A 10" P.Pine bears N45-1/4°W 18.1 ft, scribed T10SR31ES3BT.
A 9" P.Pine bears N41-1/2°E 31.7 ft, scribed T10SR31ES2BT.

T10S R31E
S31S2

S101S11
PLS1918
1988

E-18
Found a 2-1/2" aluminum monument in a mound of stone.
A 9" P.Pine bears N53°W 20.1 ft, scribed W1/16S2BT.
A 10" P.Pine bears S5°E, 17.8 ft, scribed W1/16S11BT.

T10S R31E
S2
W1/16---
S11
PLS1918
1988

E-19
Found a 2-1/2" aluminum monument in a mound of stone.
A 1-1/2" aluminum cap on 5/8" rebar bears N22°40'E 12.04 ft, marked RM 1/4S2
12.04FT PLS1918.
A 1-1/2" aluminum cap on 5/8" rebar bears S46°43'E 23.12 ft, marked RM 1/4S11
23.12FT PLS1918.

T10S R31E
S2
1/4---
S11
PLS1918
1988

E-20
Found a 2-1/2" aluminum monument in a mound of stone.
A 15" P.Pine bears S49-1/2°E 121.0 ft, scribed E1/16S11BT.

T10S R31E
S2
E1/16---
S11
PLS1918
1988

E-21
Found a 2-1/2" aluminum monument in a mound of stone.
The rotted stump of a pine bears N50-1/4°E 143.2 ft (N50°E 218 lks).
A 48" P.Pine bears N48-1/2°W 95.4 ft to face (N48°W 145 lks), burned face.
A 46" P.Pine bears S53°W 137.4 ft to face (S53°W 207 lks), scribing
visible in an opened face.
A 31" P.Pine bears S6-1/4°E 151.1 ft to face (S7°E 228 lks), healed scar.
A 6" P.Pine bears N32°E, 21.6 ft, scribed T10SR31ES1BT.
A 12" P.Pine bears N48°W 55.5 ft, scribed T10SR31ES2BT.
A 13" P.Pine bears S30°W 66.5 ft, scribed T10SR31ES11BT.
A 12" P.Pine bears S20-1/4°E 94.6 ft, scribed T10SR31ES12BT.

T10S R31E
S21S1

S111S12
PLS1918
1988

F-19
Set a 2-1/2"x30" aluminum monument 6" in the ground in a mound of stone.
I establish new bearing trees:
A 10" P.Pine bears N9°22'E 206.1 ft, scribed CN1/16S11BT.
A 7" P.Pine bears S7°31'E 104.9 ft, scribed CN1/16S11BT.

T10S R31E
C
N1/16S11
C
PLS1918
1989

F-21
Found a 2-1/2" aluminum monument in a mound of stone.
An 8" Juniper bears S28-1/4°E 143.7 ft, scribed N1/16S12BT.
An 8" Juniper bears S17-3/4°W 214.9 ft, scribed N1/16S11BT.

T10S R31E
N1/16
S111S12
PLS1918
1988

G-17
Found no evidence of the original pine post. At record distance and direction
from the one remaining bearing tree, I found a mound of stone. I reestablish
this corner at record distance and direction from the original bearing tree.
Set a 2-1/2"x30" aluminum monument 20" in the ground in a mound of stone.
A 20" P.Pine bears S75°E 20 lks (record) to face, fragmentary scribing visible
in lower blaze.
I establish new bearing trees:
A 10" P.Pine bears N56°51'E 19.8 ft, scribed 1/4S11BT.
A 9" Juniper bears N24°02'W 15.9 ft, scribed 1/4S10BT.

T10S R31E
1/4
S101S11
PLS1918
1989

G-19
Set a 2-1/2"x30" aluminum monument 20" in the ground in a mound of stone.
I establish new bearing trees:
A 6" P.Pine bears S44°40'E 7.3 ft, scribed C1/4S11BT.
A 9" P.Pine bears S38°36'W 8.8 ft, scribed C1/4S11BT.

T10S R31E
C1/4
+
S11
PLS1918
1989

G-20
Set a 2-1/2"x30" aluminum monument 20" in the ground in a mound of stone.
I establish new bearing trees:
A 9" Juniper bears S49°26'E 261.1 ft, scribed CE1/16S11BT.
A 1-1/2" aluminum cap on rebar bears S39°17'W 12.77 ft, marked
RP CE1/16S11 12.77FT PLS1918.

T10SR31E
E1/16
C-----C
S11
PLS1918
1989

G-21
Found a 2-1/2" aluminum monument in a mound of stone.
A 5" Juniper bears S13-1/2°E 32.2 ft, scribed 1/4S12BT.
A 13" Juniper bears N49-1/2°W 49.1 ft, scribed 1/4S11BT.

T10S R31E
1/4
S111S12
PLS1918
1988

H-20
Set a 2-1/2"x30" aluminum monument 10" in the ground in a mound of stone.
I establish new bearing trees:
A 7" Juniper bears S42°44'E 84.3ft, scribed SE1/16S11BT.
A 7" Juniper bears S87°46'W 24.8ft, scribed SE1/16S11BT.

T10S R31E
SE1/16
+
S11
PLS1918
1989

H-21
Found a 2-1/2" aluminum monument in a mound of stone.
A 5" Juniper bears N41-1/2°E 66.1 ft, scribed S1/16S12BT.
A 8" Juniper bears S81-1/4°W 51.0 ft, scribed S1/16S11BT.

T10S R31E
S1/16
S111S12
PLS1918
1988

J-19
Found no evidence of the original pine post. I reestablished this corner at
record distance from the original bearing trees. Set a 2-1/2"x30" aluminum
monument 20" in the ground in a mound of stone.
A Pine stump, deteriorated, bears N20°48'W 14.5 ft (N24°W 22 lks) to estimated
face, detached piece with scar.
A 26" P.Pine bears S58°26'W 17.8 ft (S58°W 27 lks) to estimated face, with a
healed blaze.
I establish a new bearing tree:
A 10" P.Pine bears N23°E 53.3 ft, scribed 1/4S11BT.

T10SR31E
S11
1/4---
S14
PLS1918
1989

J-21
Found a 2-1/2" aluminum monument in a mound of stone.
A 48" P.Pine bears S11-1/2°W 130.6 ft to center (S12°W, 208 lks), burned face.
An 11" Juniper bears N79-3/4°E 34.3 ft, scribed T10SR31ES12BT.
A 13" Juniper bears S15-1/4°E 52.4 ft, scribed T10SR31ES13BT.
An 11" Juniper bears S22-1/2°W 53.8 ft, scribed T10SR31ES14BT.
A 13" double Juniper bears N74-1/2°W 42.7 ft, scribed T10SR31ES11BT.

T10S R31E
S111S12

S141S13
PLS1918
1988

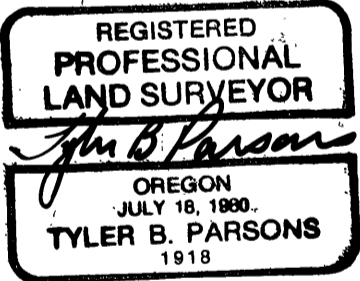

RECORD OF SURVEY
for the
U.S. FOREST SERVICE

Malheur National Forest
Sec 11, T10S, R31E, W.M.
Grant County, OR
Sun Cadastral Survey
Cont. No. 53-04H1-7-4011
April 13, 1989

PARSONS SURVEYING
1915 S.E. Stone Street
Corvallis, OR 97333
(503) 752-7515
Job No. 8722K

RECEIVED AND
FILED

JUN 26 1989

OFFICE OF COUNTY SURVEYOR

Ames

SHEET 2 OF 2