

CERTIFIED RECORD OF LAND CORNER MONUMENTATION

History of original corner establishment:

Corner originally established by Alonzo Gesner, U.S. Deputy Surveyor, under GLO Contract No. 266 dated July 20, 1877. Surveyor General records state:

Set stone 12 x 12 x 8 ins. for 1/4 Section corner.
Raised a stone mound at corner.

V-15

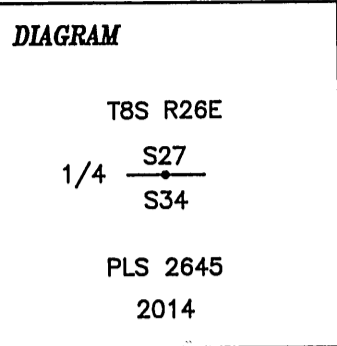

Description of corner evidence found:

No original evidence found. Monument set by single proportion. See Record Map of Survey No. 2026

Description of monument and accessories I established to perpetuate the original location of this corner:

Set a 3" x 30" aluminum pipe with a 3 1/4" aluminum cap marked as shown in 3' diameter mound of stone. A magnet in a clear plastic case was deposited at the base of pipe.

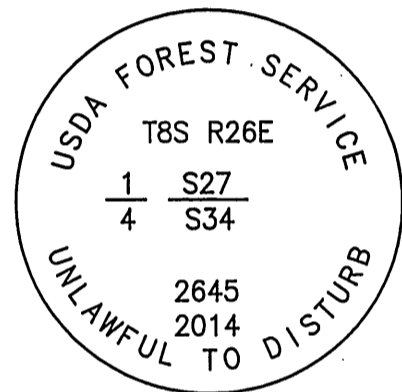

New accessories:

- A 8" Juniper scribed "1/4 S34 BT" with 1" aluminum tag marked "2645" bears S9°E, 12.6'.
- A 11" Juniper scribed "1/4 S34 BT" with 1" aluminum tag marked "2645" bears S79°W, 30.3'.
- A 11" Juniper scribed "1/4 S27 BT" with 1" aluminum tag marked "2645" bears N62°E, 20.5'.
- A 1/2" x 24" rebar with 1 1/2" aluminum cap marked "RM1" bears N32°W, 19.7'.

Geodetic Coordinates (NAD83):

N 44°50'17.0"
W 119°36'09.4"

Geodetic coordinates were obtained from a Garmin recreational grade GPS receiver and were averaged.

Date: August 13, 2014

Declination: 17° E

Witnesses: Paul Guglielmelli and Toribio Quinones

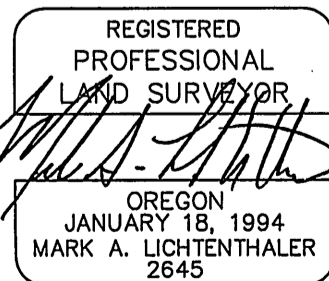

EXPIRES 12-31-2018