

CERTIFIED RECORD OF LAND CORNER MONUMENTATION

History of original corner establishment:

Corner originally established by Alonzo Gesner, U.S. Deputy Surveyor, under GLO Contract No. 266 dated July 20, 1877. Surveyor General records state:

Set stone 14 x 12 x 9 ins. for corner to Sections 27, 28, 33, & 34.
Raised stone mound at corner.
From which a yellow pine 10 in. in dia. bears S51°E, 281 lks. dist.

V-13

DIAGRAM

T8S R26E
S28|S27
S33|S34

PLS 2645
2014

Description of corner evidence found:

No original evidence for the stone, mound of stone or bearing tree was found.
Corner was reset using the line tree as the best available evidence of the corner location.
See Record Map of Survey No. 2026

Description of monument and accessories I established to perpetuate the original location of this corner:

Set a 3" x 30" aluminum pipe with a 3 1/4" aluminum cap marked as shown in a collar of stone. A magnet in a clear plastic case was deposited at the base of pipe. Cap is 2 1/2" above the collar of stone.

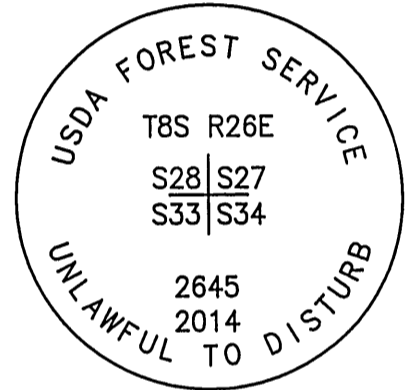

New accessories:

- A 16" Ponderosa Pine scribed "T8S R26E S27 BT" with aluminum tag marked "2645" bears N15°E, 52.8'.
- A 25" Ponderosa Pine scribed "T8S R26E S28 BT" with aluminum tag marked "2645" bears N71°W, 64.2'.
- A 28" Ponderosa Pine scribed "T8S R26E S34 BT" with aluminum tag marked "2645" bears S39°E, 101.5'.
- A 1/2" x 24" rebar with 1 1/4" aluminum cap stamped "RM1" bears S37°W, 17.6'.

Geodetic Coordinates (NAD83):

N 44°50'16.5"
W 119°36'45.5"

Geodetic coordinates were obtained from a Garmin recreational grade GPS receiver and were averaged.

Date: September 17, 2014

Declination: 17' E

Witnesses: Paul Guglielmelli and Toribio Quinones

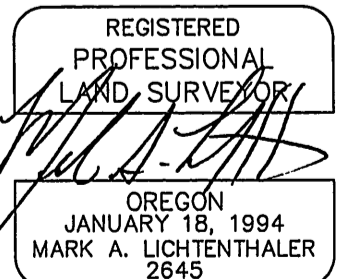

EXPIRES 12-31-2018