

CERTIFIED RECORD OF LAND CORNER MONUMENTATION

History of original corner establishment:

None previously established.
See Record Map of Survey No. 2026

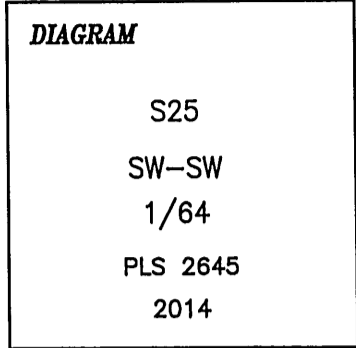

Description of corner evidence found:

Not Applicable

Description of monument and accessories I established to perpetuate the original location of this corner:

Set a 3" x 30" aluminum pipe with a 3 1/4" aluminum cap marked as shown in a 1' collar of stone. A magnet in a clear plastic case was deposited at the base of pipe. Cap is 2 1/2" above the collar of stone.

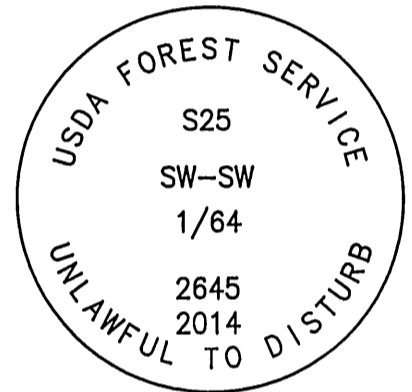

New accessories:

A 4" Juniper scribed "X BT" with a aluminum tag marked "2645" bears S68°E, 12.68'.
A 8" Juniper scribed "SW SW 1/64 BT" with a aluminum tag marked "2645" bears S76°W, 36.47'.

Geodetic Coordinates (NAD83):

N 44°50'23.3"
W 119°34'12.7"

Geodetic coordinates were obtained from a Garmin recreational grade GPS receiver.

Date: July 16, 2014

Declination: 15° E

Witnesses: Carl Stout, Robert Flora, Paul Guglielmelli and Lucas Beauchamp

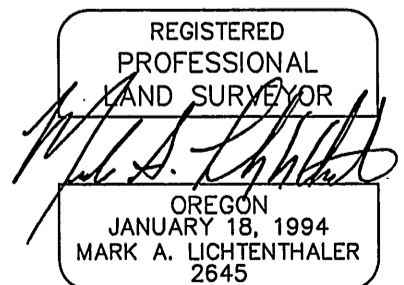

EXPIRES 12-31-2018