

CERTIFIED RECORD OF LAND CORNER MONUMENTATION

History of original corner establishment:

None previously established.
See Record Map of Survey No. 2026

U-5

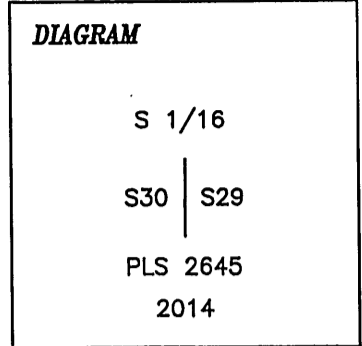

Description of corner evidence found:

Description of monument and accessories I established to perpetuate the original location of this corner:

Set a 3" x 30" aluminum pipe with a 3 1/4" aluminum cap marked as shown. A magnet in a clear plastic case was deposited at the base of pipe. Cap is set level flush with ground.

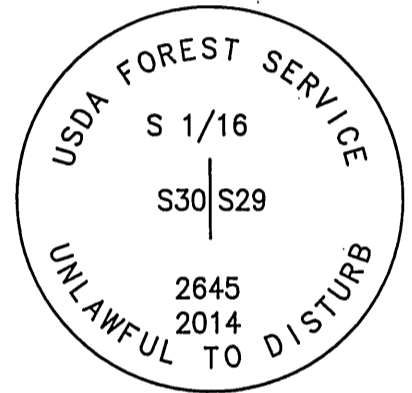

New accessories:

A 13" Ponderosa Pine scribed "S 1/16 S30 BT" with 1" aluminum tag marked "2645" bears N71°W, 30.4'.
A 10" Juniper scribed "S 1/16 S29 BT" with 1" aluminum tag marked "2645" bears N25°E, 41.0'.

Geodetic Coordinates (NAD83):

N 44°50'29.2"
W 119°39'05.9"

Geodetic coordinates were obtained from a Garmin recreational grade GPS receiver and were averaged.

Date: August 18, 2014

Declination: 17° E

Witnesses: Paul Guglielmelli, Daniel Lee and Toribio Quinones

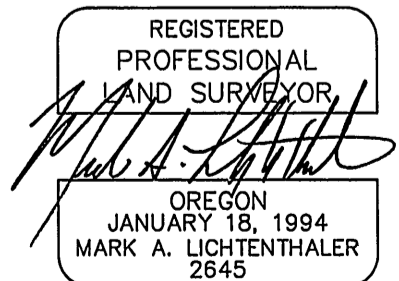

EXPIRES 12-31-2018