

CERTIFIED RECORD OF LAND CORNER MONUMENTATION

History of original corner establishment:

Corner originally established by Alonzo Gesner, U.S. Deputy Surveyor, under GLO Contract No. 266 dated July 20, 1877. Surveyor General records state:

Set stone 16 x 14 x 12 ins. for 1/4 Section corner. Raised stone mound at corner.

N-9

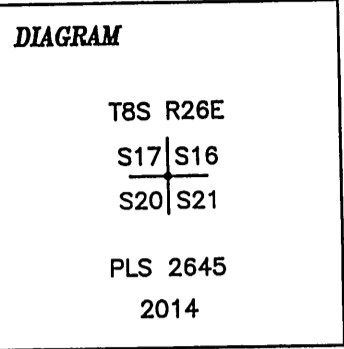

Description of corner evidence found:

Found a 15 X 14" x 10" stone firmly set in a mound of stone. A Forest Service location poster marked "SEC COR 16, 17, 20, & 21 SD" was located on a Ponderosa Pine NW 13'.

Description of monument and accessories I established to perpetuate the original location of this corner:

See Record Map of Survey No. 2026

Set a 3" x 30" aluminum pipe with a 3 1/4" aluminum cap marked as shown in a mound of stone. A magnet in a clear plastic case was deposited at the base of pipe. Cap is 1" above the mound of stone. Original stone was buried against east side of pipe.

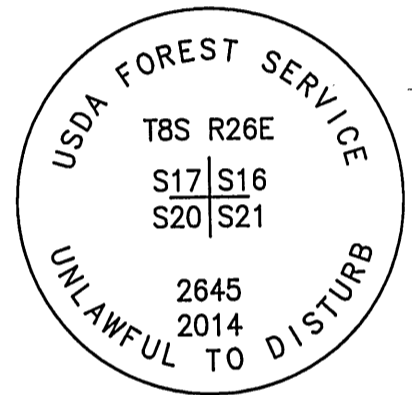

New accessories:

- A 8" Fir scribed "T8S R26E S20 BT" with 1" aluminum tag marked "2645" bears S78°W, 35.6'.
- A 6" Juniper scribed "T8S R26E S17 BT" with 1" aluminum tag marked "2645" bears N38°W, 47.2'.
- A 16" Ponderosa Pine scribed "T8S R26E S16 BT" with 1" alum. tag marked "2645" bears N46°E, 37.8'.
- A 9" Fir scribed "T8S R26E S21 BT" with 1" aluminum tag marked "2645" bears S55°E, 27.0'.

Geodetic Coordinates (NAD83):

N 44°52'01.2"

W 119°37'56.9"

Geodetic coordinates were obtained from a Garmin recreational grade GPS receiver and were averaged.

Date: August 20, 2014

Declination: 17° E

Witnesses: Robert Flora, Daniel Lee, Paul Guglielmelli and Toribio Quinones

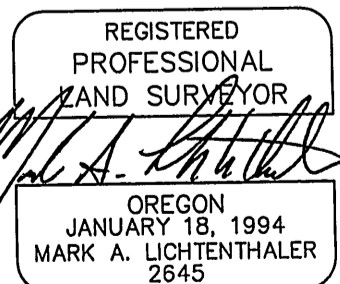

EXPIRES 12-31-2018