

LAND PARTITION PLAT NO. 2023-13

SITUATED IN GOVERNMENT LOT 4, SECTION 1, T.14S., R.31E., W.M.,
CITY OF CANYON CITY, GRANT COUNTY, OREGON



BASIS OF BEARINGS
RECORD MAP OF SURVEY NO. 1247
AS SHOWN



LEGEND

- FOUND 3" BRASS CAP SET IN CONCRETE, 6" BELOW GROUND IN A 8" CAST IRON MONUMENT CASE FROM SURVEY NO. 1247
- FOUND 5/8" IRON PIN NO CAP FROM SURVEY NO. 1247
- SET 5/8"X30" IRON PIN WITH ATTACHED YELLOW PLASTIC CAP MARKED BENCHMARK SURVEYING
- () DEED RECORD BEARING AND DISTANCE
- [] RECORD BEARING AND DISTANCE: SURVEY NO. 1247
- X-X WIRE FENCE LINE
- WOODEN FENCE LINE

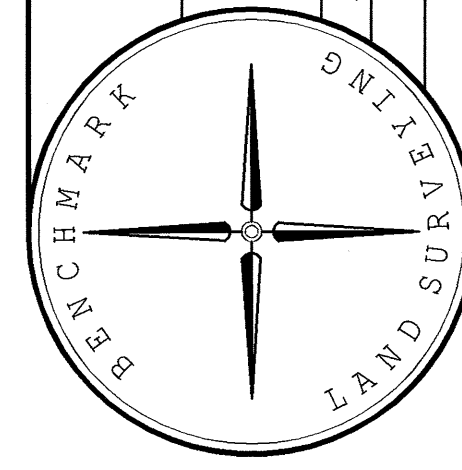

REGISTERED
**PROFESSIONAL
LAND SURVEYOR**
Michael C. Spranger
OREGON
JULY 9, 2002
MICHAEL C. SPRANGER
#70918
EXPIRES: 6/30/2024

I DO HEREBY CERTIFY THAT THIS IS A TRUE AND EXACT
COPY OF THE ORIGINAL PLAT.

BENCHMARK LAND SURVEYING

BENCHMARK LAND SURVEYING
217 N. CANYON BLVD. JOHN DAY, OREGON
541-575-1251 ~ benchmarkls.com

LAND PARTITION PLAT
SITUATED IN GOVERNMENT LOT 4, SECTION 1,
T.14S., R.31E., W.M.,
CITY OF CANYON CITY, GRANT COUNTY, OREGON

SURVEYED FOR
MARCUS TEAGUE

SURVEYED BY
MCS & DDD

7/22/2023

DRAWN BY: MCS

SHEET 1 OF 2

SCALE: 1"=20'