

I, BRENDA J. PERCY, COUNTY CLERK FOR GRANT COUNTY, OR CERTIFY THAT THE INSTRUMENT IDENTIFIED HEREIN WAS RECORDED IN THE COUNTY CLERK'S RECORDS.  
BRENDA J PERCY, GRANT COUNTY CLERK  
DOC#: 20181120  
PG: 1 \$43.50  
5/21/2018 10:32 AM

*Brenda J. Percy*

**Affidavit of Correction**  
To Land Partition Plat No. 2018-04

I Michael C. Springer, first being duly sworn, depose and say that I am the Surveyor who prepared, filed and recorded Land Partition Plat No. 2018-04, filed in the office of the Grant County Clerk. As provided under ORS 92.170 the following corrections to said plat are necessary:

SHEET 2:

Surveyor's Certificate:

1. In the last course and distance, strike through the words "TO THE POINT OF BEGINNING".
2. Under the current last course and distance of "S.28°15'41"E., 1000.04 FEET"; add the omitted course and distance of "N.76°01'45"E., 316.22 FEET TO THE POINT OF BEGINNING."

The present fee owners of the subject property are not materially affected by this correction.

State of Oregon     )  
                                  ) SS  
County of Grant    )

*[Signature]*  
\_\_\_\_\_  
Michael C. Springer, PLS

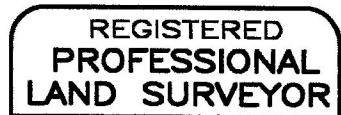

*[Signature]*



EXPIRES: 6/30/2018

Signed and sworn before me on May 21, 2018.

*[Signature]*  
\_\_\_\_\_  
Notary Public for the State of Oregon  
My Commission Expires 3/2/2019



**County Surveyor Approval**

Approved this 21 day of May, 2018, pursuant to ORS 92.170.

*[Signature]*  
\_\_\_\_\_  
Grant County Surveyor