

LAND PARTITION PLAT NO. 2001-1

SITUATED IN SECTION 19; SW1/4 OF SECTION 20;
N1/2SW1/4 AND S1/2NW1/4 SECTION 29; SECTION 30;
NE1/4 AND NW1/4 SECTION 31, T10S, R28E, W.M.
GRANT COUNTY, OREGON

November 3, 2000

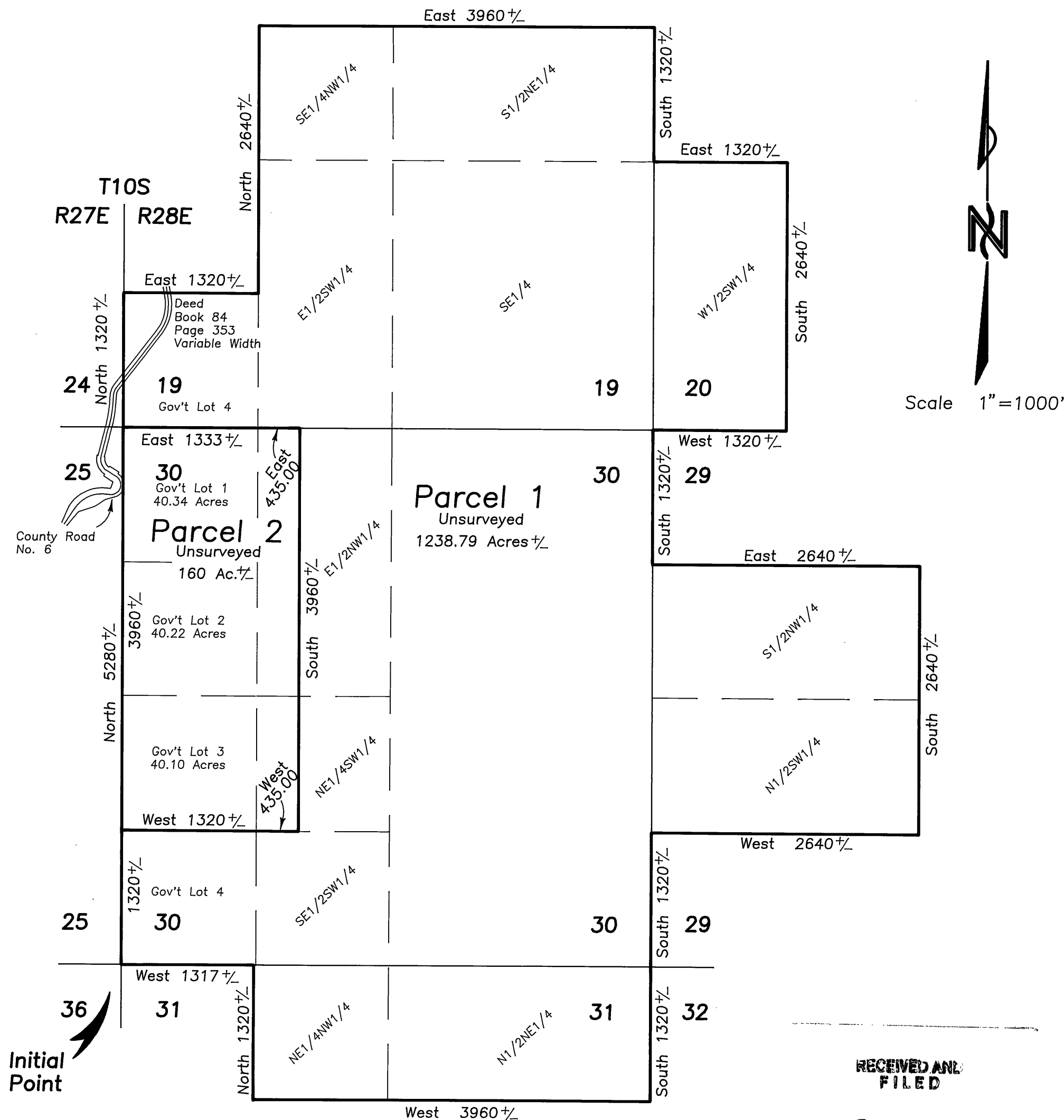

Legal Description of Parcel 2

T10S, R28E, W.M. Grant County, Oregon
Section 30: Gov't Lots 1, 2 and 3 together with the
westerly 435.00 feet of the E1/2NW1/4 and the
westerly 435.00 feet of the NE1/4SW1/4.

NOTES:

- 1) The area for this partition was taken from the assessor's records and may vary when the lines of these parcels are determined by survey.
- 2) The section lines and subdivision of section lines are protracted and shown for informational purposes only
- 3) The bearings and distances are approximate.

SURVEYOR'S CERTIFICATE

I, Jack L. Watson, Professional Land Surveyor, registered in the State of Oregon, hereby certify that I have correctly mapped the land shown on this partition and that these parcels were not surveyed during this partition process. This partition is situated in Section 19, and in the SW1/4 of Section 20, and in the SW1/4 and NW1/4 of Section 29, and in Section 30, and in the NE1/4 and NW1/4 of Section 31, T10S, R28E, W.M., Grant County, Oregon, described as follows:

T10S, R28E, W.M., Grant County, Oregon:
Section 19: S1/2NE1/4; SE1/4; E1/2SW1/4; SE1/4NW1/4; Gov't Lot 4.
Section 20: W1/2SW1/4.
Section 29: N1/2SW1/4; S1/2NW1/4.
Section 30: All
Section 31: N1/2NE1/4; NE1/4NW1/4.

I designate the SW corner of Section 30, T10S, R28E, W.M., to be the Initial Point of this land partition.

This partition contains 1398.79 acres, more or less.

Cornerstone Surveying, Inc.
233 S. Canyon Blvd.
John Day, OR 97845
575-1813

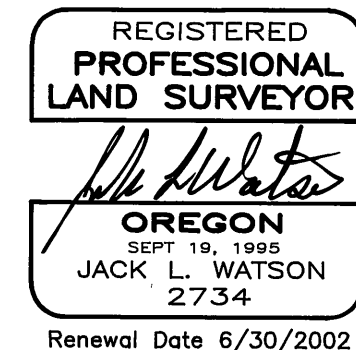

DECLARATION

Know all people by these presents that, Robert H. Kilby, does hereby declare I am the owner of the lands described in the Surveyor's Certificate, and that I have caused the same to be partitioned into parcels in accordance with the provisions of ORS Chapter 92 as shown hereon.

SAID PARCELS ARE SUBJECT TO THE FOLLOWING:

- 1) Rights of the public in streets, roads and highways.

Robert H. Kilby
Robert H. Kilby

ACKNOWLEDGEMENT

STATE OF OREGON } SS
COUNTY OF GRANT }

This instrument was acknowledged before me on this 17th day of November, 2000, by Robert H. Kilby.

Jim Stubblefield
Notary Public of Oregon
My commission expires: 8/5/03

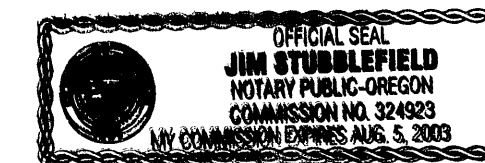

APPROVALS

Approved this 16th day of Nov., 2000

Robert D. Bantz
Grant County Surveyor

Roland Roth and Bonnie Lu Roth, husband and wife, have consented to the declaration of this Partition by an Affidavit of Consent recorded as Instrument No. 210311, deeds of Grant County.

Approved this 7 day of February, 2001
Debra M. Kowalski
Grant County Planning Director

I do hereby certify that this plat was received on the 7th day of February, 2000 at 3:27 o'clock P.M., and recorded as Land Partition Plat No. 2001-1 Grant County Records.

Kelly McLean
Grant County Clerk

All ad valorem and special assessments due pursuant to law have been assessed and collected.

Paul R. Sutton
Grant County Assessor and Tax Collector
Date 02-07-2001

I do hereby certify that this is a true and exact copy of Land Partition No. 2001-1
Jack L. Watson
Jack L. Watson