

BASIS OF BEARINGS
SOLAR OBSERVATION
TAKEN 660 FEET EAST OF THE
NW CORNER OF SECTION 7

LEGEND

- Found brass cap monument as shown
- Found monument as shown
- Set 5/8" x 30" iron pin with attached yellow plastic cap marked B-G-A SURVEY MARKER.

REFERENCES

Surveyor Record Book 1 Page 107A
Record Map of Survey No. 521
Oregon State Highway Drawing No. 5B-30-20
Deed Record Book 57 Page 209-211

| | |
|-----|---------|
| 75 | 455 |
| 88 | 109 |
| 103 | 274-279 |
| 103 | 579 |
| 114 | 211-213 |
| 117 | 179-181 |
| 119 | 690 |
| 122 | 630-632 |
| 122 | 918-919 |
| 125 | 622-623 |
| 125 | 645-647 |
| 125 | 704 |
| 127 | 933-934 |
| 128 | 912-913 |
| 38 | 91 |
| 46 | 443 |

VICINITY MAP
T13S R34E

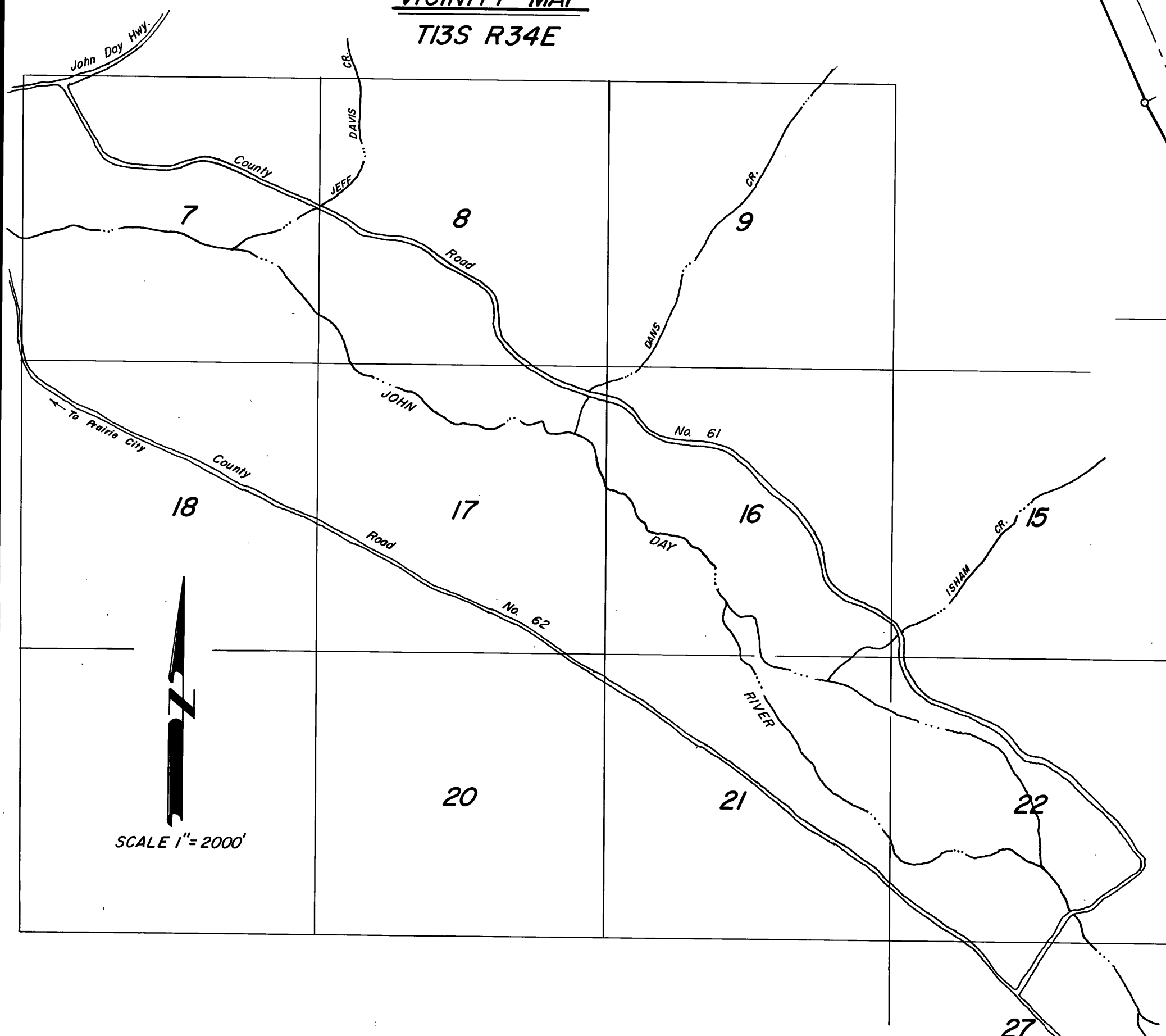

NARRATIVE: This survey was performed at the request of County Judge, Lorene Allen, to establish and mark the right of way lines of County Road No. 61. A search was made of the available records pertaining to this survey. Field measurements were made to locate the existing centerline and the necessary right of way widths for this road. New monuments were set along the proposed right of way as shown. The section lines and section subdivisional lines are protracted from the section and 1/4 section corners found and shown on this map. The lines protracted are for general information only.

RECEIVED AND FILED
JUL 15 1985
OFFICE OF COUNTY SURVEYOR
Robert D. Baggett
Attest: Mary M. Sullivan

REGISTERED
PROFESSIONAL
LAND SURVEYOR
Robert D. Baggett
OREGON
JULY 12, 1983
ROBERT D. BAGGETT
598

SHEET 1 OF 10

BAGETT, GRIFFITH & ASSOCIATES
John Day, Oregon

MAP OF A SURVEY
OF PROPOSED COUNTY ROAD NO. 61
SITUATED IN SECTIONS 7, 8, 15, 16, 17, 22 & 27
T13S, R34E, W.M.
GRANT COUNTY OREGON

| | |
|----------------|---------------------------------------|
| Surveyed For | GRANT COUNTY ROAD DEPARTMENT |
| Surveyed By | R.D.B. & J.L.W. & T.O.S. Feb-June '85 |
| Scale: 1"=100' | Drawn by: J.L.W. June '85 |