

# NARRATIVE

THIS SURVEY WAS CONDUCTED AT THE REQUEST OF ED AKERS, OWNER OF THE LAND DESCRIBED IN DEED INSTRUMENT NO. 211663, DEED RECORDS OF GRANT COUNTY, OREGON. THE PURPOSE OF THIS SURVEY WAS TO MONUMENT THE ADJUSTED PROPERTY LINE DESCRIBED IN DEED INSTRUMENT NO. 20230445, DEED RECORDS.

A SEARCH WAS MADE OF AVAILABLE RECORDS. I UTILIZED RECORD INFORMATION FROM THE 1900 PLAT OF CLEAVER AND COZART'S ADDITION TO PRAIRIE CITY WHICH WAS PREPARED BY ARTHUR PHILBRICK. I ALSO FOUND RECORD MAP OF SURVEY NO'S 113, 308, 491 AND 1419.

WE BEGAN THIS SURVEY BY LOCATING THE APPURTENANT CONTROLLING MONUMENTS FROM THE AFOREMENTIONED SURVEYS. WE SEARCHED FOR, BUT DID NOT FIND THE MONUMENTS FROM SURVEY NO. 113. STREET CENTERLINE MONUMENTS AT THE INTERSECTIONS OF JOHNSON AVENUE NORTH WITH FIRST STREET WEST, JOHNSON AVENUE NORTH WITH FOURTH STREET WEST, COZART AVENUE NORTH WITH FIRST STREET WEST AND AT COZART AVENUE NORTH WITH FOURTH STREET WEST ARE ACCEPTED AND UTILIZE AS CONTROL FOR THIS SURVEY.

WE ALSO FOUND THE MONUMENTS FROM SURVEY NO. 308 AT OR NEAR THE CORNERS OF LOT 9, BLOCK 11. THE NORTHWEST AND SOUTHWEST IRON PINS HAVE BEEN DISTURBED AND ARE NOT ACCEPTED. I HELD THE NORTHEAST CORNER OF LOT 9 AND DROVE A LINE THE CALCULATED RECORD BEARING AND DISTANCE OF N.89°52'32\"/>

NEW MONUMENTS WERE SET ACCORDING TO THE DEED DESCRIPTION AND TO THE EVIDENCE FOUND. GOD BLESS AMERICA.

# LEGEND

- FOUND CENTERLINE MONUMENT BRASS CAP IN CONCRETE FROM SURVEY NO. 491
- FOUND 5/8" IRON PIN - NO CAP FROM SURVEY NO. 308
- SET 5/8"x30" IRON PIN WITH ATTACHED YELLOW PLASTIC CAP MARKED BENCHMARK SURVEYING
- ( ) RECORD BEARING AND DISTANCE CLEAVER & COZART'S ADDITION
- 1[ ] RECORD BEARING AND DISTANCE: SURVEY NO. 113
- 2[ ] RECORD BEARING AND DISTANCE: SURVEY NO. 308
- 3[ ] RECORD BEARING AND DISTANCE: SURVEY NO. 491
- ▨ WAGGONER TO AKERS, DEED INSTRUMENT NO. 20230445 THE NORTH HALF OF LOT 15

# BASIS OF BEARINGS

RECORD MAP OF SURVEY NO. 491  
AS SHOWN

# REFERENCES

CLEAVER AND COZARTS ADDITION TO PRAIRIE CITY  
DEED RECORD INSTRUMENT NO. 211663, 211665 & 20230445  
MAP OF SURVEY NO'S 113, 308, 491 & 1419

RECEIVED AND FILED  
GRANT COUNTY SURVEYOR

MAR 27 2023

BY:

REGISTERED  
PROFESSIONAL  
LAND SURVEYOR

OREGON  
JULY 9, 2002  
MICHAEL C. SPRINGER  
#70918  
EXPIRES: 6/30/2024

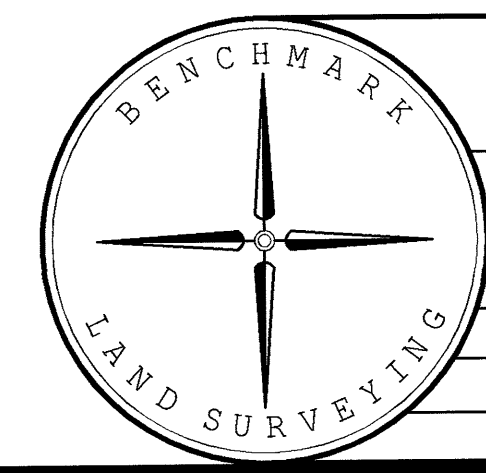

BENCHMARK LAND SURVEYING  
217 N. CANYON BLVD. JOHN DAY, OREGON  
541-575-1251 ~ benchmarkls.com

PROPERTY LINE ADJUSTMENT  
BETWEEN LOTS 15 & 16, BLOCK 11  
CLEAVER & COZART'S ADDITION  
SITUATED IN THE NW1/4SW1/4 SEC. 2, T.13S. R.33E., W.M.,  
PRAIRIE CITY, GRANT COUNTY, OREGON

SURVEYED FOR	AKERS / WAGGONER	
SURVEYED BY	MCS & DDD	3/3/2021
SCALE: 1"=40'	DRAWN BY: MCS	

RECORD MAP OF SURVEY NO. 2204