

SOUTH BRIDGE STREET

(N00°19'47"W)

(N00°19'47"W)

(80.00)

(80.00)

BLOCK 1  
STRAWBERRY

LOT 6

ADDITION

LOT 7

LOT 8

McKERN  
DEED # 20211933

LOT 9

(N89°56'49"E 113.33)

(N89°56'49"E 113.33)

(N89°56'49"E 113.33)

(N00°19'47"W 80.00)  
(N00°19'47"W 80.00)

(N00°19'47"W 80.00)

(N00°19'47"W 160.00)  
(N00°19'47"W 160.00)

(N00°19'47"W 80.00)

JONES  
BK. 136, PG. 84

JONES  
TO  
McKERN  
DEED # 20221950  
14539 SQFT.  
0.33 AC.

[S88°09'07"E 90.07]  
S88°09'07"E 90.07

(S00°19'47"E 163.04)  
(S00°19'47"E 163.04)

S88°09'07"E 286.88  
1[S88°09'07"E 286.88]  
BASIS OF BEARINGS

MAP OF SURVEY NO. 1891

## BASIS OF BEARINGS

RECORD MAP OF SURVEY NO. 1891  
AS SHOWN



## LEGEND

- FOUND 1/2" IRON PIN - NO CAP FROM STRAWBERRY ADDITION
- FOUND 5/8" IRON PIN WITH ATTACHED YELLOW PLASTIC CAP MARKED BENCHMARK SURVEYING FROM SURVEY NO. 1981
- SET 5/8"x30" IRON PIN WITH ATTACHED YELLOW PLASTIC CAP MARKED BENCHMARK SURVEYING
- ( ) RECORD BEARING AND DISTANCE: STRAWBERRY ADDITION
- [ ] DEED RECORD BEARING AND DISTANCE
- 1[ ] RECORD BEARING AND DISTANCE: SURVEY NO. 1891
- X—X FENCE LINE

## NARRATIVE

THIS SURVEY WAS CONDUCTED AT THE REQUEST OF KIMBERLY MCKERN. THE PURPOSE OF THIS SURVEY WAS TO MONUMENT THE PROPERTY LINE ADJUSTMENT TRACT DESCRIBED IN DEED RECORD INSTRUMENT NO. 20221950, DEED RECORDS OF GRANT COUNTY, OREGON.

A SEARCH WAS MADE OF AVAILABLE RECORDS. I FOUND RECORD MAP OF SURVEY NO 1891 AND THE PLAT OF STRAWBERRY ADDITION. IN ADDITION TO OTHER FOUND MONUMENTS SHOWN HEREON, WE FOUND THE IRON PIN AT THE NORTHEAST CORNER OF LOT 8 OF STRAWBERRY ADDITION. THE PIN WAS INACCESSIBLE AND NO SURVEY OBSERVATIONS WERE TAKEN.

THE FOUND PINS SHOWN HEREON ARE ACCEPTED AS CONTROL FOR THIS SURVEY. NEW PINS WERE SET ACCORDING TO THE EVIDENCE FOUND AND ACCORDING TO THE DEED RECORD. GOD BLESS AMERICA.

## REFERENCES

RECORD MAP OF SURVEY NO. 1891  
THE PLAT OF STRAWBERRY ADDITION TO PRAIRIE CITY  
DEED RECORD INSTRUMENT NO.'S 20211923 & 20221950  
DEED RECORD BOOK 136 PAGE 84

RECEIVED AND FILED  
GRANT COUNTY SURVEYOR

OCT 31 2022

BY:

REGISTERED  
PROFESSIONAL  
LAND SURVEYOR

OREGON  
JULY 9, 2002  
MICHAEL C. SPRINGER  
#70918

EXPIRES: 6/30/2024

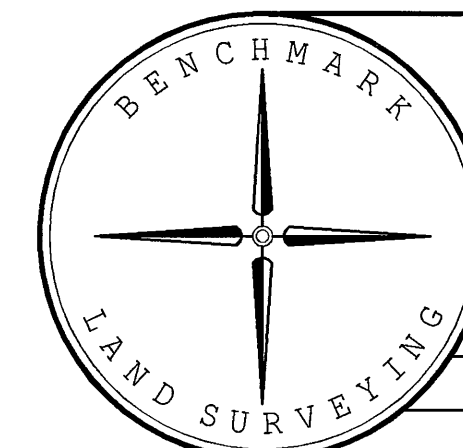

BENCHMARK LAND SURVEYING  
217 N. CANYON BLVD. JOHN DAY, OREGON  
541-575-1251 ~ benchmarkls.com

MAP OF SURVEY  
A PROPERTY LINE ADJUSTMENT  
SITUATED IN THE SE1/4 SECTION 11, T.13S., R.33E., W.M.,  
CITY OF PRAIRIE CITY, GRANT COUNTY, OREGON

SURVEYED FOR	JONES / McKERN
SURVEYED BY	MCS & DDD
SCALE: 1"=30'	DRAWN BY: MCS

10/27/2021

RECORD MAP OF SURVEY NO. 2196