

BASIS OF BEARINGS
LAND PARTITION NO. 2020-03
AS SHOWN HEREON

- LEGEND**
- FOUND 2" GALV. IRON PIPE WITH ATTACHED BRASS CAP SHOWN ON 1955 HALL ACRES SUB'D PLAT
 - FOUND 5/8" IRON PIN WITH ATTACHED YELLOW PLASTIC CAP MARKED BENCHMARK SURVEYING FROM LAND PARTITION NO. 2011-04
 - SET 5/8"x30" IRON PIN WITH ATTACHED YELLOW PLASTIC CAP MARKED BENCHMARK SURVEYING
 - () DEED RECORD BEARING AND DISTANCE
 - 1[] RECORD BEARING AND DISTANCE FROM LAND PARTITION PLAT NO. 2011-04
 - 2[] RECORD BEARING AND DISTANCE FROM LAND PARTITION PLAT NO. 2011-09

BOUNDARY REFERENCES

RECORD LAND PARTITION PLAT NO.S 2011-04 & 2020-03
DEED RECORD INSTRUMENT NO.'S 202160823 & 20221273

RECEIVED AND FILED
GRANT COUNTY SURVEYOR
JUL 19 2022
BY: *[Signature]*

REGISTERED
PROFESSIONAL
LAND SURVEYOR
[Signature]
OREGON
JULY 9, 2002
MICHAEL C. SPRINGER
#70918
EXPIRES: 6/30/2024

NARRATIVE

THIS SURVEY WAS PREPARED AT THE REQUEST OF KING WILLIAMS ON BEHALF OF IRON TRIANGLE LLC AND COMMUNITY COUNSELING SOLUTIONS. THE PURPOSE OF THIS PROJECT WAS TO SURVEY AND MONUMENT THE ADJUSTED PROPERTY LINE DESCRIBED IN DEED INSTRUMENT NO. 20221273.

A SEARCH WAS MADE OF AVAILABLE RECORDS PERTAINING TO THIS SURVEY AND FIELD MEASUREMENTS WERE MADE TO LOCATE APPURTENANT MONUMENTS FROM RECORD LAND PARTITION PLAT NO. 2011-04. THE FOUND IRON PINS SHOWN HEREON WERE IN GOOD CONDITION AND ACCEPTED AS CONTROLLING MONUMENTS FOR THIS SURVEY.

I SET NEW MONUMENTS ACCORDING TO THE EVIDENCE FOUND AND THE DEED DESCRIPTION.
GOD BLESS AMERICA.

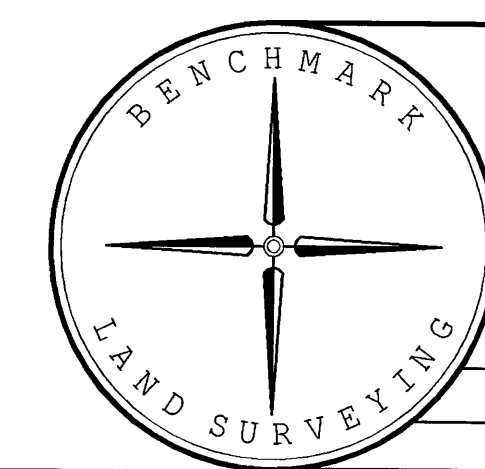

BENCHMARK LAND SURVEYING 217 N. CANYON BLVD. JOHN DAY, OREGON 541-575-1251		
SHOWING A PROPERTY LINE ADJUSTMENT BETWEEN PARCEL 3 OF LAND PARTITION PLAT NO. 2020-03 AND PARCEL 2 OF LAND PARTITION PLAT NO. 2011-04 SITUATED IN THE SE1/4 SECTION 22, T.13S., R.31E., W.M.,		
PREPARED FOR	IRON TRIANGLE, LLC	
SURVEYED BY	MCS & DDD	6/28/2022
SCALE: 1"=50'	DRAWN BY MCS	