

BASIS OF BEARINGS

RECORD MAP OF SURVEY NO. 442
AS SHOWN

LEGEND

- FOUND 5/8" IRON PIN WITH ATTACHED YELLOW PLASTIC CAP MARKED BENCHMARK SURVEYING
- FOUND 5/8" IRON PIN - NO CAP
- FOUND 5/8" IRON PIN WITH ATTACHED YELLOW PLASTIC CAP MARKED BGF SURVEY MK
- SET 5/8"x30" IRON PIN, UNLESS OTHERWISE NOTED, WITH ATTACHED YELLOW PLASTIC CAP MARKED BENCHMARK SURVEYING
- () RECORD DISTANCE FROM PLAT OF PRAIRIE CITY LAND COMPANY'S SECOND ADDITION
- 1[] RECORD BEARING AND DISTANCE: RECORD SURVEY NO. 225
- 2[] RECORD BEARING AND DISTANCE: RECORD SURVEY NO. 442
- 3[] RECORD OR CALCULATED BEARING AND DISTANCE: RECORD SURVEY NO. 536
- 4[] RECORD BEARING AND DISTANCE: RECORD SURVEY NO. 1284
- 5[] RECORD BEARING AND DISTANCE: RECORD SURVEY NO. 1991
- FOUND MONUMENT FROM RECORDED SURVEY NO.
- X—X WOOD FENCE LINE
- SFNF RECORD SURVEY MONUMENT SEARCHED FOR, NOT FOUND

NARRATIVE

THIS SURVEY WAS PERFORMED AT THE REQUEST OF CHARLENE MORRIS AND WANDA WINEGAR. THE PURPOSE OF THIS SURVEY WAS TO MONUMENT THE FOUR CORNERS OF LOT 7, BLOCK 21 OF PRAIRIE CITY LAND COMPANY'S SECOND ADDITION TO PRAIRIE CITY. THE SUBJECT PROPERTY IS DESCRIBED IN GRANT COUNTY DEED INSTRUMENT NO. 20151996.

A SEARCH WAS MADE OF THE AVAILABLE RECORDS PERTAINING TO THIS SURVEY. COUNTY SURVEYOR RECORDS SHOW THE FOLLOWING RELEVANT RECORD SURVEY NO'S: 225, 442, 536, 1284 AND 1991. I ALSO USED INFORMATION FROM THE PLAT OF PRAIRIE CITY LAND COMPANY'S FIRST AND SECOND ADDITIONS, RIVERSIDE FIRST ADDITION TO PRAIRIE CITY AND PRAIRIE CITY ORDINANCE NO. 42.

WE LOCATED THREE OF THE FOUR IRON PINS SET AT THE CORNERS OF LOTS 3 AND 4 FROM SURVEY NO. 536. WE ALSO FOUND AND ACCEPTED APPURTENANT IRON PINS FROM SURVEY NO.'S 225, 442, AND 1991, AS SHOWN HEREON.

I CALCULATED THE POSITION OF THE SOUTHEAST CORNER OF LOT 4, BLOCK 21 BY RUNNING THE RECORD BEARING AND DISTANCE FROM SAID SURVEY NO. 536 FROM THE FOUND PIN AT THE NORTHEAST CORNER OF LOT 3. I HELD THE ACCEPTED SURVEY MONUMENTS ALONG THE SOUTH LINE OF SIXTH STREET AND USED THE RECORD PLAT WIDTH TO ESTABLISH THE NORTH LINE OF SAID STREET.

IT SHOULD BE NOTED THAT THE PLATS OF PRAIRIE CITY LAND COMPANY'S FIRST ADDITION (PCLC 1) AND PRAIRIE CITY LAND COMPANY'S SECOND ADDITION (PCLC 2) SHOW LOTS A AND B INCLUDED WITHIN THE 50 FOOT WIDTH OF LOTS 8 AND 9, BLOCK 21, RESPECTIVELY. THESE LOTS WERE CREATED WHEN PCLC 2, WHICH WAS A REPLAT OF THOSE PORTIONS OF PCLC 1 LYING IN THE SW1/4SW1/4 SECTION 2, WAS CREATED. LOTS A AND B ARE THE REMNANTS OF LOTS 8 AND 9 FROM PCLC 1 THAT WERE SOUTH OF THE COMMON LINE BETWEEN SECTIONS 2 AND 11. IT IS CLEAR FROM INSPECTING THE DIMENSIONS AND SCALE OF LOTS ON BOTH PLATS THAT THE COMBINED WIDTH OF LOT 8 / A AND LOT 9 / B IS 50 FEET. I DID NOT LOCATE THE SOUTH LINE OF SECTION 2 AS PART OF THIS SURVEY.

I ESTABLISHED LOTS 5 THROUGH 8 / A AT PROPORTIONATE MEASURE BETWEEN THE SOUTH LINE OF LOT 4 AND THE NORTH LINE OF SIXTH STREET. THE LOT DIMENSIONS AGREE VERY CLOSELY WITH THOSE CALCULATED FROM RECORD SURVEY NO. 536. AT THE REQUEST OF MRS. MORRIS AND MRS. WINEGAR, I SET IRON PINS AT THE FOUR CORNERS OF LOT 7.

REFERENCES

RECORD MAP OF SURVEY NO.'S 225, 442, 536, 1284 & 1991
DEED RECORD INSTRUMENT NO. 20151996
DEED RECORD BOOK 37 PAGE 611 (PRAIRIE CITY ORDINANCE NO. 42)
PLATS OF PRAIRIE CITY LAND COMPANY'S FIRST AND SECOND ADDITIONS
PLAT OF RIVERSIDE ADDITION

RECEIVED AND FILED
GRANT COUNTY SURVEYOR

AUG 2 2018

BY:

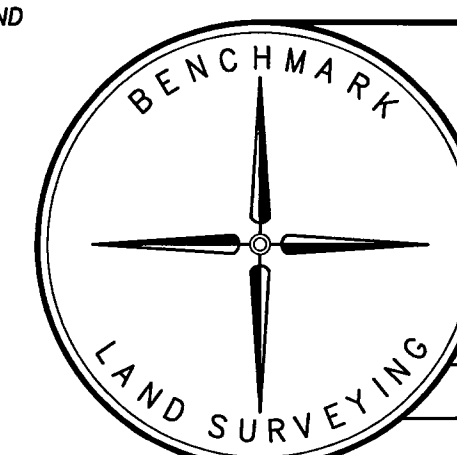

BENCHMARK LAND SURVEYING
217 N. CANYON BLVD. JOHN DAY, OREGON
1207 DEWEY AVE., BAKER CITY, OREGON
541-575-1251 ~ 541-523-5852

MAP OF SURVEY
LOT 7, BLOCK 21 OF PRAIRIE CITY LAND COMPANY'S SECOND ADD.
SITUATED IN THE SW1/4SW1/4 SECTION 2, T.13S., R.33E., W.M.,
CITY OF PRAIRIE CITY, GRANT COUNTY, OREGON

SURVEYED FOR	WANDA WINEGAR & CHARLENE MORRIS
SURVEYED BY	MCS & JBS
Scale: 1"=50'	8/1/2018
Drawn by: MCS	

RECORD MAP OF SURVEY NO. 2096