

LEGEND

- FOUND 1/2" GALV. IRON PIPE WITH ATTACHED GRANT COUNTY SURVEYOR BRASS CAP MARKED FOR 1/4 CORNER AND PLS 70918 - 2013
- FOUND BRASS DISC SET IN A 6" CONCRETE CYLINDER MARKED FOR 1/4 CORNER AND PLS 1099 - 1982
- G() GLO RECORD BEARING AND DISTANCE
- [] RECORD BEARING AND DISTANCE PER SURVEY NO. 745
- APPROXIMATE LOCATION OF A ROAD WAY
- POSTED PORTION OF EAST-WEST CENTERLINE OF SECTION

BASIS OF BEARINGS

GEODETIC NORTH
FROM A GPS OBSERVATION TAKEN
NEAR THE S1/4 CORNER SEC. 12

REFERENCES

RECORD MAP OF SURVEY NO. 745
GRANT COUNTY CORNER RESTORATION RECORDS
GLO FIELD NOTES

NARRATIVE

THIS SURVEY WAS PERFORMED AT THE REQUEST OF SHANNON RUST. THE PURPOSE OF THIS SURVEY WAS TO LOCATE THE EAST AND WEST QUARTER CORNERS OF SECTION 12, T.7S., R.30E., AND TO POST A PORTION OF THE LINE BETWEEN SAID CORNERS, AS SHOWN HEREON.

A SEARCH WAS MADE OF THE AVAILABLE RECORDS PERTAINING TO THIS SURVEY. I LOCATED THE BRASS DISC MONUMENT AT THE E1/4 CORNER OF SAID SECTION 12, WHICH WAS SET IN 1982 BY GARY LANGLITZ, PLS. SEE RECORD MAP OF SURVEY NO. 745 FILED IN THE OFFICE OF THE GRANT COUNTY SURVEYOR FOR DETAILS.

I PREVIOUSLY REMONUMENTED THE W1/4 CORNER FROM ORIGINAL GLO EVIDENCE. SEE CORNER RESTORATION RECORD FILED IN THE OFFICE OF THE COUNTY SURVEYOR FOR DETAILS.

PER INSTRUCTION FROM MRS. RUST, WE POSTED THE EAST-WEST CENTERLINE OF SECTION 12 FROM THE W1/4 CORNER EASTERLY TO A POINT APPROXIMATELY 200 FEET EAST OF A ROAD, AS SHOWN HEREON.

RECEIVED AND FILED
GRANT COUNTY SURVEYOR
MAY 9 2013
BY: *[Signature]*

REGISTERED
PROFESSIONAL
LAND SURVEYOR

[Signature]

OREGON
JULY 9, 2002
MICHAEL C. SPRINGER
#70918
EXPIRES: 6/30/2014

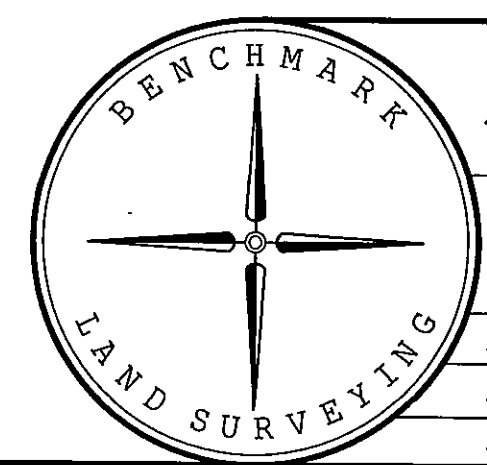

BENCHMARK LAND SURVEYING
217 N. CANYON BLVD. JOHN DAY, OREGON
2101 MAIN STREET, STE 223 BAKER CITY, OREGON
541-575-1251 ~ 800-699-0516

MAP OF SURVEY
SITUATED IN THE S1/2 SECTION 12, T.7S., R.30E., W.M.,
GRANT COUNTY, OREGON

SURVEYED FOR	SHANNON RUST	
SURVEYED BY	MCS & JLH	5/8/2013
Scale: 1"=1000'	Drawn by: MCS	