

## NARRATIVE

THIS SURVEY WAS PERFORMED AT THE REQUEST OF MARK HENSLEY, GRANT COUNTY ROADMASTER. THE PURPOSE OF THIS SURVEY WAS TO MONUMENT A PROPOSED RIGHT OF WAY ALIGNMENT CHANGE ON MIDDLE FORK COUNTY ROAD NO. 20 THROUGH THE TOWN SITE OF GALENA.

THE TOWN SITE OF GALENA WAS ORIGINALLY PLATTED IN 1904 BY CHARLES G. CASPARY, COUNTY SURVEYOR. THE RIGHT OF WAY OF MAIN STREET WAS PLATTED AS 60 FEET WIDE, RUNNING N.14°25'W., 1044 FEET FROM THE SOUTH LINE OF THE TOWN SITE TO AN ANGLE POINT, THEN N.34°20'W., 354 FEET TO INTERSECT THE CENTERLINE OF AN UNNAMED STREET ON THE NORTH END OF TOWN. NO INDICATION IS MADE WHETHER OR NOT ANY PERMANENT MONUMENTATION WAS SET DURING THE ORIGINAL SURVEY.

MIDDLE FORK COUNTY ROAD IS COINCIDENT WITH MAIN STREET IN GALENA. IN THE LATE 1980'S, THE COUNTY ROAD WAS REALIGNED AND PAVED. JAMES HANLEY, PE, PLS. WAS THE COUNTY ENGINEER FOR GRANT COUNTY AT THE TIME, AND WAS RESPONSIBLE FOR THE DESIGN AND CONSTRUCTION STAKING FOR THE PROJECT. IN 1987, NEW RIGHT OF WAY WAS ACQUIRED BY THE COUNTY AS EVIDENCED BY DEEDS RECORDED IN BOOK 135, PAGES 813 THROUGH 816 TO ACCOMMODATE A CURVE THROUGH BLOCKS 4 AND 5.

I MADE FIELD MEASUREMENTS TO LOCATE APPURTENANT MONUMENTS FROM THE FOLLOWING SURVEYS:

SURVEY NO. 365 BY JAMES HANLEY, PE, IN 1975; SURVEY NO. 1107 BY TYLER PARSONS, PLS, IN 1989; SURVEY NO. 1490 BY ROBERT BAGETT, PLS, IN 1988; SURVEY NO. 1573 BY JACK WATSON IN 2000 AND SURVEY NO. 1904 WHICH I COMPLETED IN 2010. I ALSO LOCATED THE EDGE OF PAVING, AND EXISTING BUILDINGS AND FENCES ALONG THE ROAD. IT BECAME APPARENT THAT THERE ARE TWO BUILDINGS ENCRoACHING ONTO THE RIGHT OF WAY. ONE OF THE BUILDINGS IS SITUATED ON LOT 5, BLOCK 5 AND THE OTHER BUILDING SITS ENTIRELY IN THE RIGHT OF WAY ADJACENT TO LOTS 7 AND 8 IN BLOCK 3.

THE ALIGNMENT PROPOSED HEREON REQUIRES THE VACATION OF TWO SMALL SLIVERS OF RIGHT OF WAY IN BLOCKS 4 AND 5, AND THAT PORTION OF THE OLD MAIN STREET RIGHT OF WAY SITUATED ADJACENT TO BLOCK 3 AS SHOWN. ALTHOUGH THIS PROPOSED CENTERLINE ALIGNMENT DOES NOT NECESSARILY MATCH THE AS-BUILT CENTERLINE, BOTH BUILDING ENCRoACHMENTS ARE ALLEVIATED. NEW RIGHT OF WAY WILL NEED TO BE ACQUIRED WEST OF THE WEST LINE OF MAIN STREET BETWEEN THE NORTH RIGHT OF WAY LINE OF THE UNNAMED STREET AND THE NORTH LINE OF THE S1/2NW1/4SW1/4.

I HELD THE MONUMENTS FROM SURVEYS 365, 1490, 1573 AND 1904 FOR THE ALIGNMENT OF MAIN STREET. THIRD STREET AND THE NORTH LINE OF BLOCK 5 WAS DETERMINED BY RUNNING BETWEEN THE FOUND MONUMENTS AT THE NE CORNER OF BLOCK 10 AND THE NW CORNER OF LOT 7, BLOCK 3. I BELIEVE IT WAS THE ORIGINAL INTENT THAT THE SOUTH LINE OF THIRD STREET (PROJECTED) BE COINCIDENT WITH THE NORTH LINE OF SAID LOT 7.

DURING SURVEY NO. 1904, I DETERMINED THE CENTERLINE INTERSECTION OF MAIN STREET AND THE UNNAMED STREET AT THE PLAT DISTANCE OF 354.00 FEET FROM THE ANGLE POINT IN MAIN STREET. ALTHOUGH SURVEY NO. 365 SHOWS THE WIDTH OF THE UNNAMED STREET AS BEING 60 FEET, I BELIEVE THIS TO BE IN ERROR. THE WIDTH OF THIS STREET ON THE ORIGINAL PLAT SCALES 40 FEET WITH 20 FEET ON EACH SIDE OF THE CENTERLINE. THIS IS CONSISTENT WITH THE OTHER SIDE STREETS IN GALENA, WHICH ARE ALSO 40 FEET WIDE.

RIGHT OF WAY MONUMENTS WERE SET AT POSITIONS APPROVED BY MARK HENSLEY, AND ACCORDING TO THE EVIDENCE FOUND AND METHODS PREVIOUSLY OUTLINED HEREIN.

## LEGEND

- FOUND 2 1/2" ALUMINUM PIPE AND CAP FROM SURVEY NO. 1107
- FOUND 1/2" IRON PIN WITH ATTACHED YELLOW PLASTIC CAP MARKED "RPE 2808" FROM SURVEY NO. 365
- FOUND 5/8" IRON PIN WITH ATTACHED YELLOW PLASTIC CAP MARKED "BGB SURVEY MARKER" FROM SURVEY NO. 1490
- FOUND 5/8" IRON PIN WITH ATTACHED YELLOW PLASTIC CAP MARKED "BENCHMARK SURVEYING" FROM SURVEY NO. 1904
- FOUND 5/8" IRON PIN WITH ATTACHED RED PLASTIC CAP FROM SURVEY NO. 1573
- SET 5/8"x30" IRON PIN WITH ATTACHED ALUMINUM CAP MARKED "BMLS SURVEY MARKER" AND WITH CORRESPONDING CENTERLINE STATION AND OFFSET INFORMATION
- ( ) RECORD BEARING AND DISTANCE FROM THE PLAT OF GALENA
- [ ] RECORD BEARING AND DISTANCE FROM SURVEY NO. 365
- 1[ ] RECORD BEARING AND DISTANCE FROM SURVEY NO. 1107
- 2[ ] RECORD BEARING AND DISTANCE FROM SURVEY NO. 1490
- 3[ ] RECORD BEARING AND DISTANCE FROM SURVEY NO. 1573
- 4[ ] RECORD BEARING AND DISTANCE FROM SURVEY NO. 1904
- X-X FENCE LINE
- └ BUILDING CORNER
- ▬ CATTLE GUARD

### LINE TABLE

LINE	BEARING	DIST.
L1	S70°00'00"W	15.67
L2	N56°11'30"E	14.77
L3	N33°48'30"W	24.50
L4	N40°00'53"W	35.87
L5	N40°00'53"W	40.24
L6	N40°00'53"W	23.69
L7	N40°00'53"W	25.50

### CURVE TABLE

CURVE	RADIUS	DELTA	LENGTH	LONG CHORD BEARING-DIST.
C1	340.00	9°58'10"	59.16	N18°52'35"W 59.09
C2	370.00	9°58'10"	64.38	N18°52'35"W 64.30
C3	400.00	9°58'10"	69.60	N18°52'35"W 69.51
C4	1330.00	4°01'05"	93.27	N25°52'13"W 93.25
C5	1360.00	16°09'13"	383.43	N31°56'17"W 382.16
C6	1390.00	16°09'13"	391.89	N31°56'17"W 390.59
C7	1390.00	2°03'40"	50.00	N24°53'30"W 50.00
C8	1390.00	7°02'19"	170.76	N29°26'30"W 170.65
C9	1390.00	7°03'14"	171.13	N36°29'16"W 171.02
C10	1330.00	10°21'07"	240.30	N34°50'20"W 239.97
C11	1360.00	4°01'05"	95.38	N25°52'13"W 95.36
C12	1360.00	1°47'01"	42.33	N28°46'16"W 42.33
C13	1360.00	10°21'07"	245.72	N34°50'20"W 245.39

## REFERENCES

RECORD MAP OF SURVEY NO.'S 365, 1107, 1490, 1573 & 1904  
PLAT OF GALENA  
DEED RECORD BOOK 135, PAGES 814-816  
BOOK 122, PAGES 48  
DEED RECORD INSTRUMENT NO.'S 910653  
211657  
223423  
200423410  
20082283  
030206



RECEIVED AND FILED  
GRANT COUNTY SURVEYOR  
OCT 17 2011  
BY: *[Signature]*

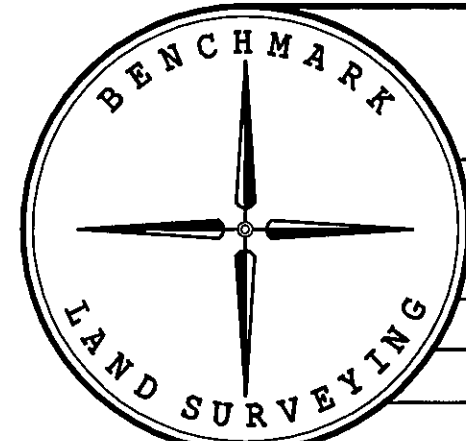

BENCHMARK LAND SURVEYING  
2117 N. CANYON BLVD., JOHN DAY, OREGON  
2101 MAIN STREET, STE 223 BAKER CITY, OREGON  
541-575-1251 ~ 800-699-0516  
MAP OF SURVEY  
MIDDLE FORK COUNTY ROAD NO. 20 PROPOSED RIGHT OF WAY  
THROUGH THE TOWN SITE OF GALENA  
SITUATED IN THE SW1/4 SECTION 12, T.10S., R.32E., W.M.,  
GRANT COUNTY, OREGON  
SURVEYED FOR GRANT COUNTY ROAD DEPARTMENT  
SURVEYED BY JLH & MCS  
SCALE: 1"=50'  
DRAWN BY: JLH