

NE1/4SE1/4  
SANOWSKI

1323.82

S1/16  
COR.

N00°11'35"E 2647.63  
[N00°11'35"E 2647.63]  
G(2640.0)

BASIS OF BEARINGS

SE1/4SE1/4  
NANCE

1323.81

35 36

T.12S. R.33E.  
T.13S. R.33E.

2 1



**BASIS OF  
BEARINGS**  
SURVEY NO. 1910

### NARRATIVE

THIS SURVEY WAS PERFORMED AT THE REQUEST OF JOHN SANOWSKI. THE PURPOSE OF THIS SURVEY WAS TO SET THE S1/16 CORNER BETWEEN SECTION 35 AND SECTION 36, T.12S., R.33E., W.M.

THE CONTROLLING CORNERS FOR THIS SURVEY WERE SET DURING SURVEY NO. 1910, WHICH I PREPARED IN DECEMBER 2010. DURING THIS SURVEY, I SET THE S1/16 CORNER AT THE MIDPOINT BETWEEN THE FOUND CONTROLLING MONUMENTS, AS SHOWN HEREON.

SEE CORNER RESTORATION RECORDS IN THE OFFICE OF THE GRANT COUNTY SURVEYOR FOR DETAILS ON THE ACCESSORIES I SET FOR THIS CORNER.

### LEGEND

- FOUND 5/8" IRON PIN WITH ATTACHED 2" ALUMINUM CAP MARKED BENCHMARK LAND SURVEYING FROM SURVEY NO. 1910
- SET 5/8"x30" IRON PIN WITH ATTACHED 2" ALUMINUM CAP MARKED "BENCHMARK LAND SURVEYING" AND WITH APPROPRIATE 1/16 CORNER DESIGNATIONS SEE CORNER RESTORATION RECORDS FOR DETAILS
- G( ) GLO RECORD BEARING AND DISTANCE
- [ ] RECORD BEARING AND DISTANCE - SURVEY NO. 1910
- x—x FENCE LINE

REGISTERED  
PROFESSIONAL  
LAND SURVEYOR

OREGON  
JULY 9, 2002  
MICHAEL C. SPRINGER  
#70918  
EXPIRES: 6/30/2012

RECEIVED AND FILED  
GRANT COUNTY SURVEYOR

MAR 21 2011

BY: 

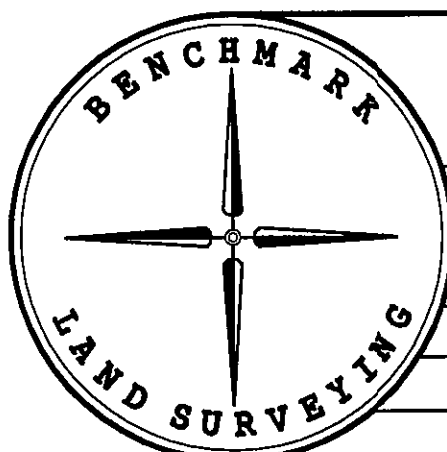

BENCHMARK LAND SURVEYING  
217 N. CANYON BLVD. JOHN DAY, OREGON  
2101 MAIN STREET, STE 223 BAKER CITY, OREGON  
541-575-1251 ~ 800-699-0516

MAP OF SURVEY  
SITUATED IN THE SE1/4 SECTION 35  
T.12S., R.33E., W.M.,

GRANT COUNTY, OREGON

SURVEYED FOR	JOHN SANOWSKI	
SURVEYED BY	MCS	3/18/2011
Scale: 1"=300'	Drawn by: MCS	

RECORD MAP OF SURVEY NO. 1920