

# **BASIS OF BEARINGS** PLAT OF STRAWBERRY ADDITION NO. 2 AS SHOWN

## **NARRATIVE**

THIS SURVEY WAS PERFORMED AT THE REQUEST OF MIKE SPRINGER. THE PURPOSE OF THIS SURVEY WAS TO MONUMENT THAT CERTAIN TRACT OF LAND DESCRIBED IN DEED INSTRUMENT NO. 20100427, DEED RECORDS OF GRANT COUNTY, OREGON.

A SEARCH WAS MADE OF THE AVAILABLE RECORDS PERTAINING TO THIS SURVEY. WE MADE FIELD MEASUREMENTS TO LOCATE THE CONTROLLING SURVEY MONUMENTS FROM RECORD SURVEY NO. 422 AND FROM STRAWBERRY ADDITION AND STRAWBERRY ADDITION NO. 2.

THE EAST LINE OF THE SURVEYED TRACT IS PARALLEL TO THE EAST LINE OF STRAWBERRY ADDITION AND AT A DISTANCE OF 286.67 FEET, WHEN MEASURED ALONG THE SOUTH LINE OF SAID TRACT. A TYPOGRAPHICAL ERROR IN THE DEED DISTANCE SHOWS SAID LINE BEING 287.67 FEET. THE SOUTH LINE OF THE SURVEYED TRACT IS AN EXTENSION OF THE SOUTH LINE OF 13TH STREET.

THE 5/8 INCH IRON PIN AT THE NW CORNER OF LOT 1 OF STRAWBERRY ADDITION NO. 2 HAS BEEN DISTURBED BY UTILITY TRENCHING ACTIVITIES. THE PIN IS NOT IN POSITION AND IS APPROXIMATELY 18 INCHES OUT OF THE GROUND. THE 5/8 INCH IRON PIN AT THE SE CORNER OF LOT 9 OF STRAWBERRY ADDITION HAS ALSO BEEN DISTURBED. THE PIN IS 0.21 FEET SOUTH AND 0.09 FEET EAST OF THE RECORD POSITION. I DO NOT ACCEPT THESE TWO PINS.

I ACCEPT THE REMAINING MONUMENTS SHOWN HEREON. NEW MONUMENTS WERE SET IN ACCORDANCE WITH THE EVIDENCE FOUND AND THE DEED DESCRIPTION.

## **LEGEND**

- FOUND 5/8" IRON PIN WITH ATTACHED YELLOW PLASTIC CAP MARKED "HANLEY ENGR PLS 1206"
- FOUND 5/8" IRON PIN - NO CAP FROM STRAWBERRY ADDITION - UNLESS OTHERWISE NOTED
- SET 5/8"x30" IRON PIN WITH ATTACHED YELLOW PLASTIC CAP MARKED "BENCHMARK SURVEYING"
- ( ) RECORD BEARING AND DISTANCE FROM STRAWBERRY ADDITION
- [ ] RECORD BEARING AND DISTANCE FROM STRAWBERRY ADDITION NO. 2
- D( ) DEED RECORD BEARING AND DISTANCE
- FOUND MONUMENT FROM RECORDED SURVEY NO.
- X—X FENCE LINE

## **REFERENCES**

RECORD MAP OF SURVEY NO.'S 422 & 466  
DEED RECORD INSTRUMENT NO. 20100427  
DEED RECORD BOOK 136, PAGE 84  
PLAT OF STRAWBERRY ADDITION  
PLAT OF STRAWBERRY ADDITION NO. 2

RECEIVED AND  
FILED  
April 29, 2010  
OFFICE OF COUNTY SURVEYOR  
ATTEST: *Jason L. Hatfield*

REGISTERED  
PROFESSIONAL  
LAND SURVEYOR  
*Jason L. Hatfield*  
OREGON  
NOVEMBER 30, 2007  
JASON L. HATFIELD  
#69454  
EXPIRES: 6/30/2011

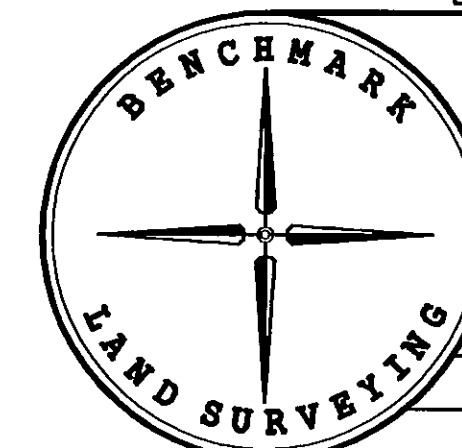

BENCHMARK LAND SURVEYING  
217 N. CANYON BLVD. JOHN DAY, OREGON  
2101 MAIN STREET, STE 223 BAKER CITY, OREGON  
541-575-1251 ~ 800-699-0516

MAP OF SURVEY  
SITUATED IN THE SE1/4 SECTION 11,  
T.13S., R.33E., W.M.,  
CITY OF PRAIRIE CITY, GRANT COUNTY, OREGON

SURVEYED FOR	MIKE AND SHANNON SPRINGER	
SURVEYED BY	JLH & MCS	4/18/2010
Scale: 1"=50'	Drawn by: JLH	

RECORD MAP OF SURVEY NO. 1891