

Ferguson Surveying

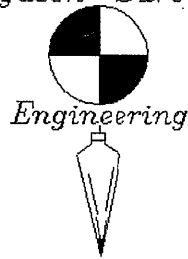

Thoughts on Public Land Survey Corners Evidence Evaluated on August 26, 2008

By: Douglas M. Ferguson P.L.S.

On Tuesday August 28, 2008, at the request of Jason Hatfield, I evaluated the ¼ Corner S6/S7, T.13S., R.30E., and the ¼ Corner S12/S7, T13S, R29/30E. Jack Watson remonumented these corners in July of 2001, the reason being stated as “based on the recovery of original evidence”.

In evaluating the validity of these corners, it is essential to consider that during this and other surveys of that summer of 2001, Mr. Watson claimed to have recovered several corners which later were found to have been based on insufficient evidence. That determination was documented in a report by Mary Hartman of the USFS, and Mike Gardner of the BLM and is on file in this office. Based on this compelling information, I feel it necessary to scrutinize the recovery of evidence more than usual in cases where Mr. Watson is involved.

In the evaluation of these specific PLS corners the pattern seems to remain consistent.

While reading the CERTIFIED RECORD form prepared for ¼ S6/S7, the vagaries in describing the evidence led me to believe that it was probably not conclusive even before looking at the subject stone. In fact, after examining the stone, no marks of any description were found. The original call length of the stone was 30”, Mr. Watson called 34” and the actual measure length is 38”. I made an examination of this stone under excellent lighting conditions and could not find any marks which appeared to be manmade. Even though the position of this subject stone is within reason, all measurements to surrounding corners and evidence lead to a better fit to the east. We searched again, primarily to the east, with nothing remarkable located. There is the remains of an old fence which courses E-W, approximately 60 feet north of this position. I believe this old fence line is worth considering as an element of evidence.

I would be more inclined to recommend the acceptance of this stone if Mr. Watson had made some attempt to build a case for its position. His statement “*Found stone 34x12x10 inches, 6” in ground, marked ¼*” indicates deception to me.

In regard to the ¼ S12/S7, the notes are clear and Mr. Watson’s description of the evidence found is clear and concise; “*Found a stone 18x12x5, 6” the ground, marked ¼ on the west face*”. Based on this we predicted that the stone would be clearly marked. It was. As soon as the stone was exhumed and the proper face in view, a typical John B. David ¼ was clearly visible.

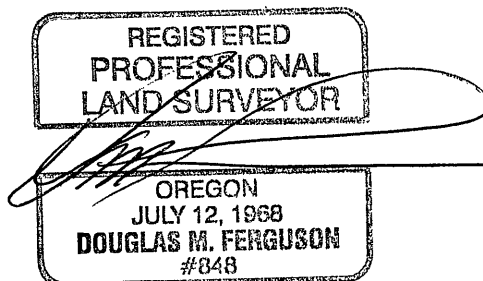

RECEIVED AND FILED

SEPT 22, 2008

OFFICE OF COUNTY SURVEYOR
Attest: *[Signature]*

Map of Survey #1844