

# LEGEND

- Found 1½" iron pipe with attached 2½" Grant County Surveyor brass cap, see Survey No. 154.
- Set 5/8"x30" iron pin with attached alum. cap marked CORNERSTONE SURVEYING, INC. with the appropriate corners designation.
- Set 2½" aluminum pipe with attached 3½" aluminum cap. See corner restoration sheet for details.
- X—X Fence Line
- ( ) Record bearing and distance.

## NARRATIVE

This survey was performed at the request of Vega Nunez. The purpose of this survey was to establish the W1/16 and E1/16 corners on the south line of Section 4 and to stake the property line between these two corners.

This survey was performed using static GPS receivers and Electronic Total Station. The bearings for this survey are based on the GPS survey. The GPS survey was made in NAD 83 State Plane Coordinates, Oregon North Zone. The State Plane bearings were rotated clockwise 00°58'32" to true north near the E1/4 corner of Section 4. All Bearings are relative to this local north meridian.

A search was made of the available records pertaining to this survey. Field measurements were made to locate existing monuments and fences and to establish the new corners. The SW corner of Section 4 was established by Duane Griffith in 1969, I accepted this corner. A search was made for the S1/4 corner of Section 4 but no evidence of the original corner monument or the bearing tree were found. Mr. Morris, the landowner to the south, said that several surveyors over the years have looked for the S1/4 corner without finding it. There are several blazes to the east of the 1/4 corner which are not original. There has been logging in the area over the years which may explain these blazes.

Before beginning the survey I spoke with the Mr. Morris who owns the land at the SE corner of Section 4 and with Mrs. Nunez. Mr. Morris and Mrs. Nunez told me of a pile of rocks near the SE section corner. Mr. Morris explained that the pile of rocks was first made know to him 7 or 8 years ago and he does not know who may have put it there. I examined the pile of rocks and did not find any evidence of the original corner stone. The GLO notes call the top of the hill two chains north and the top of the hill 1.17 chains west of the corner. The top of the hill is well defined in this area. The position of the pile of rocks does not fit either call. I searched the surrounding area and did not find any evidence of the original corner stone or the pits which are called for. After much consideration I decided that the original topographic calls to the top of the hill are the best evidence to the position of the original corner. There is only one place that the two calls will fit to the top of the hill and that is where I set the SE section corner monument.

I established the W1/16 and E1/16 corners in accordance with the 1973 BLM Manual of Surveying Instructions and staked the line between the two corners.

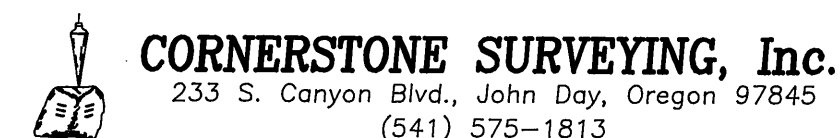
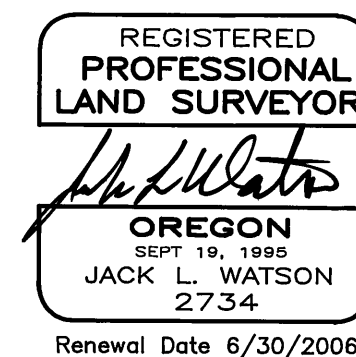

RECEIVED AND  
FILED

JULY 5, 2005  
OFFICE OF COUNTY CLERK  
JOHN DAY, OREGON

MAP OF SURVEY SITUATED IN THE SE1/4 AND SW1/4 OF SECTION 4 T8S, R30E, W.M.	
GRANT COUNTY, OREGON	
SURVEYED FOR: Vega Nunez	
SURVEYED BY : Jack Watson	Date: 6/27/2005
DRAWN BY : Jack Watson	

MAP OF SURVEY NO. 1736