

MAP OF SURVEY
LOCATED IN SECTIONS 14, 22 & 23, T.8S., R.31E., W.M.
GRANT COUNTY OREGON
Survey Completed July 9, 2004

NARRATIVE

THIS SURVEY WAS PERFORMED TO CORRECT CERTAIN CORNER LOCATIONS AS MONUMENTED ON GRANT COUNTY MAP OF SURVEY NO. 645 AS SHOWN HEREIN. ALSO WHILE PERFORMING THIS SURVEY, CERTAIN LINES IN SECTIONS 22 & 23 ARE LOCATED AND MARKED FOR STILL REVEAL. THIS SURVEY WAS PERFORMED AND FILED IN CONJUNCTION WITH MAP OF SURVEY NO. 1706 BY WILLIAM WELLS.

THE INTERIOR LINES OF T.8S., R.31E., W.M. WERE ORIGINALLY SURVEYED BY F.W. CAMPBELL UNDER G.L.D. CONTRACT NO. 380, DATED MARCH 19, 1881.

IN 1972, I PERFORMED A CONTRACT WITH THE U.S.D.A. FOREST SERVICE TO SEARCH, EVALUATE AND MONUMENT CORNERS IN THIS AREA. I RECOVER WHAT I BELIEVED TO BE THE ORIGINAL STONE AT THE SOUTH 1/4 CORNER OF SECTION 14 AND SET A MONUMENT. NO MEASUREMENTS ARE MADE TO OTHER CORNERS OR EVIDENCE UNDER THIS CONTRACT.

IN 1979, WILLIAM WELLS PERFORMED A SURVEY UNDER CONTRACT WITH THE U.S.D.A. FOREST SERVICE, FILED AS GRANT COUNTY MAP OF SURVEY NO. 599. MR. WELLS PROPORTIONED THE SECTION CORNER TO THE SOUTH 1/4 OF SECTION 14, THE CORNER 4 MILES TO THE WEST, 18, 19 & 24, THE CORNER 1 MILE TO THE NORTH, 14 & 15, AND THE CORNER 2 1/2 MILES TO THE SOUTH, 34 & 35.

IN 1980, I PERFORMED A SURVEY, AGAIN UNDER CONTRACT WITH THE FOREST SERVICE, GRANT COUNTY MAP OF SURVEY NO. 645, FILED ON JANUARY 12, 1981. I UTILIZED BOTH OF THE MONUMENTS STATED ABOVE TO SUBDIVIDE AND MARK BOUNDARIES IN SECTION 14.

IN 1999, DENNIS GAYLORD REPORTED FINDING THE ORIGINAL STONE AT THE SECTION CORNER TO SECTIONS 15, 16, 21 & 22 AND MONUMENTED IT'S POSITION.

IT WAS BROUGHT TO MY ATTENTION, IN 2002, THAT MR. GAYLORD MAY HAVE RECOVERED THE ABOVE SAID SECTION CORNER. MR. WELLS PROVIDED A MAP SHOWING THE RELATIONSHIP OF THE GAYLORD MONUMENT TO THE SURROUNDING MONUMENTS PREVIOUSLY SET BY PROPORTIONATE MEASURE. MR. WELLS AND I CONDUCTED SEVERAL FIELD REVIEWS OF CORNERS, INCLUDING THE SAID GAYLORD CORNER AND THE SW CORNER OF SECTION 14. APPROXIMATELY 120' EAST OF THE PROPORTIONED SW CORNER OF SECTION 14, MR. WELLS FOUND A MARKED STONE, LYING LOOSE, NEAR AN OLD FENCE CORNER. AS STATED IN HIS NARRATIVE, THIS STONE WAS NOT THERE IN 1979. THE POSITION OF THIS STONE FITS RECORD FROM THE SECTION CORNERS TO THE NORTH AND EAST. THIS PROMPTED ME TO REVIEW THE EVIDENCE THAT I RECOVER IN 1972 AT THE SW CORNER OF SECTION 14. I FOUND NO VISIBLE MARKS ON THE STONE. I DO NOT ACCEPT THE 1972 POSITION OF THE SW CORNER OF SECTION 14 AND RE-MONUMENT IT AT PROPORTIONATE MEASURE. THE MONUMENTS SET BY PROPORTIONATE MEASURE DURING MY 1980 SURVEY IN SECTION 14 ARE AMENDED AS SHOWN HEREIN TO THEIR CORRECT POSITIONS.

Ferguson Surveying

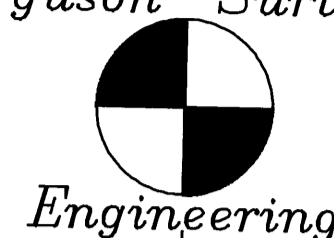

P.O. BOX 519, 210 E. MAIN
MT. VERNON, OR 97865
PHONE (541) 932-4520
FAX (541) 932-4430
EMAIL DFSE@ORTELCO.NET

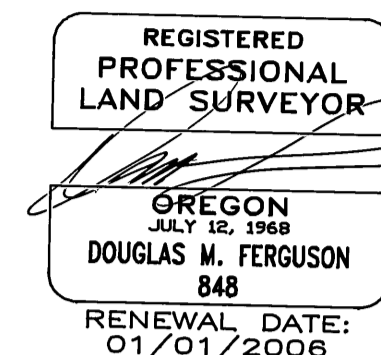

AMENDED MONUMENT TABLE	
NOTE: ALL OLD MONUMENTS SHOWN IN THIS TABLE ARE FOUND BRASS CAPS AS SET ON GRANT COUNTY MAP OF SURVEY NO. 645, EXCEPT THE SW 1/4 OF SECTION 14, WHICH IS A BRASS CAPPED MONUMENT SET IN 1972.	
(A)	OLD MON. BEARS N88°50'11"W, 6.83' FROM NEW CAP
(B)	OLD MON. BEARS N87°02'58"W, 4.91' FROM NEW CAP
(C)	OLD MON. BEARS N89°17'21"W, 9.57' FROM NEW CAP
(D)	OLD MON. BEARS S87°59'26"W, 8.87' FROM CORNER POSITION
(E)	OLD MON. BEARS S86°31'33"W, 20.03' FROM NEW CAP
(F)	OLD MON. BEARS S87°31'39"W, 11.33' FROM NEW CAP
(G)	OLD R.M. BEARS N42°47'04"W, 43.50' FROM NEW CAP
(H)	OLD MON. BEARS S88°54'21"W, 14.88' FROM NEW CAP
(I)	OLD MON. BEARS S82°21'39"W, 57.88' FROM NEW CAP
(J)	OLD MON. BEARS S84°54'33"W, 30.43' FROM NEW CAP
(K)	OLD MON. BEARS S83°58'27"W, 91.66' FROM NEW CAP
(L)	OLD MON. BEARS S84°06'34"W, 43.13' FROM NEW CAP
(M)	OLD MON. BEARS S83°10'00"W, 122.30' FROM NEW CAP

LEGEND

(Bearing/Dist) RECORD BEARING/DIST. AS RETURNED BY F.W. CAMPBELL UNDER G.L.D. CONTRACT NO. 380, DATED MARCH 19, 1881.

Bearing/Dist BEARING/DIST FROM MAP OF SURVEY NO. 599 BY WILLIAM WELLS, FILED JAN. 9, 1980.

[Bearing/Dist] BEARING/DIST FROM MAP OF SURVEY NO. 645 BY DOUGLAS FERGUSON, FILED JAN. 12, 1981.

Bearing/Dist BEARING/DIST FROM MAP OF SURVEY NO. 1706 BY WILLIAM WELLS, FILED IN 2004.

● FOUND MONUMENT OF RECORD. SEE NOTE AT SYMBOL

○ FOUND AN ALUMINUM CAPPED MONUMENT AS SET BY WILLIAM WELLS ON GRANT COUNTY MAP OF SURVEY NO. 1706. REFER TO THE CERTIFIED RECORD OF LAND CORNER MONUMENTATION FILED WITH SAID SURVEY.

○ SET 2-1/2" DIA. X 30" ALUMINUM PIPE MONUMENT WITH 3" ALUMINUM CAP. SEE CERTIFIED RECORD OF LAND CORNER MONUMENTATIONS SHEET REFERENCED TO THIS SURVEY.

● SET 2-1/2" DIA. X 30" ALUMINUM PIPE MONUMENT WITH 3" ALUMINUM CAP AT CORRECTED POSITION. SEE NOTE AT SYMBOL AND NARRATIVE. SEE CERTIFIED RECORD OF LAND CORNER MONUMENTATION SHEETS AS REFERENCE TO THIS SURVEY.

⊠ CALCULATED POSITION, NOT MONUMENTED THIS SURVEY.

===== NATIONAL FOREST BOUNDARY RELOCATED THIS SURVEY

----- LINES LOCATED AND MARKED THIS SURVEY

--- FENCE LINE

DETAIL
SW CORNER SECTION 22

