

04-JAN-1999 14:32

By: J.W. BROPHY  
Designed: J.W. BROPHY  
CADD: J.W. BROPHY  
Checked: J.W. BROPHY  
Approved: J.W. BROPHY

c:\cadd\ldan\row\or115\of11521f.rdw

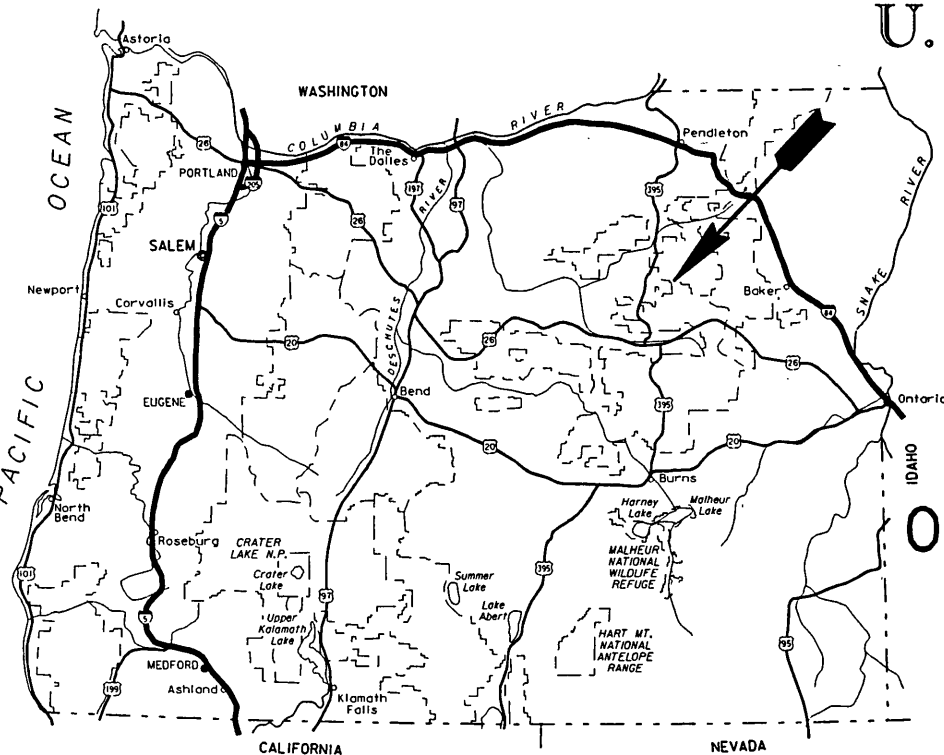

KEY MAP OF OREGON

# U. S. DEPARTMENT OF TRANSPORTATION FEDERAL HIGHWAY ADMINISTRATION



RIGHT-OF-WAY PLANS FOR

## OREGON FOREST HIGHWAY PROJECT PFH 115-1(2) MIDDLE FORK JOHN DAY RIVER ROAD

MALHEUR NATIONAL FOREST  
GRANT COUNTY  
OREGON

LENGTH 5.598 MILES

INDEX TO SHEETS			
SHEET NO.	DESCRIPTION		
1	TITLE SHEET		
4	VICINITY MAP 1		
5-15	PLAN SHEETS 1		
4	VICINITY MAP 2		
5-6	PLAN SHEETS 2		

### Narrative:

I, James H. Hambleton, of Hambleton Construction Inc., 18483 West Campbell Loop, Baker City, Oregon, 97814, being a registered Land Surveyor in the State of Oregon, do hereby certify that the Right-of-Way monuments shown set on this Right-of-Way map was in fact set by myself and crew. I further certify the location of each monument is correctly shown on this map and represents the county right-of-way for the Middle Fork John Day River Road. I was directed to set the above mentioned monuments during the course of construction of the Middle Fork John Day River road which was under contract with the Federal Highway Administration, Grant County, and Steelman-Duff Inc. being the General Prime Contractor. The work was completed October 20, 1998.

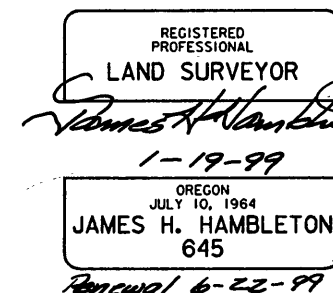

PLAN PREPARED BY  
U.S. DEPARTMENT OF TRANSPORTATION  
FEDERAL HIGHWAY ADMINISTRATION  
WESTERN FEDERAL LANDS HIGHWAY DIVISION  
VANCOUVER, WASHINGTON

U. S. DEPARTMENT OF TRANSPORTATION  
FEDERAL HIGHWAY ADMINISTRATION  
WESTERN FEDERAL LANDS HIGHWAY DIVISION  
VANCOUVER, WASHINGTON

RIGHT OF WAY PLANS

Approved

DATE

LEGEND	
	PROJECTED 1/4 CORNER
	TIED 1/4 CORNER
	PROJECTED SECTION CORNER
	TIED SECTION CORNER
	1/16 LINE
	1/4 LINE
	SECTION LINE
	TOWNSHIP/RANGE LINE
	PAVED ROAD
	ROAD
	RAILROAD
	TRAIL
	RIGHT-OF-WAY MONUMENT SET 3/4 X 30" REBAR WITH 2 1/2" ALUMINUM CAP STAMPED HAMBLETON CONSTRUCTION INC. PSS 994+94.03 40 RT ORLS 645
	RIGHT-OF-WAY MONUMENT NOT SET
	BRASS CAP
	TRAVERSE CONTROL POINT
	STEEL PIN
	HUB

This Easement does not convey any rights to encroach on the Middle Fork John Day River or any National Forest System lands beyond the final location of the lane fences. In any location where the Right-of-Way line, as drawn, extends beyond the final location of the lane fences or the area defined as the normal high water line of the river, whichever is nearest to the highway centerline (location of the lane fences or the high water line) becomes the Right-of-Way line.

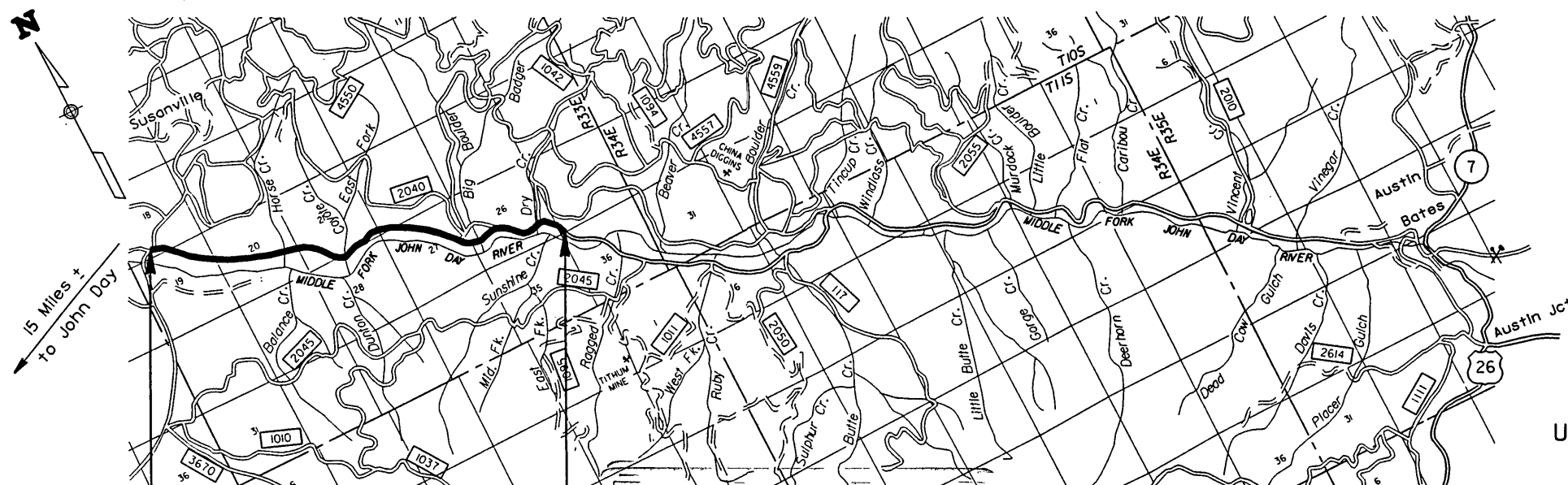

Sta. 817+50.00  
BEGIN PROJECT  
PFH 115-1(2)

Sta. 1113+06.51  
END PROJECT  
PFH 115-1(2)

RECEIVED AND  
FILED

JAN 29 1999

OFFICE OF COUNTY SURVEYOR  
Grant County, Oregon

0 1 2 3  
SCALE IN MILES

MAP OF SURVEY NO. 1502