

LINE TABLE SPRING AREA		
LINE	BEARING	DISTANCE
S-1	N75°48'41"W	87.31
S-2	S63°03'08"W	35.31
S-3	S12°41'44"W	119.89
S-4	S23°33'34"E	46.49
S-5	N57°49'21"E	95.83
S-6	N39°02'10"E	61.30
S-7	N61°42'57"E	264.58
S-8	N25°42'54"W	25.50
S-9	S66°56'05"W	236.66

LINE TABLE CENTERLINE OF PIPELINE CORRIDOR		
LINE	BEARING	DISTANCE
P-1	N01°06'13"W	198.24
P-2	N05°30'30"E	144.90
P-3	N02°45'27"W	101.68
P-4	N16°47'36"W	123.76
P-5	N00°09'35"W	63.74
P-6	N29°08'03"E	38.82
P-7	N45°33'57"E	175.82
P-8	N28°09'05"E	454.71
P-9	N07°39'42"E	1179.45
P-10	N05°33'57"E	303.90
P-11	N5°40'10"E	204.70
P-12	N44°03'54"E	232.01
P-13	N44°03'54"E	38.74

NARRATIVE

THIS SURVEY WAS PERFORMED AT THE REQUEST OF DENNY DAHL, THE PURPOSE OF THIS SURVEY WAS TO LOCATE A PROPOSED PROPERTY ADJUSTMENT LINE, AS SHOWN HEREON, A SEARCH WAS MADE OF THE AVAILABLE RECORDS PERTAINING TO THIS SURVEY. FIELD MEASUREMENTS WERE MADE TO LOCATE THE APPURTENANT MONUMENTS OF RECORD SURVEY NO. 1130, WHICH WERE SET IN JAN. 1960. WE FOUND THE NECESSARY MONUMENTS AS SHOWN HEREON. NEW MONUMENTS WERE SET ON THE PROPOSED PROPERTY ADJUSTMENT LINE AT LOCATIONS APPROVED BY MR. DAHL, THE 20 FOOT STRIP CONTAINS A PIPELINE WHICH TRANSPORTS WATER FROM THE SPRINGS TO THE SE1/4SW1/4 OF SECTION 32.

NW1/4SE1/4

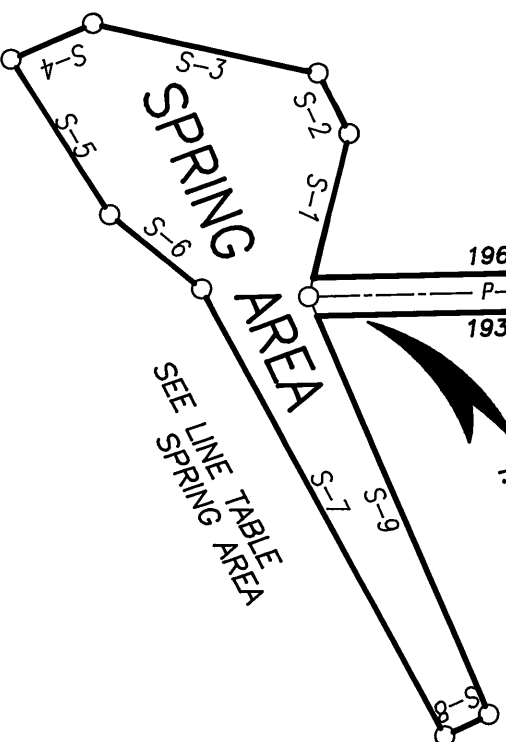

RECEIVED AND
FILED
JULY 23, 1997
OFFICE OF COUNTY SURVEYOR
Robert S. Baggett

REGISTERED
PROFESSIONAL
LAND SURVEYOR
OREGON
JULY 12, 1983
ROBERT S. BAGGETT
Renewed Date 12/31/97

MAP OF SURVEY NO. 1130 AS SHOWN

BASIS OF BEARINGS

LEGEND

- FOUND 5/8" IRON PIN WITH ATTACHED YELLOW PLASTIC CAP MARKED BOB SURVEY MARKER.
- SET 5/8" IRON PIN WITH ATTACHED YELLOW PLASTIC CAP MARKED BOB SURVEY MARKER.

REFERENCES

RECORD MAP OF SURVEY NO. 1130

NOTE: THE SECTION AND SECTION SUBDIVISIONAL INFORMATION ONLY.



GOV'T LOT 1

GOV'T LOT 2

31
32
5

T13S R32E
T14S R32E

5.67'x30' IRON PIN BEING 137.40 SOUTH AND 3796.37 EAST OF NW COR. SEC. 5 T14S, R32E, W.1/4, WHICH IS MONUMENTED BY 5/8" IRON PIN WITH ATTACHED YELLOW PLASTIC CAP MARKED BOB SURVEY MARKER. ATTACHED GOV'T COUNTY SUPERIOR BRASS CAP

PIPELINE CORRIDOR

RECORD SURVEY NO. 1130
N01°18'40"W 670.34
N19°14'54"E 427.17
BASIS OF BEARINGS

D A H L

SW1/4SW1/4

SE1/4SW1/4

BAGGETT, GRIFFITH & BLACKMAN
217 N. Canyon Blvd. John Day, Oregon
PROPERTY LINE ADJUSTMENT
SITUATED IN SW1/4SW1/4 SECTION 32,
T13S, R32E AND IN GOV'T LOT 2
& NW1/4, R32E, W.1/4 SECTION 5
GRANT COUNTY, OREGON
SURVEYED FOR DENNY DAHL
ROB & SIF & DEH
Drawn By: M.J.D.
06/26/97
Scale: 1"=100'
RECORD MAP OF SURVEY NO. 1445