

## A PORTION OF "AUSTIN CADASTRAL"

SUBDIVISION AND DETERMINATION OF  
FOREST BOUNDARY IN SECTIONS  
18 AND 19, T.13S., R.35E., W.M.,  
GRANT COUNTY, OREGON.

Survey by: Susan E. Newstetter, PLS 2405  
D. Mitchell Ferguson, Surv. Tech.  
Rick Saul, Surv. Tech.

Reviewed by: Douglas M. Ferguson PLS 848

Drawn by: Kenneth H. Delano Jr., L.S.T. #1212

For: U.S.D.A. Forest Service  
Malheur National Forest.

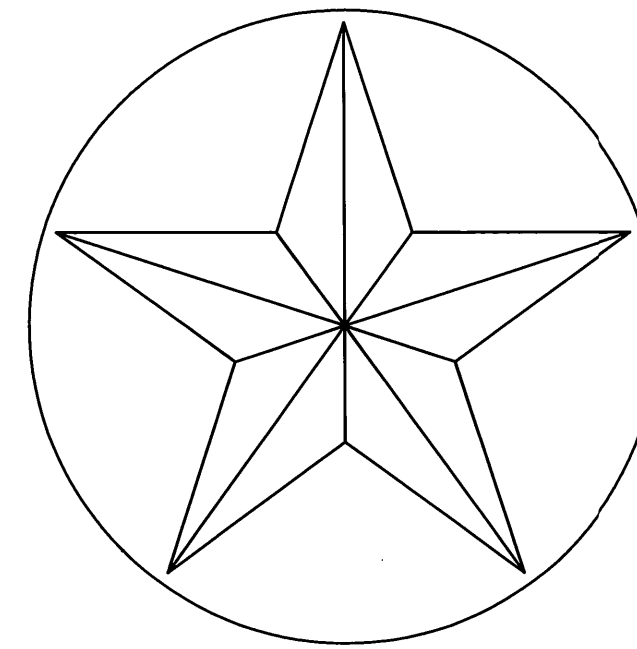

Ferguson Surveying

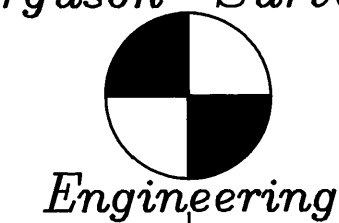

MT. VERNON, OREGON  
PHONE (503) 932-4520  
FAX (503) 932-4430

## VICINITY MAP

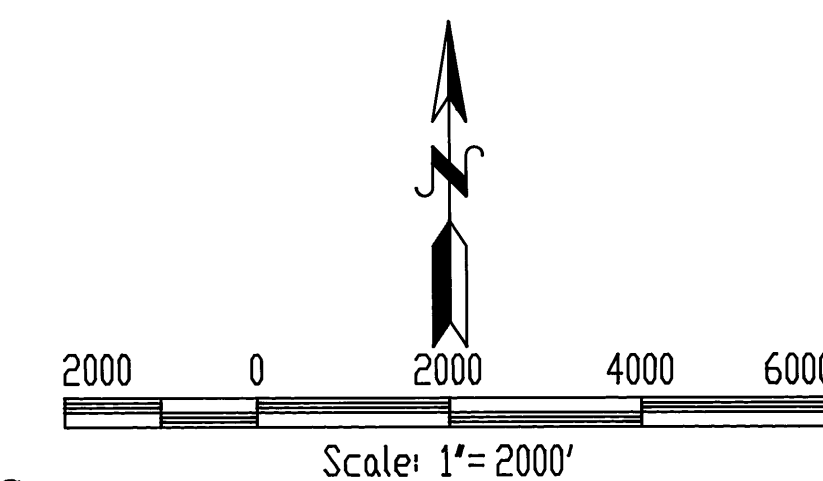

T.13S  
R.34E. R.35E.

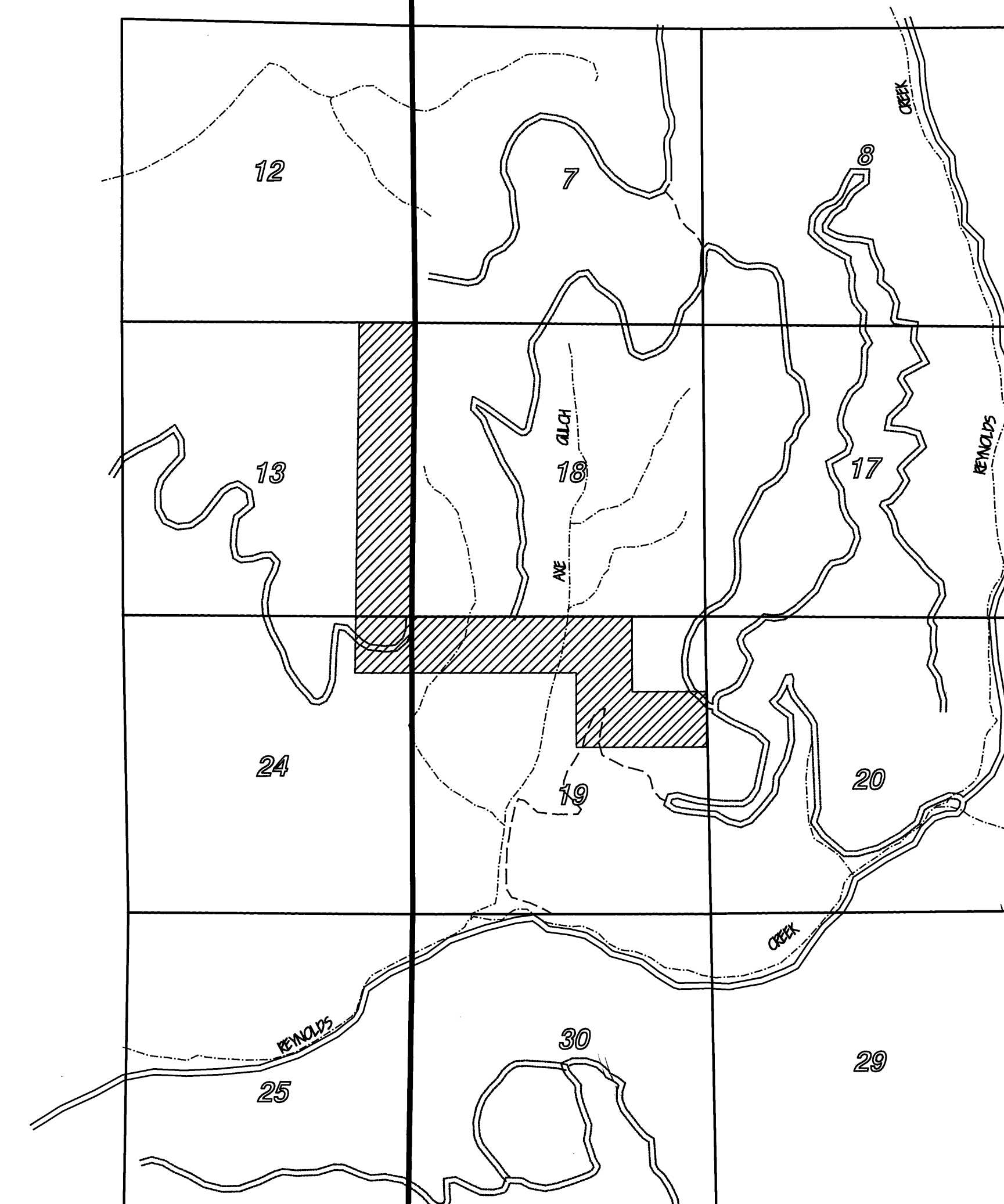

## HISTORY OF SURVEYS

- 1869 - John B. David, GLO Deputy Surveyor, surveyed the west boundary of T.13S., R.35E., W.M., under GLO Contract No. 131.
- 1881 - Danford Robb, GLO Deputy Surveyor, retraced the west boundary of T.13S., R.35E., W.M. and raised mounds of stone around John B. David's corner monuments. In addition he conducted the original subdivision of T.13S., R.35E., W.M. All under GLO Contract No. 383.
- 1981 - David B. Armstrong, PLS 1026, resurveyed the east line of Section 19. See Grant County Map of Survey No. 700.
- 1986 - George W. Colvin, Jr., PLS 1020, remonumented the northwest section corner of Section 18. See Grant County Monumentation Records.
- 1987 - Robert D. Baggett, PLS 598, remonumented the northwest section corner of Section 20. See Grant County Monumentation Records.
- 1987 - Douglas M. Ferguson, PLS 848, resurveyed the south line of Section 19. See Grant County Map of Survey No. 1013.

## NARRATIVE

This survey was performed under contract for the Malheur National Forest for the purpose of marking and posting the Forest boundary in Sections 18 and 19, T.13S., R.35E., W.M.

In order to perform this survey the control survey was run through all of the controlling corners. Original corner evidence was recovered at the northwest section corner of Section 19 and the north 1/4 corner of Section 19. No corner evidence was recovered along the range line for the west 1/4 corners of both Sections 18 and 19 and both were subsequently re-established by single proportionate measurement. All other controlling corners had been previously remonumented by others as indicated in the History and Legend.

All lotting shown on my map of survey is based on the parenthetical distances determined from the original plat for this township approved November 7, 1881 by the Surveyor General of Oregon.

The "Certified Record of Land Corner Monumentation" forms as referenced to this Map of Survey and the notes shown on the Map should be considered a substantial part of this Narrative as they contain detailed information as to the evaluation of evidence and monumentation work performed.

Positional control for this survey is provided by a closed traverse network. A Lietz SDM3E semi-total station was used to obtain measurements and field set monuments from the survey control. An HP Vectra QS/20 (IBM compatible 386) utilizing Wildsoft software was used to perform the computations and the Map was prepared utilizing AutoCad r12. The basis of bearing was determined by solar observation to determine a true meridian through the center of the project. Field notes and computations are on file in the office of Ferguson Surveying and Engineering, Mt. Vernon, Oregon 97865.

I, Susan E. Newstetter, Registered Professional Land Surveyor, in the State of Oregon, hereby certify that this Map, notes and records hereon or reference, are a correct representation of the survey I performed during the months of April - October, 1992 for the U.S. Forest Service in accordance with the Statutes of the State of Oregon and the articles of my Contract Number 53-04KK-2-02803.

Susan E. Newstetter, PLS 2405  
SUSAN E. NEWSTETTER, PLS 2405  
Ferguson Surveying and Engineering

RECEIVED AND  
FILED

JAN 20, 1993

OFFICE OF COUNTY SURVEYOR

Richard D. Baggett

ATTEST: Jeremy Russell

REGISTERED  
PROFESSIONAL  
LAND SURVEYOR

Susan E. Newstetter

OREGON

JULY 28, 1989

SUSAN E. NEWSTETTER

2405

Exp: 12/31/94

EXAMINED AND ACCEPTED FOR THE U.S. FOREST SERVICE  
THIS 1st DAY OF December 1992

SIGNATURE: [Signature] C.O.R.

I CERTIFY THAT THIS SURVEY WAS PERFORMED AT THE  
REQUEST OF THE MALHEUR NATIONAL FOREST

SIGNATURE: [Signature] DATE: 12/2/92  
FOREST SUPERVISOR