

LEGEND

- Set 2-1/2" x 30" aluminum pipe with 3-1/4" aluminum cap, stamped as shown in the "Monumentation" Section
- ⊙ Monumented from original evidence. Set 2-1/2" x 30" aluminum pipe with 3-1/4" aluminum cap, stamped as shown in the "Monumentation" Section
- Found monument of record, as described in the "History" and notes at each corner.
- () Record bearing and distance as returned by William E. Campbell in 1896 under G.L.D. Contract No. 652.
- Exterior Section Lines
- - - Exterior Section Line, Not Surveyed
- N.F.S.L. National Forest System Lands
- PVT. Private Land
- N.F.S.L. / PVT. Marked Forest boundary with steel fence posts and Forest boundary signs at maximum intervals of 250 feet.
- x-x Existing fence with long line showing direction
- (J-9) U.S.F.S. Index Number
- ⊕ Found Line Tree

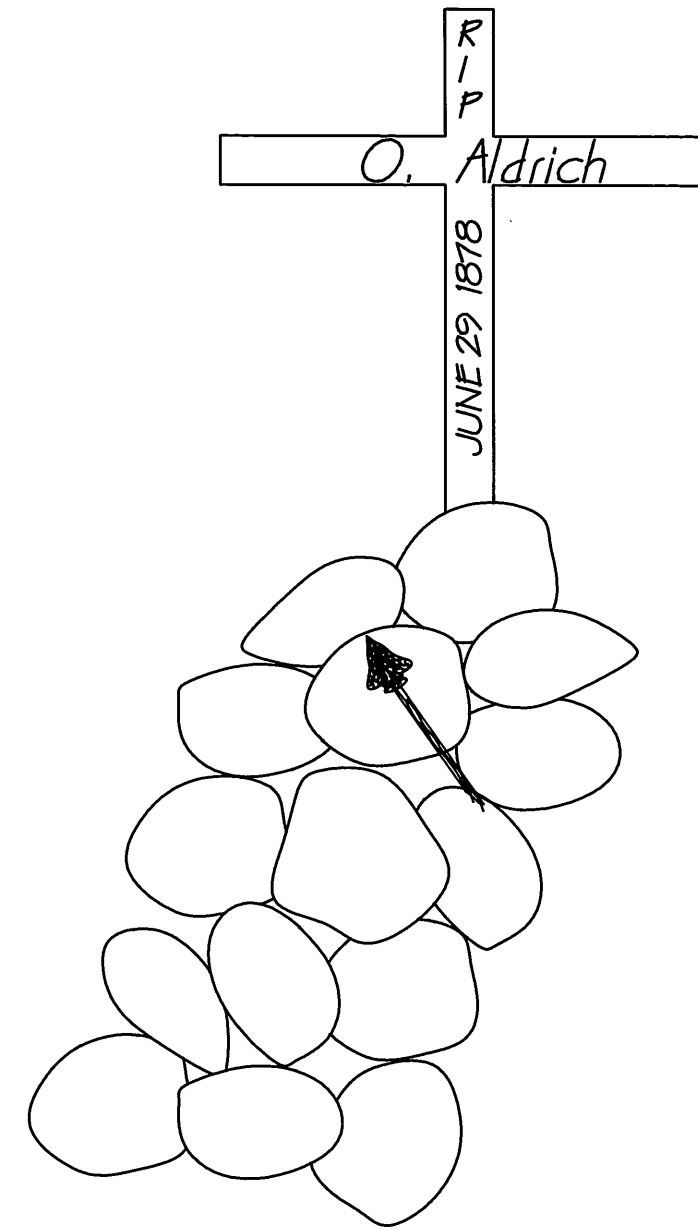

MAGNETIC DECLINATION 20° EAST

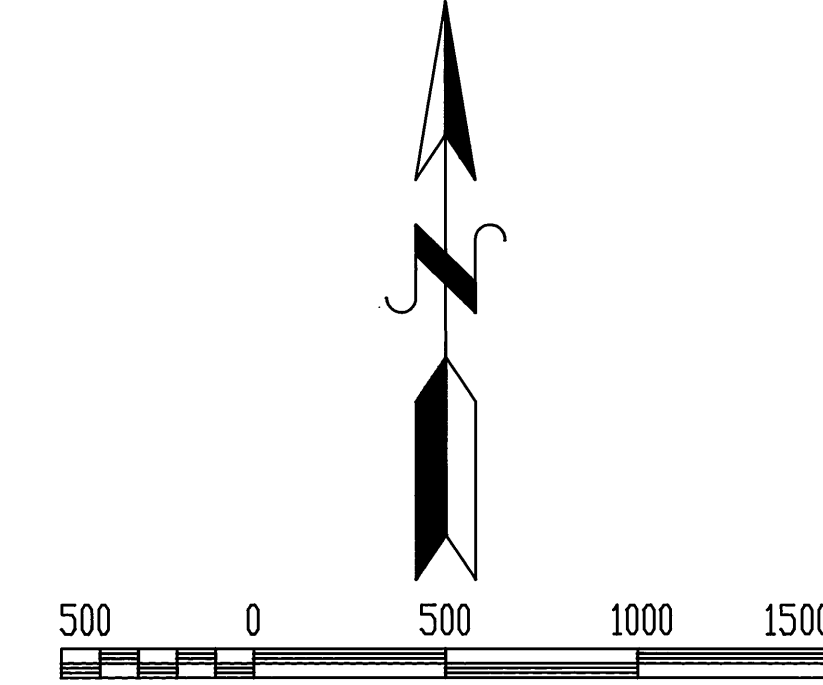

Scale: 1"=500'

BASIS OF BEARING: Solar Observation with True Meridian thru the center of the section.

Ferguson Surveying

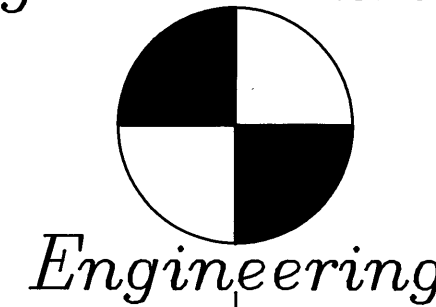

MT. VERNON, OREGON
PHONE (503)932-4520
FAX (503)932-4430

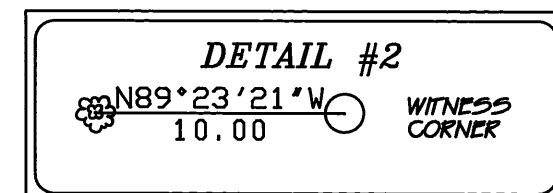
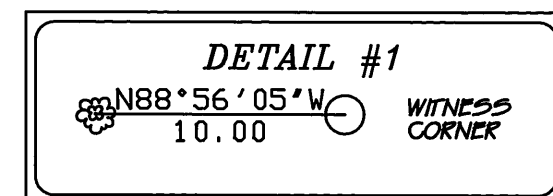

MONUMENTATION

See standard U.S.F.S. "INDEX No." in the circle on the map. Monuments are stamped as shown below. On each Bearing tree, nailed a brass washer stamped "PLS 2405" blaze above the BT scribe and nailed warning signs on the back. Set steel posts with warning and boundary signs, on line within 5 ft. of property corners, or a single post with a warning sign within 5 ft. of controlling corners.

See "CERTIFIED RECORD OF LAND CORNER MONUMENTATION" forms on file in the office of the Grant County Surveyor for a complete history, description of evidence found, monument set, and accessories established at all corners set.

- | | | |
|-----------|--|---|
| (J-9) | T14S R27E
S 8 S 9
S17 S16
1992
PLS 2405 | Ponderosa Pine, 24" dia., bears N35°15'W, 72.6 ft., scribed: T14S R27E S8 BT
Mahogany, 6" dia., bears N47°30'E, 30.6 ft., scribed: T14S R27E S9 BT
Mahogany, 8" dia., bears S68°30'E, 7.8 ft., scribed: T14S R27E S16 BT
Ponderosa Pine, 16" dia., bears S55°45'W, 53.0 ft., scribed: T14S R27E S17 BT |
| (J-11) | T14S R27E
S 9
1/4
S16
1992
PLS 2405 | Douglas Fir, 28" dia., bears N55°15'W, 7.6 ft., scribed: 1/4 S9 BT
Ponderosa Pine, 24" dia., bears N31°30'E, 12.3 ft., scribed: 1/4 S9 BT
Douglas Fir, 12" dia., bears S50°15'E, 9.1 ft., scribed: 1/4 S16 BT
Ponderosa Pine, 14" dia., bears S32°45'W, 18.8 ft., scribed: 1/4 S16 BT |
| (J-12.5) | W C
Line Tree
T14S R27E
10.0' S 9
←
S16
1992
PLS 2405 | Western Larch, 30" dia., bears N34°45'E, 62.9 ft., scribed: LT S 9 BT
Western Larch, 24" dia., bears S68°30'W, 34.7 ft., scribed: LT S16 BT
NOTE: BT.'s are to the Line Tree. |
| (J-12.75) | W C
Line Tree
T14S R27E
10.0' S 9
←
S16
1992
PLS 2405 | Western Larch, 26" dia., bears N26°15'W, 42.1 ft., scribed: LT S 9 BT
Douglas Fir, 12" dia., bears S69°30'E, 33.0 ft., scribed: LT S16 BT
NOTE: BT.'s are to the Line Tree. |
| (J-13) | T14S R27E
S 9 S10
S16 S15
1992
PLS 2405 | Douglas Fir, 26" dia., bears N48°45'W, 38.6 ft., scribed: T14S R27E S9 BT
White Fir, 16" dia., bears N88°45'E, 21.3 ft., scribed: T14S R27E S10 BT
Douglas Fir, 22" dia., bears S59°00'E, 56.7 ft., scribed: T14S R27E S15 BT
Douglas Fir, 32" dia., bears S51°45'W, 35.8 ft., scribed: T14S R27E S16 BT |

Found 18" x 12" x 10" stone
in a rock jack, visible marks.
Accepted and set monument.

N.F.S.L.

Found 32" dia Douglas Fir
snag with blazes on the East
and West sides. Accepted and set
witness corner. See Detail #2.

Found 32" dia Douglas Fir
snag with blazes on the East
and West sides. Accepted and set
witness corner. See Detail #1.

PVT.

PVT.

N.F.S.L.

Found aluminum capped
monument and accessories
as remonumented from original
evidence by David B. Armstrong,
P.L.S. 1026, in 1986.

REGISTERED
PROFESSIONAL
LAND SURVEYOR
Susan E. Newstetter
OREGON
JULY 26, 1988
SUSAN E. NEWSTETTER
2405
Exp: 12/31/94

S17 S16
S20 S21

S16 S15
S21 S22