

CERTIFIED RECORD OF LAND CORNER MONUMENTATION

E-21

**History of original corner establishment:**

Original Survey by Herman D. Gradon in 1884 under G.L.O.

Contract No. 499 states:

Set a post 4 ft. long x 4 inches sq., 24 ins. in ground for cor. to secs. 1, 2, 11 & 12 marked

T9S S1 on NE Face

R35E S12 on SE Face

S11 on SW Face

S2 on N.W. Face with 5 notches on South and 1 notch on the east edges.

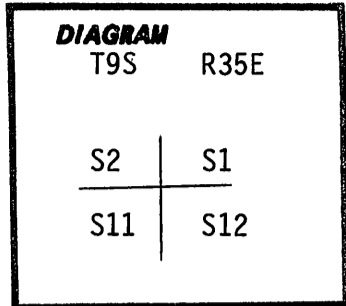

**From which:**

A pine 6" dia. bears N 58°E, 39 lks marked T9S, R35E S1 BT

A tamarack 6" dia. bears S 67°E, 7 lks marked T9S, R35E S12 BT

A pine 6" dia. bears S 34°W, 14 lks marked T9S, R35E S 11 BT

A tamarack 8" dia. bears N 59°W, 19 lks marked T9S, R35E S2 BT

**Description of corner evidence found:**

Present monument established from orig. evid. by William L. Hanley OPLS 1639 Grant County Record Survey No. 575, monument is a 2 1/2" Brass Cap on 2" Iron Pipe

A tamarack 12" dia. with healed blaze for Sec. 12 BT at record bearing and distance

A pine 8" dia. with open blaze and full scribing for Sec. 11 BT at record bearing and distance

A tamarack 13" dia. with healed blaze for Sec. 2 BT at record bearing and distance (dead)

Set a 2 1/2" brass cap on a 2" iron pipe (found) from which:

A tamarack 15" dia. bears N 63°E, 33.9 ft. marked T9S, R35E, S 1 BT

A tamarack 15" dia. bears N 41°W, 51.7 ft. marked T9S, R35E, S 2 BT  
BT in Section 11 is dead.

**Description of monument and accessories established to perpetuate the original location of this corner:**

**New BT**

A 10" fir bears S 23°W, 16.0 ft. marked T9S, R35E, S 11 BT. Attached brass washer stamped LS 1099 to BT blaze.

Compass 20°E declination, steel tape

September 22, 1982

Witnesses: Glen Wagoner  
Greg Orton  
Rod Scott

See Survey filed separately

Refer to Grant County Survey No. 828

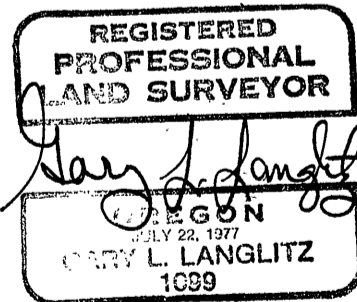

Office of Grant SURVEYOR County of GRANT  
 State of OREGON, I hereby certify that the within instrument was filed in this office  
 for record on the 30 day of AUG, 1982  
Robert D. Day by \_\_\_\_\_  
 (COUNTY OFFICIAL) (DEPUTY)

Form R6-7100-57 (9/71)

SEE RE-MDN FILED 12/13/78