

CERTIFIED RECORD OF LAND CORNER MONUMENTATION

E

History of original corner establishment:

Original survey by Herman D. Gradon Contract No. 499, 1884, states: Set a post 3 ft. long 3 ins. S Qr. 24 ins. in the ground for 1/4 Sec. Cor. From which: A Pine 10 ins. dia. bears N60°E 4 lks. dist. marked 1/4 S BT. A Pine 6 ins. dia. bears S25°W 9 lks. dist. marked 1/4 S BT.

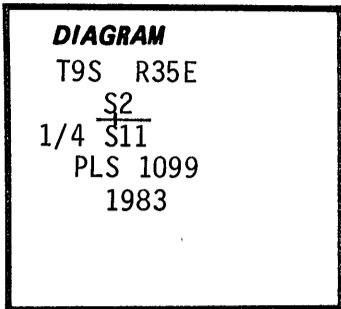

Description of corner evidence found:

None

Description of monument and accessories established to perpetuate the original location of this corner:

At corner position determined by single proportion measurement we set a 2 1/2"x30" galvanized iron pipe 24" in the ground with mound of stone and dirt to top, attached brass cap stamped: T9S R35E
From which: S2
A Spruce 12" dia. bears N 80 1/2°E 84.0 ft. scribed 1/4 S2 BT. 1/4 S11
A Spruce 6" dia. bears S10°W 31.2 ft. scribed 1/4 S11 BT. PLS 1099
Attached brass washers stamped "LS 1099" to lower blaze of both BT's. 1983
Corner located and perpetuated in accordance with Umatilla National Forest Survey Contract No. 53-04R3-2-01275.

Staff Compass (20° Declination)
Steel Tape.

July 27, 1983

Witnesses: Glen Wagoner
Kyle McKinney
Greg Orton

Refer to Grant County Survey No. 828

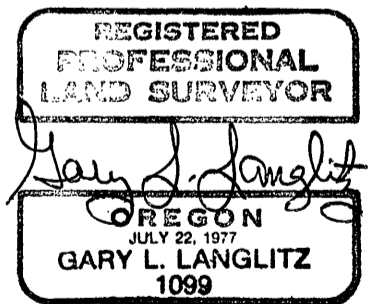

Office of Surveyor County of GRANT
State of OREGON, I hereby certify that the within instrument was filed in this office
for record on the 30 day of AUG, 1984
Robert D. Dyer by _____
(COUNTY OFFICIAL) (DEPUTY)