

CERTIFIED RECORD OF LAND CORNER MONUMENTATION

History of original corner establishment:

Original corner established in 1884 by Herman Gradon:

Set a post 4' long, 4" square, 24" in ground with 5 notches on South and 3 notches on East edges from which:

- A 30" fir bears N 22° E, 25 lks. (15.8 ft.)
- An 8" fir bears S 50° E, 46 lks. (30.4 ft.)
- An 8" pine bears S 46° W, 40 lks. (26.4 ft.)
- A 10" pine bears N 30° W, 20 lks. (13.2 ft.)

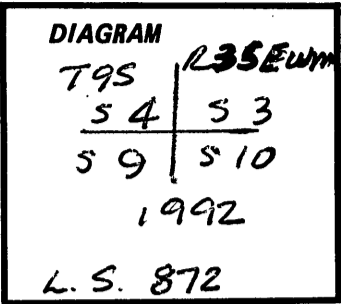

In 1981, Dennis Gaylord, PLS 1636, found N.E. B.T. stump, S.W. B.T. snag, N.W. windfall, and S.E. root hole. Placed signs on N.E. stump, S.W. snag, and 12" fir R.P. S 65° W, 15.0'.

Description of corner evidence found:

No evidence of original corner post.
 Found 36" fir stump, fragment alongside has visible scribing in N.E.
 Found 8" down pine snag, nearly healed blaze, visible scribing in S.W.
 Found 14" fir with Forest Service sign in S.W.

Description of monument and accessories established to perpetuate the original location of this corner:

From Original B.T.'s in N.E. and S.W. and 14" fir R.P. in S.W. set by Gaylord. Reset the corner: a 2" x 36" split-base pipe with 3" brass cap in a 3' mound of stones. Brass cap is marked as shown in the above diagram.

NEW BEARING TREES:

- A 14" fir bears S 65° W, 15.0 ft. Mkd. T9S, R35E, S9 BT
- A 14" fir bears S 34° E, 39.4 ft. Mkd. T9S, R35E, S10 BT
- A 10" pine bears N 48-1/2° E, 62.3 ft. Mkd. T9S, R35E, S3 BT
- A 9" fir bears N 34° W, 42.0 ft. Mkd. T9S, R35E, S4 BT

All trees double blazed with 1" brass disc marked P.L.S. 872 nailed flush to lower blaze.

B.T. tags & 54.9 signs placed on all B.T.'s with 6" red band painted around each B.T. and blazes.

A steel fence post with 54.9 sign was placed by corner.

I hereby certify the above corner point was perpetuated as herein described on October 6, 1992.

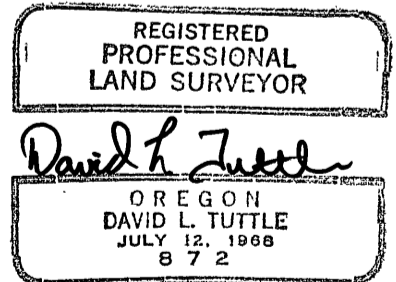

Office of... Surveyor County of... Grant

State of... Oregon, I hereby certify that the within instrument was filed in this office for record on the... 6th ... day of... JAN., 19... 93

Robert D. Bayne by
 (COUNTY OFFICIAL) (DEPUTY)