

CERTIFIED RECORD OF LAND CORNER MONUMENTATION

A-

History of original corner establishment:

None

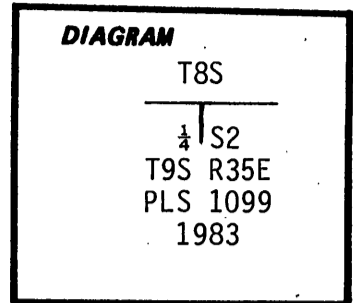

Description of corner evidence found:

None

Description of monument and accessories established to perpetuate the original location of this corner:

At Corner position determined by survey we set a 2½"x30" aluminum pipe and cap set 28" in the ground stamped:

From which: A Lodge Pole Pine 8" dia. bears S23½°E 42.2 ft. scribed ¼ S2 BT

A Western Larch 10" dia. bears S52°W 143.0 ft. scribed ¼ S2 BT

Attached brass washers stamped "LS 1099" to lower blaze of both BT's

Corner location perpetuated in accordance with Umatilla National Forest Survey Contract No. 53-04RS-2-01275

Staff Compass 20° East Declination  
Steel Tape

August 4, 1983

Witnesses: Glen Wagoner  
Mike Wagoner  
Kyle McKinney

Refer to Grant County Survey No. 828

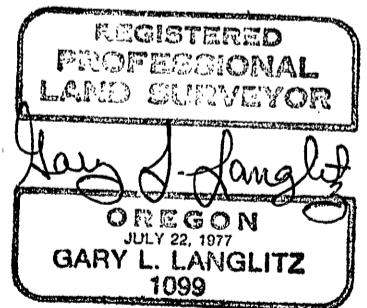
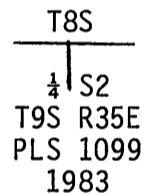

Office of SURVEYOR County of GRANT  
 State of OREGON, I hereby certify that the within instrument was filed in this office  
 for record on the 30 day of AUG, 1984  
Robert W. Langlitz by \_\_\_\_\_  
 (COUNTY OFFICIAL) (DEPUTY)