

CERTIFIED RECORD OF LAND CORNER MONUMENTATION

A-17

History of original corner establishment:

Original Survey by Herman D. Gradon, in 1884, under Glo Contract No. 499 Set Post 4 ft. long 4" sq. 24" in the ground for Corner to Section 2 & 3 from which:

- A Pine 9" dia. bears S29°E 12 lks. dist. marked T9S R35E S2 BT
- A Tamarack 5" dia. bears S62°W 28 lks. dist marked T9S R35E S3 BT

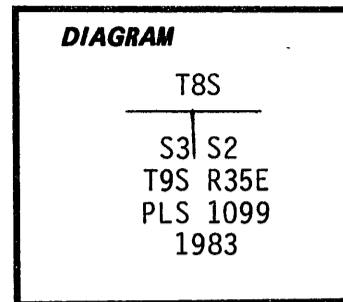

Description of corner evidence found:

None

Description of monument and accessories I established to perpetuate the original location of this corner:

At corner position determined by survey we set a 2½"x30" galvanized iron pipe with brass cap attached 24" in the ground stamped:
From which: A Spruce 14" dia. bears S35°W 36.4 ft. scribed T9S R35E S3 BT
 A Spruce 12" dia. bears S36°E 127.5 ft. scribed T9S R35E S2 BT

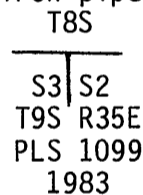

Attached brass washers stamped "LS 1099" to foot blaze of both BT's

Corner position located and perpetuated in accordance with Umatilla N.F. Survey Contract No. 53-04R3-2-01275

Staff Compass 20° East Declination
Steel Tape

August 3, 1983

Witnesses: Glen Wagoner
Mike Wagoner
Kyle McKinney

Refer to Grant County Survey No. 828

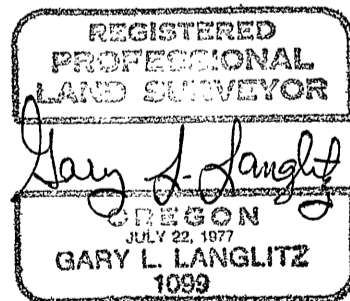

Office of.....SURVEYOR..... County of.....GRANT.....
 State of.....OREGON..... I hereby certify that the within instrument was filed in this office
 for record on the.....30 day of.....Aug....., 19.....84
Robert D. Baggett by
 (COUNTY OFFICIAL) (DEPUTY)