

CERTIFIED RECORD OF LAND CORNER MONUMENTATION

W.50-19.50

History of original corner establishment:

1983, Gary L. Langlitz, Registered Land Surveyor 1099, set a 2 1/2" X 30" galvanized iron pipe, with brass cap, 25" in ground with stone mound (Grant Co. Map of Survey No. 828), from which:

A White Fir 8" dia. bears N 46° W, 4.5 ft. marked SW NE 1/64 S35 BT.

A Tamarck 8" dia. bears S 37° W, 15.1 ft. marked SW NE 1/64 S35 BT.

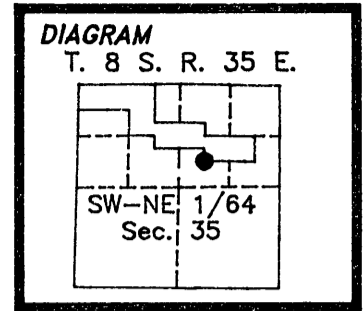

Description of corner evidence found:

Found a 2 1/2" brass cap set flush with the top of a stone mound, 2' in diameter by 8" high, marked as shown, from which:

11" Western Larch, S 38 3/4° W, 15.1 feet with healed double blaze.

12" White Fir, N 46° W, 4.5 feet with healed double blaze.

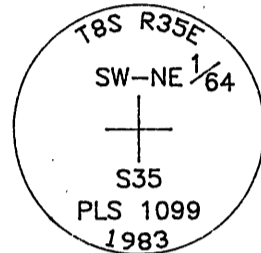

Description of monument and accessories I established to perpetuate the original location of this corner:

None

REGISTERED PROFESSIONAL LAND SURVEYOR

David A. Schlaich

OREGON
JULY 16, 1987
DAVID A. SCHLAICH
2308

RENEWAL DATE: 06/30/2000

Magnetic Declination 19° East
WORK PERFORMED BY: David A. Schlaich (RLS 2308)
DATE: October 19, 1999

Office of Grant Surveyor County of Grant
State of Oregon, I hereby certify that the within instrument was filed in this office
for record on the 9 day of Feb, 2000
Robert D. Baggett by David A. Schlaich
(COUNTY OFFICIAL) (DEPUTY)

Form R6-7100-57 (9/71)

SEE MAP OF SURVEY NO. 1543

W.50 - 19.50