

CERTIFIED RECORD OF LAND CORNER MONUMENTATION

History of original corner establishment:

None

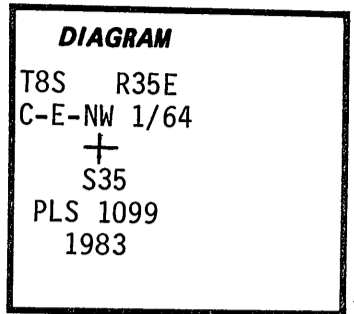

Description of corner evidence found:

None

Description of monument and accessories established to perpetuate the original location of this corner:

At the corner position, determined by survey set a 2 1/2"x30" galv. iron pipe with brass cap 26" in ground with raised mound.

From which:

- A Tamarack 8" dia. bears S 2°W, 38.6 ft. marked CENW 1/64 S35 BT.
- A Tamarack 8" dia. bears N 50°E, 22.3 ft. marked CENW 1/64 S35 BT.

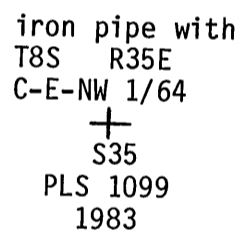

Attached brass washers stamped LS 1099 to BT blaze on both trees.

Corner location perpetuated in accordance with Umatilla N.F. survey contract no. 53-04R3-2-01275.

Post South w/54-2, 54-9
Post West w/54-2

20°E Declination Steel Tape

Corner falls in meadow 20'+ from fence corner south of Granite Creek.

September 21, 1983

Witnesses: A Ray Crapo
Greg Orton
Kyle McKinney

Refer to Grant County Survey No. 828

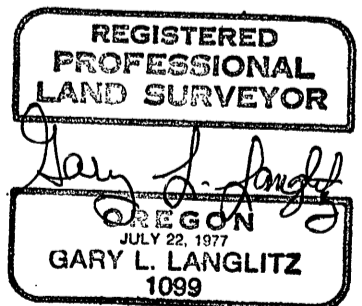

Office of.....SURVEYOR..... County of.....GRANT.....
 State of...OREGON... I hereby certify that the within instrument was filed in this office
 for record on the 30 day of APR, 1984
Robert D. Sayre by _____
 (COUNTY OFFICIAL) (DEPUTY)