

CERTIFIED RECORD OF LAND CORNER MONUMENTATION

History of original corner establishment:

Corner not previously established

NOTE

This monument marks the Wilderness Boundary within National Forest Lands, only.

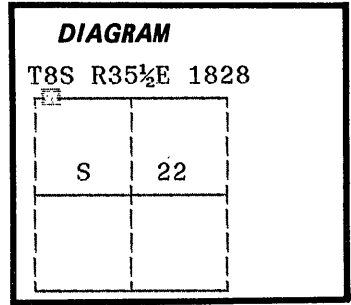

Description of corner evidence found:

Corner not previously established

Description of monument and accessories I established to perpetuate the original location of this corner:

At a point on the north line of section 22, at the head of Lucas Gulch, I set a 2 1/2" x 30" aluminum pipe with aluminum cap marked as shown, 22 inches in the ground, from which;

Bearing Trees;
A 10" Tamarack, bears N 53 E, 13.34 feet marked WB 1828 BT
A 9" Tamarack, bears S 49 E, 21.59 feet marked 1828 BT

Painted a 6 inch red band around all BTs and attached BT tags.
Set a steel fencepost approximately 5 feet West with signs attached.

I hereby certify that the above corner point was perpetuated as hereon described on July 31, 1990.

Witness: Jeff Petersen
Jim Bennett

USDA FOREST SERVICE
WILDERNESS BOUNDARY

NO 1828

1990

OPLS 644
UNLAWFUL TO DISTURB

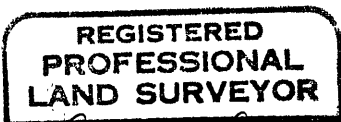

[Handwritten signature]

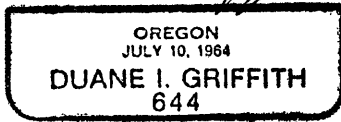

I used a steel tape and magnetic compass in the establishment of new accessories. I used 19° magnetic declination. The distances are to a 50d spike driven in the right side of the root crown. I attached a brass washer marked OPLS 644 to the BT blaze.

Office of *Surveyor* County of *Grant*
State of *Oregon*, I hereby certify that the within instrument was filed in this office
for record on the *27* day of *Sept*, 19*90*
Robert D. Baggett by _____
(COUNTY OFFICIAL) (DEPUTY)