

CERTIFIED RECORD OF LAND CORNER MONUMENTATION

History of original corner establishment:

Corner originally established by W. B. Barr under GLO contract number 492, dated August 22, 1883. Surveyor General record states: Set a sandstone 12" X 10" X 6" for the 1/4 cor. marked 1/4, on N face, from which;

A spruce 36 ins. diam bears S 45 W, 10 lks dist. marked 1/4 SBT.
A Pine 6 ins. diam. bears N 40 W, 20 lks dist. marked 1/4 SBT

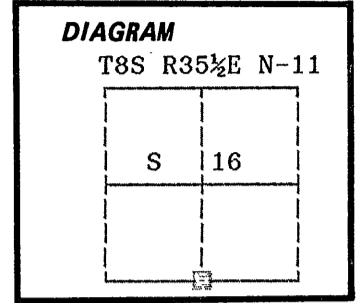

No record of subsequent monumentation found in Grant County survey records.

Description of corner evidence found:

Found Granite stone 11" X 8" X 6" marked 1/4 on the North face.
Found a 30" Spruce S 30° W, 10.5 ft. Blaze evident, did not open.
There is a small creek, flowing South, 5 ft West.

Description of monument and accessories I established to perpetuate the

original location of this corner: In place of stone, I set a 2 1/2" X 30" aluminum pipe with aluminum cap marked as shown, 30" in the ground, from which;

New Bearing Trees

A 13" White Fir bears N 11° E, 22.10 ft. marked 1/4 S 16 BT.
A 9" Spruce bears S 57° E, 34.45 ft. marked 1/4 S 21 BT.
A 19" White fir bears N 63° W, 26.35 ft. marked X BT.

Set a steel fencepost approximately 5 feet East, with signs attached.

I hereby certify that the above corner point was perpetuated as hereon described on July 27, 1990.

Witness: Jeff Petersen
Jim Bennett

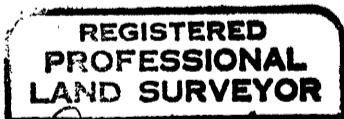
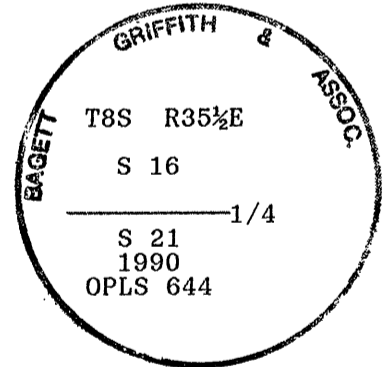

Handwritten signature of Duane I. Griffith

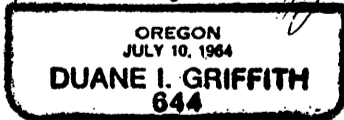

I used a steel tape and magnetic compass in the establishment of new accessories. I used 19° East magnetic declination and the distances are to a 50d spike driven in the right side of the root crown. I attached a brass washer marked OPLS 644 to the BT blaze.

Office of... *Surveyor* ... County of... *Grant* ...
State of... *Oregon* ... I hereby certify that the within instrument was filed in this office
for record on the... *27* ... day of... *Sept* ... 19... *90* ...
... *Robert D. Baggett* ... by ...
(COUNTY OFFICIAL) (DEPUTY)