

CERTIFIED RECORD OF LAND CORNER MONUMENTATION

History of original corner establishment:

Corner not previously established

NOTE

This monument marks the Wilderness Boundary within the National Forest Lands, only.

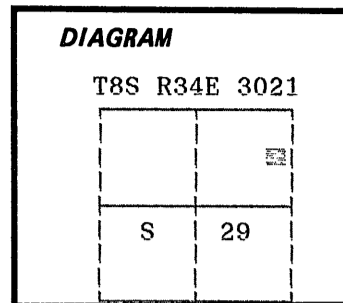

Description of corner evidence found:

Corner not previously established

Description of monument and accessories I established to perpetuate the original location of this corner:

At a point on the 6480 foot contour line, in the area of the section line between S-28 & S-29, I set a 2½" x 30" aluminum pipe with aluminum cap marked as shown, 29 inches in the ground, from which;

Bearing Trees;

A 8" Lodgepole Pine, bears N 32 W, 12.73 feet marked WB 3021 BT
A 9" White Fir, bears S 25 E, 14.55 feet marked WB 3021 BT.

Painted a 6 inch red band around all BTs and attached BT tags.

Set a steel fencepost approximately 5 feet West with signs attached.

I hereby certify that the above corner point was established as hereon described on August 1, 1990.

USDA FOREST SERVICE
WILDERNESS BOUNDARY

NO 3021

EL 6480
OPLS 644 1990

UNLAWFUL TO DISTURB

Witness: Jeff Petersen
Jim Bennett
Larry Pitcher

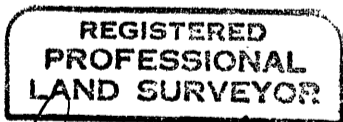

Duane I. Griffith

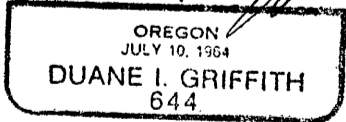

I used a steel tape and magnetic compass in the establishment of new accessories. I used 19° magnetic declination. The distances are to a 50d spike driven in the right side of the root crown. I attached a brass washer marked OPLS 644 to the BT blaze.

Office of... *Sumner* ... County of... *Grant* ...

State of... *Oregon* ... I hereby certify that the within instrument was filed in this office

for record on the... *27* ... day of... *Sept* ... , 19... *90* ...

... *Robert D. Bagan* ... by ...
(COUNTY OFFICIAL) (DEPUTY)