

# CORNER RESTORATION

**CORNER:** W1/4 Cor. Sec. 8 Twp. 8 S. Range 30 E., W.M.

**ORIGINAL SURVEY BY:** F. W. Campbell

**SURVEY NUMBER:** 380

**CONTRACT DATE:** March 19, 1881

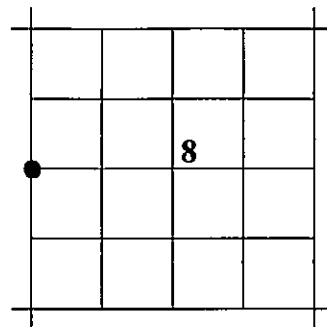

**Subsequently remonumented:** October 1969 by Duane Griffith, Grant County Surveyor

**Revisited:** January 21, 1992 by Robert Bagett, Grant County Surveyor

**ORIGINAL G.L.O. DESCRIPTION:** Set Stone 13x13x11 for 1/4 corner, from which: A pine 13" diam. bears S35°E., 8 lks. dist.; A pine 6" diam. bears S.57°W. 46 lks. dist.

**Griffith's 1969 description:** Set by single proportion. Set spike in bed rock, with iron post in mound of stone directly over point. New BTs: A 14" juniper bears N28°W, 105.0 ft. mkd. 1/4 S7 BT; A 10" juniper bears N41°E. 125.1 ft, mkd. 1/4 S8 BT. (SEE RECORD SURVEY NO. 154)

**Bagett's 1992 description:** Found a 1 1/2"x30" galv. iron pipe with attached Grant Count Surveyor brass cap set in a mound of stone, but leaning badly, I remove it and find spike set in bedrock beneath iron pipe. From which: A juniper 17" diam. bears N45°13'E, 123.9 ft. with scribing visible; A juniper 21" diam. bears N26°00'W, 104.7 ft. with scribing visible. (Bagett reset the iron pipe over the nail). . .From which A juniper 13" diam. bears N.1°E., 143.7 ft. mkd. 1/4 S7 CSBT; a juniper 9" diam. bears S7°E, 112.1 ft. mkd. X CSBT; a 5/8" iron pin with attached alum. cap bears S.39°24'W., 118.1 ft. marked "BGA SURVEY MARKER 6+32.5 30 FT".

**EVIDENCE FOUND:** We Found the monument in place and in good condition. All the bearing trees are alive and healthy. The iron pin at station 6+32.5 was also recovered and is in good condition.

**DESCRIPTION OF MONUMENTS AND ACCESSORIES SET AND METHODS USED:**

We rebuilt the mound of stone 5 ft. base to top of cap and Placed a fiberglass location post alongside the mound of stone.

**FROM THE CORNER POINT I SET A NEW REFERENCE POINT:**

A 5/8"x30" iron pin bears N.13°35'E., 181.79 ft. with attached aluminum cap marked GRANT COUNTY SURVEYOR RP1 2011.

**ALSO FROM THE CORNER POINT:**

A 5/8"x30" iron pin bears S.28°57'W., 179.83 ft. with attached aluminum cap marked "BGA SURVEY MARKER 7+00.0 30 FT." Pin is on the east side of the county road and is from survey no. 1194.

**STATE PLANE COORDINATES (3601 OR N)**

Reference Datum: NAD83 From OPUS Solution

Northing: 448,204.3 ft.  
Easting: 8,553,203.6 ft  
Ellip. Ht: 2,550.5 ft

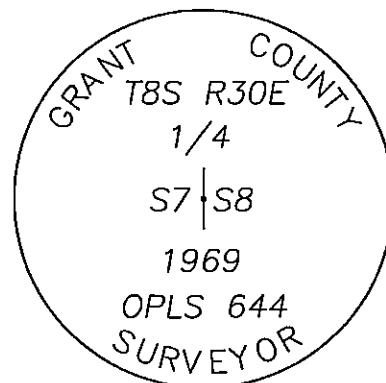

**RESTORATION BY, STAMP AND DATE:**

Michael C. Springer, Grant County Surveyor  
Jason L. Hatfield, Deputy County Surveyor

**RECEIVED AND FILED  
GRANT COUNTY SURVEYOR**

Surveyed November 2, 2011

NOV 4, 2011

BY 



EXPIRES: 6/30/2012