

# CORNER RESTORATION

NE cor.  
**CORNER** Sec. 3 TWP 8 S RANGE 30 E

**ORIGINAL SURVEY BY:** Frank Campbell

**CONTRACT NUMBER:** 380

**CONTRACT DATE:** March 19, '1881

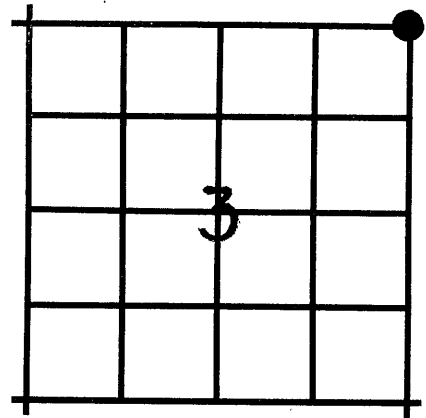

**ORIGINAL DESCRIPTION:**

Set a basalt stone 15x15x6 in mound of stone for corner to Secs. 2, 3, 34 and 35

**RECEIVED AND FILED**

**DEC 19 1986**

OFFICE OF COUNTY SURVEYOR  
*Robert D. Baggett*  
 Attest: *J. L. Watson*

**RESTORATION BY, STAMP AND DATE:**

R. D. Baggett  
 J. L. Watson

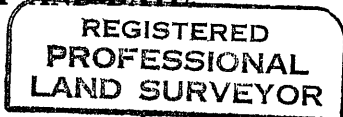

*Robert D. Baggett*

Dec. 5, 1986

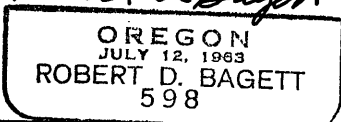

Grant County Surveyor

**EVIDENCE FOUND:**

Found original corner monument, a basalt stone 15x14x6 inches, marked with 4 notches on the East edge.

**DESCRIPTION OF MONUMENTS AND ACCESSORIES SET AND METHODS USED:**

Show how trees are scribed and basis of bearings, including compass var.

At the position of the original corner stone, I stardrilled a 3/4" hole 3" deep into bedrock and set a 3/4"x3" brass stem with a 3" brass disc attached into the hole. I then grouted the stem to bedrock and marked disc as shown.

From which I scribe NEW BT'S:

- A 14 inch Juniper bears N. 50° E., 110.5 ft., marked T7S R30E S35 CSBT
- A 17 inch Juniper bears S. 56° E., 66.9 ft., marked T8S R30E S2 CSBT
- A 25 inch Juniper bears S. 55° W., 97.6 feet, marked T8S R30E S3 CSBT.
- A 4 inch Juniper bears N. 34° W., 21.3 feet, marked X CSBT.

**MONUMENT MARKED**

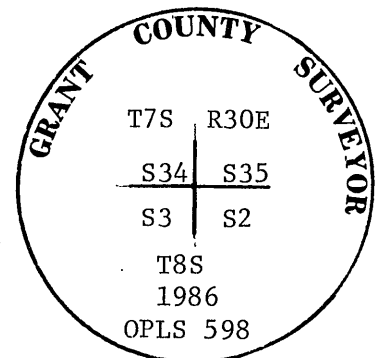

I placed the original corner stone in a mound of stone 4 ft. base, 3 ft. high and 3 ft. East of Section corner.

I attached Grant County Surveyor BT tags and painted 6 inch red band around BTs and on blazes with red tree marking paint. Used magnetic compass with 20° E. var. and steel tape measuring to a 50d nail driven in the side center at the root crown of BT's. Nailed brass washer marked "OPLS 598" to lower blaze. A fence corner running North and West bears N. 22° E., 20 ft.