

# CORNER RESTORATION

**CORNER:** Angle Point

**Sec 34 TWP. 8S. RANGE 28E.**

**ORIGINAL SURVEY BY:** Aaron F. York

**CONTRACT NUMBER:** 309

**CONTRACT DATE:** November 18, 1878

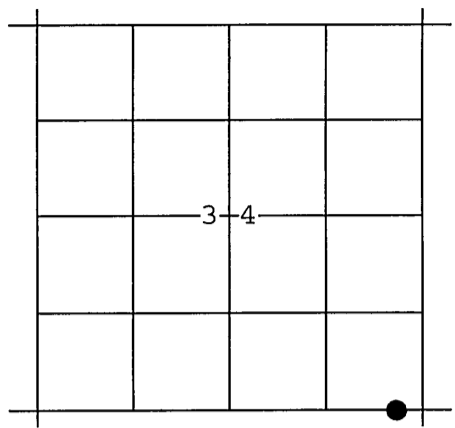

Subsequent retracement by Henry Meldrum, Contract No. 380, dated March 19, 1881 resulted in this corner becoming an angle point on the township line.

**ORIGINAL DESCRIPTION:** Set stone 15x12x3 for Standard Cor. to Sec's. 2, 3, 34 and 35. Raised stone mound at cor.  
**NOTE:** Henry Meldrum found the south boundary of T. 8S., R. 28E. very irregular and established new standard corners to subdivide T. 8S., R. 28E. from. However, he did not change the alignment of the standard parallel.

**RESTORATION BY, STAMP AND DATE:**

R.D. Bagett  
 S.D. Follweiler  
 M.C. Springer

RECEIVED AND  
 FILED

*June 11, 1999*  
 OFFICE OF COUNTY SURVEYOR

*Robert D. Bagett*  
 ATTEST: *M.C.S.*

REGISTERED  
 PROFESSIONAL  
 LAND SURVEYOR

*Robert D. Bagett*  
 OREGON  
 JULY 12, 1963  
 ROBERT D. BAGETT  
 598  
 RENEWAL DATE 12/31/99

May 5, 1999

Grant County Surveyor

**EVIDENCE FOUND:** Found original corner stone broken in a mound of stone. Of the pieces found, one piece is marked 8/28, the other marked SC. I accept the marked stone and center of the mound of stones for the position of this corner. Centerline of an intermittent creek is 24 ft. east. Top of bank is 5 ft. east.

**DESCRIPTION OF MONUMENTS AND ACCESSORIES SET AND METHODS USED:**

Show how trees are scribed and basis of bearings, including compass var.

At the corner point: I set a 1½"x30" galv. iron pipe, 26" in the ground, with attached Grant County Surveyor brass cap marked as shown.

From which I SCRIBE NEW BEARING TREES:

A Juniper 13" diam., bears N47°E, 78.6 ft. marked AP S34 CSBT.

A Juniper 11" diam., bears N32°W, 44.6 ft. marked AP S34 CSBT.

Also: I SET NEW REFERENCE POINTS:

Two 5/8"x30" iron pins, bear S55°W, 50.00 ft. and 100.00 ft., with attached alum. caps marked GRANT COUNTY SURVEYOR RP 1 and RP 2 1999 OPLS 598, respectively.

Two 5/8"x30" iron pins, bear N35°W, 50.00 ft. and 100.00 ft., with attached alum. caps marked GRANT COUNTY SURVEYOR RP 3 and RP 4 1999 OPLS 598, respectively.

**MONUMENT MARKED**

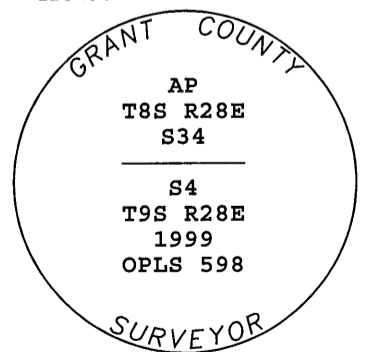

Buried marked pieces west and alongside iron pipe, raised a mound of stone 3 ft. base to top of cap. Used true bearings and an electronic measuring device, measuring to a 50d nail driven in the sidecenter at the root crown of the BT's. Attached BT tags to BT's.