

# CORNER RESTORATION

NE cor.  
**CORNER** Sec. 33 TWP 8 S RANGE 28 E

**ORIGINAL SURVEY BY:** Henry Meldrum

**CONTRACT NUMBER:** 380

**CONTRACT DATE:** March 19, 1881

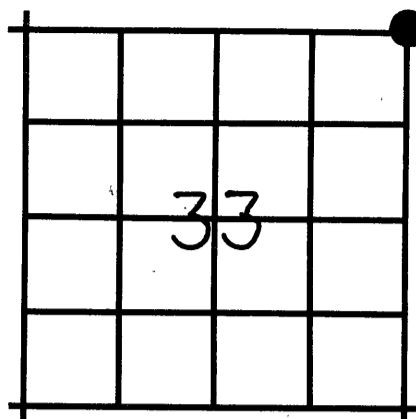

**ORIGINAL DESCRIPTION:** Set a basalt stone 14x8x6 and dug pits for cor. to Secs. 27, 28, 33 and 35, from which a Juniper 20 ins. diam., bears N. 8° W., 107 lks. dist.

**RESTORATION BY, STAMP AND DATE:**

R. D. Bagett  
 J. L. Watson  
 J. L. Meyerholz

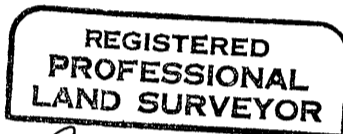

*Robert D. Bagett*

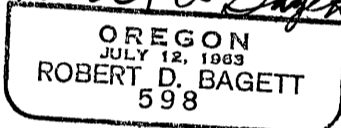

June 23, 1984

Grant County Surveyor

**EVIDENCE FOUND:** Found original basalt corner stone 15x10x5 inches marked with 3 dim grooves on one side and one dim groove on adjacent side, lying in a mound of stone.  
 from which the original BT:  
 A Juniper stump 40" diam., 60" high, bears N. 8° W., 70.6 ft., mkd.  
 BT, measuring to center of stump.

**RECEIVED AND FILED**

JUN 27 1984

OFFICE OF COUNTY SURVEYOR  
*Robert D. Bagett*  
 Attest: *Annice L. Linn*

**DESCRIPTION OF MONUMENTS AND ACCESSORIES SET AND METHODS USED:**

Show how trees are scribed and basis of bearings, including compass var.

At the corner point: Set a 1½"x30" galvanized iron pipe 12" in the ground with brass cap marked as shown. from which I scribe NEW BEARING TREES:

- A Juniper 3 inches diam., bears S. 65° W., 11.5 ft., mkd. X CSBT.
- A Juniper 26 inches diam., bears N. 42° W., 337.9 ft., mkd. T8SR28E S28 CSBT.

No other suitable trees available in NE or SE quadrants within reasonable distance.

Buried corner stone West and alongside iron pipe and raised a mound of stone, 4' ft. base to top of cap. Used magnetic compass with 20° E. variation and steel tape, measuring to head of a 40d nail driven flush with the BT blaze of BTs.

**MONUMENT MARKED**

