

CORNER RESTORATION

CORNER ^{NE cor.} Sec. 32 TWP 8 S RANGE 28 E

ORIGINAL SURVEY BY: Henry Meldrum
 CONTRACT NUMBER: 380
 CONTRACT DATE: March 19, 1881

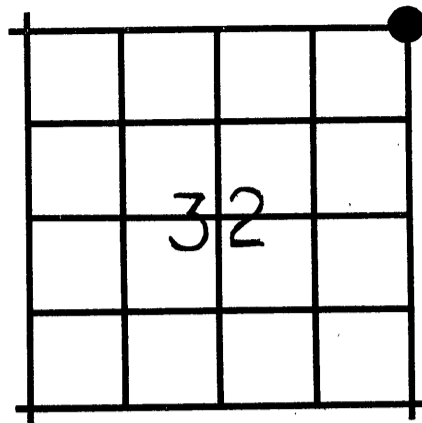

ORIGINAL DESCRIPTION: Set a basalt stone 14x8x5 and dug pits for cor to Secs. 28, 29, 32 and 33

RECEIVED AND FILED

APR 10 1986

OFFICE OF COUNTY SURVEYOR

Robert D. Baggett
 Attest: _____

RESTORATION BY, STAMP AND DATE:

R. D. Baggett
 J. L. Watson

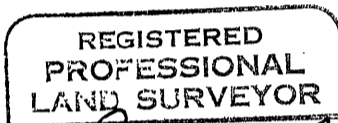

Robert D. Baggett

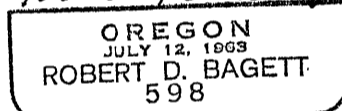

March 11, 1986

Grant County Surveyor

EVIDENCE FOUND: Found original basalt corner stone 15x8x5 inches marked with four notches on east edge set 12 inches beneath surface of ground beneath a 4x4 ft. rock crib at the corner of fences running SE and SW.

I accept the position of this stone for the section corner as it is harmoniously related to other known corners in the area. The topography calls to the creek given in the GLO notes fit this position.

DESCRIPTION OF MONUMENTS AND ACCESSORIES SET AND METHODS USED:

Show how trees are scribed and basis of bearings, including compass var.

- I removed the corner stone and in its place set a 1½"x30" galvanized iron pipe 32 inches in the ground with brass cap marked as shown: from which I scribe NEW BEARING TREES:
- A juniper 18 ins. diam. bears N. 39½° E., 472.6 ft. mkd. T8SR28E S28 CSBT.
- A juniper 12 ins. diam. bears S. 83° E., 174.1 ft. mkd. T3SR28E S33 CSBT.
- The NE trunk of a juniper 14 ins. diam. bears S. 34° W., 156.2 ft. mkd. T8SR28E S32 CSBT.
- A juniper 20 ins. diam. bears N. 38½° W., 257.2 ft., mkd. T8SR28E S29 CSBT.

MONUMENT MARKED

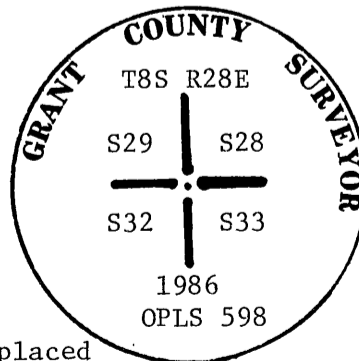

Buried corner stone South and alongside iron pipe and replaced stone in rock crib 2½ ft. over monument. Used true bearings (solar obs.) and electronic distance measuring device measuring distance to head of 40d nail driven in side center of BTs. Attached Grant County Surveyor BT tags to BTs.