

CERTIFIED RECORD OF LAND CORNER MONUMENTATION

History of original corner establishment:

Original corner established by: Aaron York , Deputy Surveyor, under Contract No. 309, dated Nov.18, 1878.

Surveyor General Record States: Set stone 16x10x6 for corner to sections 25, 36, 30 & 31.

Re-Survey by: Henry Meldrum, Deputy Surveyor, under Contract No. 380, dated March 19, 1881.

Surveyor General Record States: Point 44 lks east of corner to sections 30 & 31.

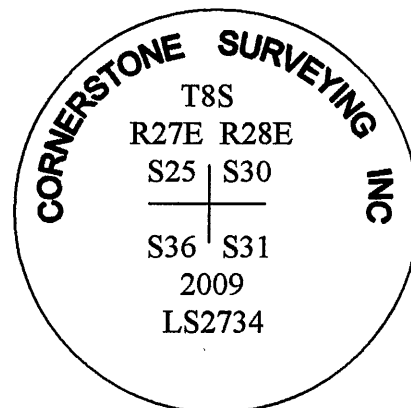

Proportioned by Jack Watson, OPLS #2734, Survey No. 1663, dated April 15, 2003, set 2½"x30" aluminum pipe with

aluminum cap, surrounded by a mound of stones, from which:

A 18" juniper bears N9°E, 65.3 ft. marked T8SR28ES30BT.

A 6" juniper bears S73°W, 63.2 ft. marked XBT.

A 10" juniper bears N37°W, 36.1 ft. marked T8SR27ES25BT.

A 5/8"x24" iron pin bears S62°E, 10.72 feet, with attached red plastic cap marked CORNERSTONE SURVEYING INC.

Description of corner evidence found:

Found 2½"x30" aluminum pipe and accessories as described by Jack Watson.

RECEIVED AND FILED
February 3, 2009
 DEPUTY SURVEYOR
 Attest: *[Signature]*

REGISTERED PROFESSIONAL LAND SURVEYOR
[Signature]
OREGON
 SEPT 19, 1995
JACK L. WATSON
 2734

Renewal Date 6/30/2010

Description of monument and accessories set at corner location:

At the point determined by survey, I set a 2½"x30" aluminum pipe with attached 3" aluminum cap, 26 inches in the ground, surrounded by a mound of stone. The cap is stamped as shown in the diagram.

From which:

A 18" juniper bears N2°E, 58.1 ft. marked T8SR28ES30BT.

A 6" juniper bears S71°W, 72.6 ft. marked XBT.

A 10" juniper bears N53°W, 36.9 ft. marked T8SR27ES25BT.

A 5/8"x24" iron pin bears S6°E, 12.1 feet, with attached red plastic cap marked CORNERSTONE SURVEYING INC.

The aluminum monument set in 2003 bears S46°W, 10.09 feet.

I used a steel tape measuring to a 50d nail driven in the side center at the root crown of the BT's and magnetic compass, with 18° E. declination. See Grant County Survey No. 1857.

Date: January 13, 2009

Office of County of
 State of , I hereby certify that the within instrument was filed in this office for record on the day of , 2009.
 by
 (COUNTY OFFICIAL) (DEPUTY)