

CERTIFIED RECORD OF LAND CORNER MONUMENTATION

H.50-15

History of original corner establishment:

NONE

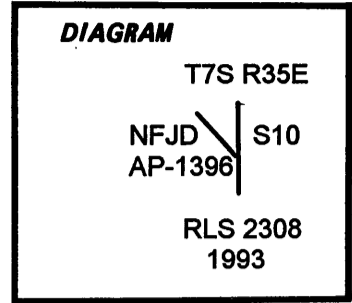

Description of corner evidence found:

NONE

Description of monument and accessories I established to perpetuate the original location of this corner:

At the intersection point, of a line 100 foot southerly of and perpendicular to the centerline of F.S. Trail No. 3021, with the North - South centerline of section 10, T. 7 S., R. 35 E., I set a 2 1/2" by 28" aluminum pipe, with 3 1/4" aluminum cap, 6" in the ground and flush with a rock mound 18" high, from which:

44" Western Larch bears, N. 6° E., 35.3 feet, marked "WB/1396""BT".  
10" Douglas Fir bears, N. 89° W., 27.8 feet, marked "WB/1396""BT".

BT's are double blazed and have a brass washer marked "RLS 2308" nailed to the lower blaze by the "BT" scribing.

Magnetic Declination 20° East.

Work performed by: David A. Schlaich (RLS 2308)  
Witnessed by: Ira McCauley and Troy Allen  
Date: October 1993

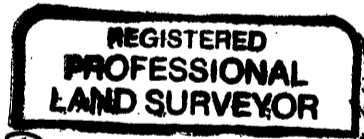

*David A. Schlaich*

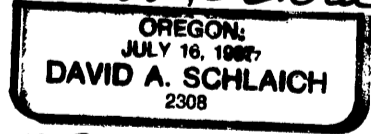

*Expires 12/31/94*

Office of Surveyor County of Grant  
 State of OR, I hereby certify that the within instrument was filed in this office  
 for record on the 2 day of Feb, 1994  
Robert D. Hayes by \_\_\_\_\_  
 (COUNTY OFFICIAL) (DEPUTY)