

CERTIFIED RECORD OF LAND CORNER MONUMENTATION

History of original corner establishment:	Index: J-13
Corner, Secs. 9, 10, 15 and 16, T.7S., R.32E., W.M.	
Township originally subdivided by Rufus Moore under	1 DIAGRAM 1
Contract No. 382 dated March 23, 1881.	1 BLM brass cap 1
A retracement survey was made by	1
the BLM under assignment instructions dated 1967.	1 T7SR32E 1
Their record reads:	1 S9 1S10 1
A pine snag, 36 ins. diam., bears S.42 1/2°E., 96 lks.	1 ----- 1
dist., with scribe marks S15 visible on opened blaze.	1 S16 1S15 1
At the corner point	1 1968 1
Set an iron post, 28 ins. long, 2 1/2 ins. diam.,	1
24 ins. in the ground, in a mound of stone, 3 1/2 ft.	1
base, to top, with brass cap mkd. (diagram).	1
from which new bearing trees	
A pine, 8 ins. diam., bears N. 47°E., 64 lks. dist., mkd. T7SR32ES10BT.	
A fir, 10 ins. diam., bears S.63 1/2°W., 79 lks. dist., mkd. T7SR32ES10BT.	
A fir, 10 ins. diam., bears N. 43°W., 45 1/2 lks. dist., mkd. T7SR32ES9BT.	

Description of corner evidence found:

Found the corner monument as described from which:
 A 13" dbh Ponderosa Pine bears N.47°E., 42.2' with visible scribe.
 A 12" dbh Douglas Fir bears N.43 1/2°W., 30.0' with visible scribe.
 A 15" dbh Douglas Fir bears S.63 1/2°W., 52.1' with healed blaze.
 A dead and down Ponderosa Pine bears S.42 1/2°E., 63.4' with visible scribe.

Description of monument and accessories I established to perpetuate the original location of this corner:

Set new bearing trees as follows:
 A 15" dbh Ponderosa Pine bears S.86 3/4°E., 81.1' scribed T7SR32ES15BT.
 The bearings were based on the record bearings to the existing BT's.
 An aluminum washer stamped RLS 852 is nailed between the letters B and T on the new tree. All the BT's have LSM and BT signs attached.
 Painted 6" red bands around all the trees and painted the scribe blazes red.

This work was done September 22, 1993.

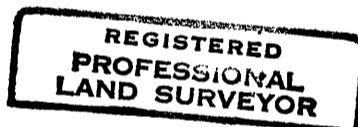

David L. Haddock

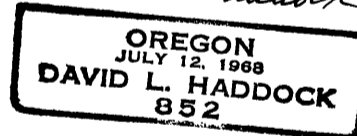

Office of Surveyor County of Grant
 State of Oregon, I hereby certify that the within instrument was filed
 in this office for record on the 16 day of March, 1994.
Robert D. Bayett by _____
 (COUNTY OFFICIAL) (DEPUTY)