

CERTIFIED RECORD OF LAND CORNER MONUMENTATION

History of original corner establishment:

Original survey by Meldrum and Campbell, Contract No. 380, 1881.

Set a basalt stone 18x9x7 in a mound of stone for cor. to secs. 4, 5, 32, 33, N89°39' E on true line on N. Bdy. Sec. 4, 0.50 chs. descend hill, bears N and S.

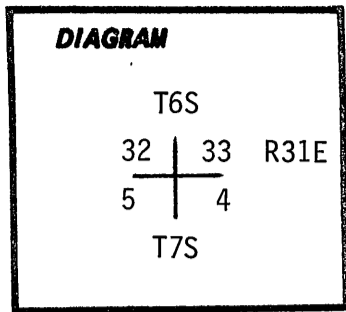

Description of corner evidence found:

The original corner stone was not found. Roadbuilding, logging, and fencing (using rock jacks) has caused considerable disturbance in the area.

Description of monument and accessories I established to perpetuate the original location of this corner:

Corner position determined by survey along a true parallel of latitude between the N 1/4 corner of Sec. 4 and the NW cor. of Sec. 5, T7S, R31E and at record distance of 0.50 chs. (33 feet) west of the beginning of the descent to the east.

At the corner position, we set a 2"x30" Galvanized Iron Pipe 14" in the ground to bedrock and supported in a mound of stone 6' dia. base to top of pipe, with brass cap attached, marked:

From which we mark the following bearing trees:

A 20" Ponderosa Pine, scribed "T6S R31E S32 BT" on a double blaze bears N79°W 257.9 ft.,

A 11" Douglas Fir, scribed "T6S R31E S33 BT" on a double blaze bears N61 1/2°E 88.1 ft.,

A 14" Ponderosa Pine scribed "T7S R31E S4 BT" on a double blaze bears S7°E 104.6 ft.,

And a 16" Ponderosa Pine, scribed "T7S R31E S5 BT" on a double blaze bears S13°W 268.4 ft.

Attached brass washer, marked "LS 1099" to lower blaze of new BT's. Corner established and perpetuated in accordance with our survey contract.

Magnetic Compass (Declination 18 1/2° East)
Steel Tape

August 25, 1982

Witnesses: Gary Langlitz
Greg Orton
Jeff Anderson

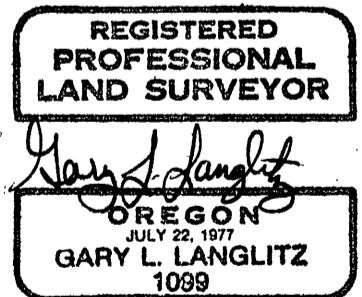
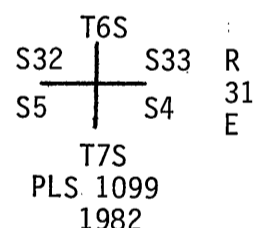

Office of Surveyors County of Grant
 State of Oregon, I hereby certify that the within instrument was filed in this office
 for record on the 25 day of Jan, 1983
Robert D. Baggett by _____
 (COUNTY OFFICIAL) (DEPUTY)