

CORNER RESTORATION

CORNER: NW Cor. Sec. 25 Twp. 7 S. Range 29 E., W.M.

ORIGINAL SURVEY BY: F. W. Campbell

SURVEY NUMBER: 380

CONTRACT DATE: March 19, 1881

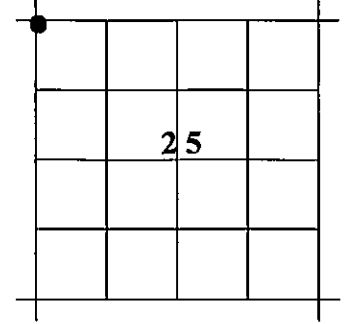

Subsequently remonumented: March 8, 1971 by Douglas Ferguson, PLS

ORIGINAL G.L.O. DESCRIPTION: Set basalt Stone 16x9x6 in a mound of stone for corner to sections 23, 24, 25 & 26 from which a pine 24" dia. bears N59°W. 42 lks. dist.

Ferguson's 1971 description: Found original corner stone broken with 2 notches visible, in a mound of stone from which a 24" pine, which is dead and down bears N59°W, 27 ft. dist., with old blaze and axe marks., scribing is burned out. Set a 1½"x36" galv. iron pipe with attached brass cap as shown, 6" in the ground, placed original stone north & alongside, deposited broken glass under base. . .from which a 8" dia. bull pine bears N32°E, 72.3 ft. marked T7S R29E S24 BT. A 9" bull pine bears S33°E, 27.1 ft. dist marked T7S R29E S25 BT. a 6" bull pine bears S24°W, 35.0 ft. dist. marked X BT. a 7" bull pine bears N71°W, 74.1 ft. dist. marked T7S R29E S23 BT. . .

EVIDENCE FOUND: We Found the monument protruding approximately 20" out of the stone mound and leaning. We found the bearing trees to the Northeast and Southwest healthy with healed blazes. The bearing tree to the Southeast is dead and standing. The bearing tree to the Northwest is dead and down. Upon removing the monument in order to reset it, we found the broken glass at the base. We also found the remains of the original BT that Mr. Ferguson found in 1971.

DESCRIPTION OF MONUMENTS AND ACCESSORIES SET AND METHODS USED:

We referenced the iron pipe, removed it and cut approximately 16" off the bottom of it. We replaced the pipe and rebuilt the mound of stone 5 f.t base to top of cap.

FROM THE CORNER POINT I SET A NEW REFERENCE POINT:
A 5/8"x30" iron pin bears S.74°06'E., 46.98 ft. with attached aluminum cap marked GRANT COUNTY SURVEYOR RP1 2011.

ALSO FROM THE CORNER POINT, I SCRIBE A NEW BEARING TREE:
A juniper, 11½" diam., bears N.30°03'W., 33.70 ft., marked T7S R29E S23 CSBT. Distance is measured to a 50d nail driven into the side center at the root crown of the BT. Attached BT tag to the tree.

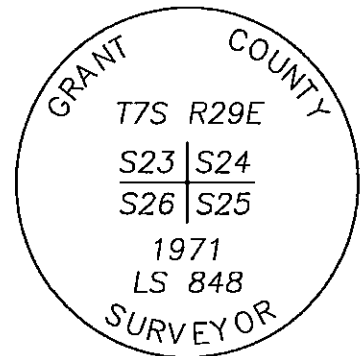

STATE PLANE COORDINATES (3601 OR N)
Reference Datum: NAD83 From OPUS Solution

Northing: 466,473.1 ft.
Easting: 8,542,893.8 ft
Ellip. Ht: 3,358.9 ft

RESTORATION BY, STAMP AND DATE:

Michael C. Springer, Grant County Surveyor
Jason L. Hatfield, Deputy County Surveyor

**RECEIVED AND FILED
GRANT COUNTY SURVEYOR**

Surveyed November 2, 2011

NOV 4, 2011

BY

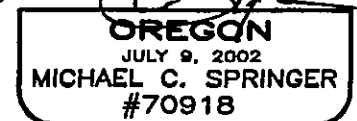

EXPIRES: 6/30/2012