

CERTIFIED RECORD OF LAND CORNER MONUMENTATION

INDEX No. R-1

History of original corner establishment:

This corner was originally established by Henry W. Cooke, in 1883, under GLO Contract Number 488. Surveyor General Field Notes state:

DIAGRAM

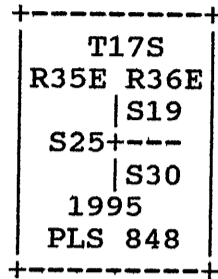

Set a basalt stone 16x12x5 ins 12 ins in ground for cor to secs 19& 30 marked with 2 notches on S and 4 notches on N, and 6 notches on E edges from which: A pine 30 ins dia bears N63°E 119 lks dist marked T17S R36E S19 BT. A pine 36 ins dia. bears S81°E 112 lks dist marked T17S R36E S30 BT and raised a mound of stone alongside of cor.

Description of Corner Evidence Found:

Original corner stone not found.

Found a portion of a Pine tree with 2 crescent shaped scribe marks, on a portion of a blaze face, the rest of the scribing is burnt off. This scribing came from the southeast bearing tree, which is a broken off snag, standing up slope, "west" from the remains with the scribing. Found a root hole for the northeast Bearing Tree. Both trees fit well for bearing, and when slope chained they fit exactly. Set the monument S61°W, 73.8' from the roothole and N79°W, 69.5' from the snag.

Description of monument and accessories I established to perpetuate the original location of this corner:

Set 2-1/2"x30" aluminum pipe with 2-1/2" aluminum cap, stamped as shown in DIAGRAM, 14" in the ground, and raised a mound of stone around pipe.

From which:

A Ponderosa Pine 12" dia. bears N10°W, 75.1 ft., scribed: T17S R35E S25 CC BT.

A Ponderosa Pine 10" dia. bears N17°E, 50.1 ft., scribed: T17S R36E S19 CC BT.

A Ponderosa Pine 14" dia. bears S79°E, 76.5 ft., scribed: T17S R36E S30 CC BT.

A Ponderosa Pine 26" dia. bears S70°W, 67.8 ft., scribed: T17S R35E S25 CC BT.

Measurements to accessories taken with a magnetic compass, declination 17° east, and a nylon clad steel tape. Set steel fence post with Land Survey Monument sign 1' north. Nailed a brass washer stamped PLS 848 on blaze above BT scribe as taken this survey. Nailed Bearing Tree signs above blaze and Land Survey Monument signs on back of each tree as required. Painted a 6" red band above Bearing Tree signs and painted blaze red.

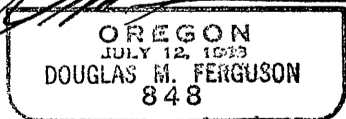
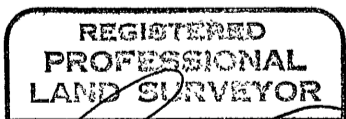

This work was performed by:
 Douglas M. Ferguson, PLS 848
 Witnessed by: D. Mitchell Ferguson
 and Brad Cates
 Date: 11- 1-95
 Refer to Grant County Map of
 Survey No. 1462

Renewal date:
 12/31/98

Office of Surveyor County of Grant
 State of OR I hereby certify that the within instrument was
 filed in this office for record on the 2 day of Feb, 1998
Robert D. Sargent by _____
 (COUNTY OFFICIAL) (DEPUTY)