

Twp 13S R29E

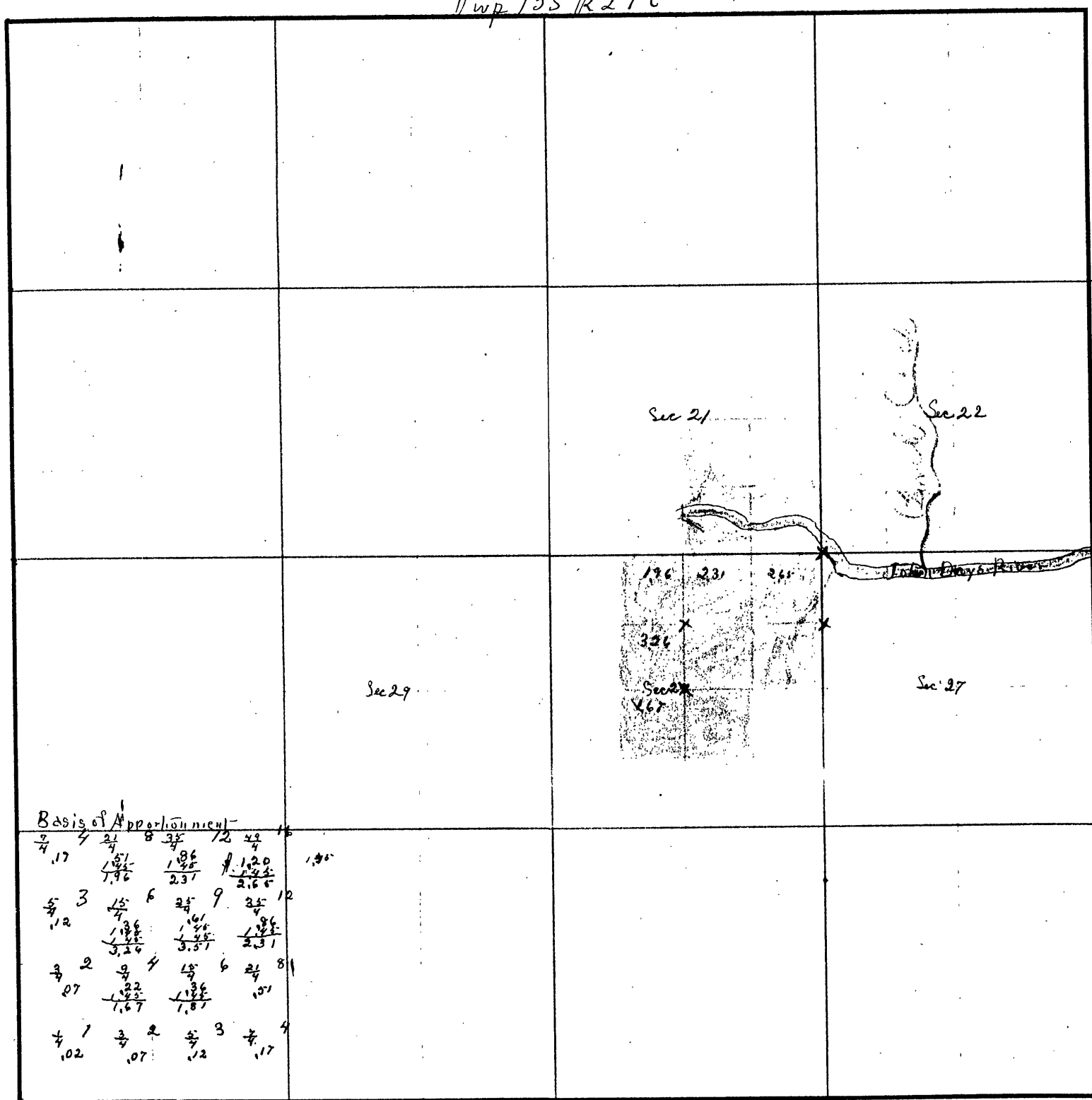

Basis of Apportionment

7/4	5/4	3/4	1/4	1/4
.17	.125	.075	.025	.025
5/3	3/4	1/4	1/4	1/4
.12	.075	.025	.025	.025
3/2	1/2	1/4	1/4	1/4
.07	.025	.025	.025	.025
1/4	1/4	1/4	1/4	1/4
.02	.02	.02	.02	.02

The numbers at each corner show proportion of distance each corner is affected.

Red Crosses show corners established

add together the numbers at each corner of each 40 by 170 acre and divide by 49 gives exact prop. frac. of costs of establishment of NE cor - Sec 28  
 adding numerals we have 246 divide costs of each section by this numeral we have  $\frac{680}{246} = 2.764$  multiplying by each numeral we have costs to each 40 acres established of NE corner Sec 28  
 numeral is the number at N and NE cor of each separate  
 The remainder of survey consists of getting 3 corners apportioned thus  $\frac{1640}{3} = 546.66$  cost to each corner = \$546  
 and 546 = costs. each adjoining 40 acres

Sec 28  
 NE corner Sec 28  
 Twp 13S R29E